

REV	DATE	BY	CHKD	APP'D
AD 00				
REVISED PER ECO-11-004807				
11MART1 RK HMR				

SPECIFICATIONS  
MAKE-BEFORE-BREAK

MATERIALS:  
ACTUATOR- POM, UJ94HB BLACK  
TERMINAL BOARD- PHENOLIC LAMINATED SHEET, UL94HB, NATURAL  
FRAME- STEEL, NICKEL PLATE  
TERMINAL/FIXED CONTACT- COPPER ALLOY, GOLD OR SILVER OVER NICKEL PLATE  
MOVING CONTACT- COPPER ALLOY, GOLD OR SILVER OVER NICKEL PLATE  
DETENT BALL- STEEL  
COIL SPRING- GALVANIZED SPRING WIRE  
LEVER,(K-SERIES ONLY)- ALUMINUM  
SEAL- EPOXY

ELECTRICAL:  
CONTACT RATING- .4VA@20VDC OR PEAK AC (GOLD); 300mA@125V AC (SILVER)  
INITIAL CONTACT RESISTANCE- 30 milliohm max.  
FINAL CONTACT RESISTANCE- 100 milliohm max. (AFTER TEST)  
INSULATION RESISTANCE- 1,000 Megohms min.  
DIELECTRIC STRENGTH- 500V RMS@SEA LEVEL  
LIFE EXPECTANCY- 15,000 CYCLES MIN.

MECHANICAL:  
ACTUATION FORCE- 600+/-300 GRAMS  
TRAVEL- SEE P/N TABLE

ENVIRONMENTAL:  
OPERATING TEMPERATURE- -20 TO +85 DEGREES C  
STORAGE TEMPERATURE- -40 TO +100 DEGREES C  
RESISTANCE TO SOLDER HEAT PER 109-202, CONDITION B  
SOLDERABILITY PER EIA-364-52, CLASS 2, CATEGORY 1, 95% MIN COVERAGE

NOTES:

- COUNTRY OF ORIGIN AND TE CONNECTIVITY LOGO LOCATED APPROXIMATELY AS SHOWN
- ALL MATERIALS AND FINISHES SHALL COMPLY WITH EU DIRECTIVE 2002/95/EC OF 27JAN2003 (ROHS)
- ANTI SOLDER WICK SEAL AT TERMINAL TO BOARD INTERFACE
- ALL PERFORMANCE TESTING WAS DONE IN ACCORDANCE TO TE CONNECTIVITY SPECIFICATION 102-2469
- OBsolete PARTS: OBSOLETE CIS STREAMLINING PER D.RENAUD/D.SINISI

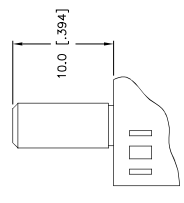
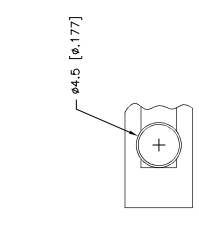

MHS-122K LEVER

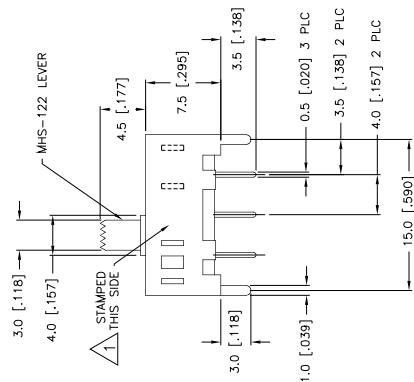
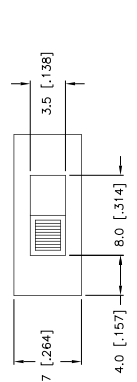

- 0.4 [0.016]
- 0.5 [0.020]
- 2.0 [0.079]
- 6.2 [0.244]

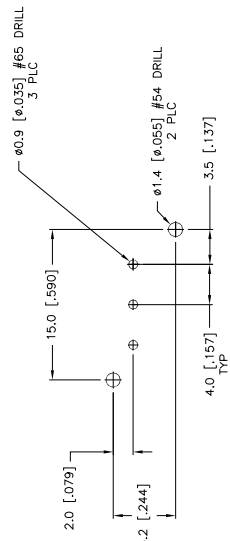
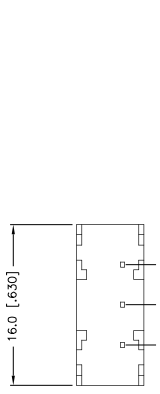

RECOMMENDED BOARD LAYOUT  
PC LAYOUT TOLERANCE: ±.002

# MHS-122 SERIES SWITCH

OBsolete	1-1825255-0	MHS133K004	SP3T	2.00	GOLD	-	2-1	-	2-3	-	2-4
	1825255-9	MHS133K004	SP3T	2.00	SILVER	-	2-1	-	2-3	-	2-4
	1825255-8	MHS133004	SP3T	2.00	GOLD	-	2-1	-	2-3	-	2-4
	1825255-7	MHS13304	SP3T	2.00	SILVER	-	2-1	-	2-3	-	2-4
	-	MHS122K004	SPDT	2.00	GOLD	2-1	-	OFF	-	2-3	-
	1825255-6	MHS122K004	SPDT	2.00	SILVER	2-1	-	OFF	-	2-3	-
	-	MHS123004	SPDT	2.00	GOLD	2-1	-	OFF	-	2-3	-
	1825255-5	MHS12304	SPDT	2.00	SILVER	2-1	-	OFF	-	2-3	-
	1825255-4	MHS122K004	SPDT	4.00	GOLD	2-1	-	NONE	-	2-3	-
	1825255-3	MHS122K004	SPDT	4.00	SILVER	2-1	-	NONE	-	2-3	-
	1825255-2	MHS122004	SPDT	4.00	GOLD	2-1	-	NONE	-	2-3	-
	1825255-1	MHS12204	SPDT	4.00	SILVER	2-1	-	NONE	-	2-3	-
PART NO.	T&B PART NO.	TYPE	TRAVEL	PLATING	TERMINALS CONNECTED WHEN SLIDE IS IN POSITION, 3RD VIEW	TERMINALS CONNECTED WHEN SLIDE IS IN POSITION, 2ND VIEW	TERMINALS CONNECTED WHEN SLIDE IS IN POSITION, 1ST VIEW	TERMINALS CONNECTED WHEN SLIDE IS IN POSITION, 4TH VIEW	TERMINALS CONNECTED WHEN SLIDE IS IN POSITION, 5TH VIEW	TERMINALS CONNECTED WHEN SLIDE IS IN POSITION, 6TH VIEW	TERMINALS CONNECTED WHEN SLIDE IS IN POSITION, 7TH VIEW

THIS DRAWING IS A CONTROLLED DOCUMENT. THIS DRAWING IS THE PROPERTY OF TE CONNECTIVITY. IT IS TO BE KEPT IN CONFIDENCE AND NOT TO BE REPRODUCED OR TRANSMITTED IN ANY FORM OR BY ANY MEANS, ELECTRONIC OR MECHANICAL, INCLUDING PHOTOCOPYING, RECORDING, OR BY ANY INFORMATION STORAGE AND RETRIEVAL SYSTEM.

TE CONNECTIVITY

SLIDE SWITCH, MHS SERIES, SINGLE POLE, VERTICAL

DATE: 01/07/99  
DRAWING NO: A100779  
REVISED TO: 1825255

CUSTOMER DRAWING

SCALE: 4:1

REV: 1 2

NO. 10711

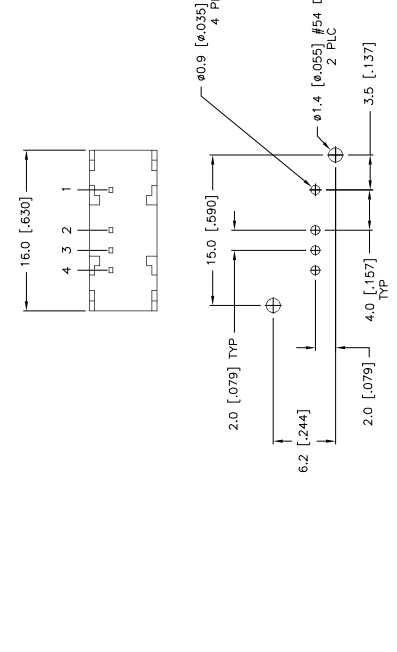
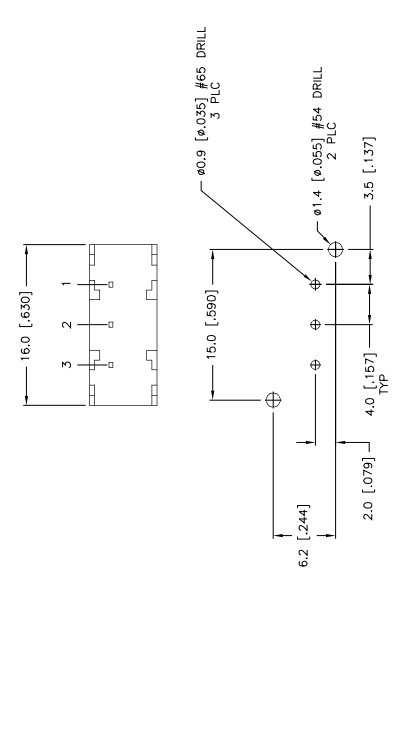
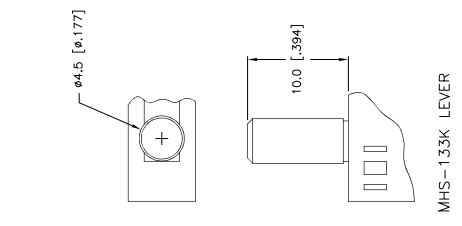
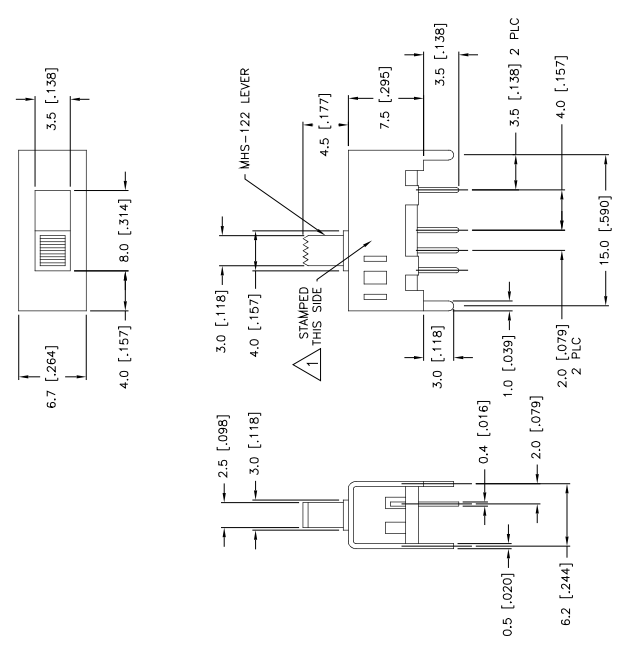
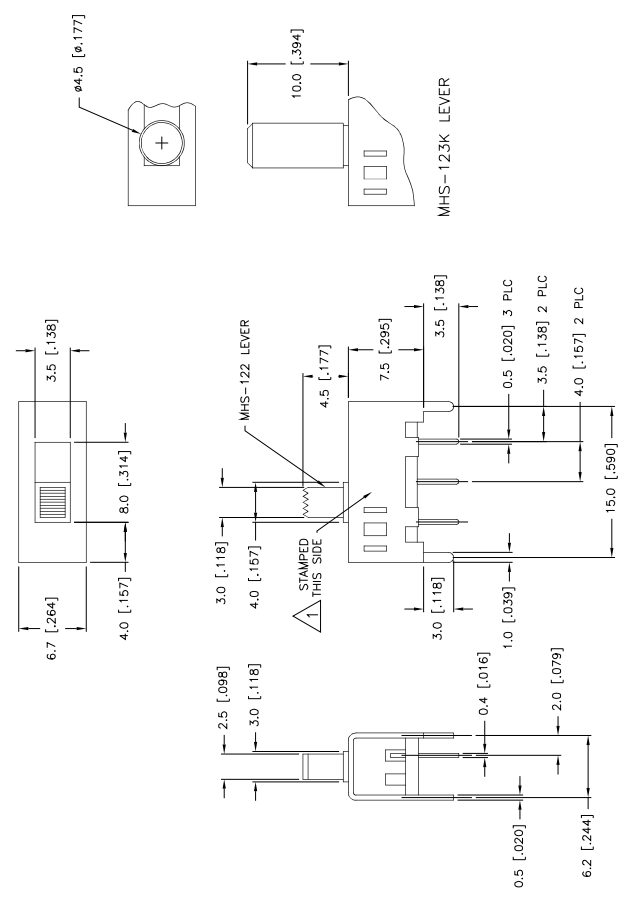

### MHS-123 SERIES SWITCH

### MHS-133 SERIES SWITCH

THIS DRAWING IS A CONTROLLED DOCUMENT.		REV	DATE	BY	CHKD	APP'D
0	PLC					
1	PLC					
2	PLC					
3	PLC					
4	PLC					
5	PLC					
6	PLC					
7	PLC					
8	PLC					
MATERIAL		REV	DATE	BY	CHKD	APP'D
CUSTOMER DRAWING		1	00779			
TE Connectivity		SCALE	4:1	SHEET	2	OF 2
SLIDE SWITCH, MHS SERIES, SINGLE POLE, VERTICAL		DATE		DRAWN BY		RESTRICTED TO