

PART NUMBER	REV	FIRST USED
567921-1	A	854040-3

TERMINAL NAME: POST CONTACT					
VISIBLE	CRIMP HEIGHT	WIRE SIZE			
A	.022 ± .002 [0.57 ± 0.05mm]	26			
B	.020 ± .002 [0.52 ± 0.05mm]	28			
C	.019 ± .002 [0.48 ± 0.05mm]	30			
D	NOT	USED			
CRIMP	SIZE	TYPE	RANGE		
WIRE	.033 [0.80mm]	F	30-26		
INSUL	.046 [1.18mm]	F	φ.027-.038		
WIRE STRIP LENGTH	TERM APPL SPEC	FEED	APPL INSTRUCTION	SET UP GAGE	LAYOUT
-	114-5212	.315	SEE CUSTOMER MANUAL	NONE	L1779

REF	QTY	REV	PART NO	DESCRIPTION	ITEM NO
					70
					69
					68
					67
					66
					65
					64
					63
					62
					61
					60
					59
					58
					57
REF	-	B	694433-8	PAWL, FEED	56
					55
					54
					53
					52
					51
					50
					49
1	-	A	690602-6	CAM, PRE-FEED 1.62 STROKE	48
					47
					46
1	-	A	690191-1	PLUG, NYLON	45
1	-	C	455673-1	RAM	44
1	-	A	690125-1	WASHER, LAMINATED	43
1	-	A	690124-9	WASHER, RAM	42
1	-	A	7-21002-9	BOLT, CRIMPER (5/16x1.00)	41
1	-	A	23241-6	BALL, STEEL	40
1	-	A	690170-1	SPRING, COMPRESSION	39
1	-	C	690142-1	DISC, INSULATION	38
1	-	D	354777-1	WIRE DISC, PLASTIC	37
1	-	A	22480-5	WASHER, SPRING	36
1	-	B	690212-1	POST, RAM	35
					34
1	-	C	462544-1	PLATE, BASE SPECIAL	33
1	-	A	690432-3	SCREW, ADJUSTMENT	32
1	-	B	462543-1	BLOCK, SCREW SPECIAL	31
1	-	B	455689-1	BLOCK, STRIP GUIDE ADJ	30
1	-	C	2-455671-5	PLATE, STRIP GUIDE	29
1	-	C	455888-5	SPACER, FRONT SHEAR DEP	28
2	-	A	1-22284-0	SPRING, DRAG	27
1	-	B	690546-1	LEVER, DRAG RELEASE	26
1	-	B	240792-1	DRAG, TERMINAL	25
1	-	D	6-690504-4	GUIDE, STRIP (REAR)	24
1	-	A	690438-1	GUIDE, STRIP (FRONT)	23
					22
1	-	A	463756-1	GUIDE, SCRAP	21
					20
REF	-	C	462615-7	STRIPPER	19
1	-	B	2-690518-4	HOLDER, TERMINAL	18
					17
					16
					15
					14
					13
1	-	A	5-22280-0	SPRING, SHEAR	12
1	-	B	690461-2	STOP, SHEAR (FRONT)	11
1	-	B	462548-1	HOLDER, SHEAR (FRONT) SP	10
1	-	B	462547-1	SHEAR, FLOAT (FRONT) SP	9
1	-	C	8-189717-4	ANVIL	8
					7
1	-	C	455888-8	SPACER, CRIMPER	6
1	-	A	462838-1	DEPRESSOR, SHEAR (FRONT) SP	5
1	-	B	2-238011-8	SPACER, BLOCK CRIMPER	4
1	-	C	7-683453-1	CRIMPER, INSULATION	3
1	-	C	455888-3	SPACER, CRIMPER	2
1	-	C	1-456400-1	CRIMPER, WIRE	1

QTY	REV	REV	PART NO	DESCRIPTION	ITEM NO
2	-	C	4-354779-4	PIN, WIRE DISC (.3210)D	129
2	-	C	3-354779-9	PIN, WIRE DISC (.3185)C	128
					127
2	-	C	4-354779-4	PIN, WIRE DISC (.3300)A	126
1	-	A	986950-1	WASHER, FLAT PRECISION	125
1	-	A	217238-3	GENERAL INSTRUCTION PACKAGE	124
					123
					122
1	-	A	4-21028-0	PIN, SLT SPR (φ.093x.75) ST GDE PL	121
1	-	B	690701-2	PLATE, SERIAL NO.	120
2	-	A	21899-2	WASHER, FLAT (#10) S G ADJ BLK	119
					118
2	-	A	21024-5	WASHER, LOCK (#10) ADJ BLOCK	117
					116
					115
2	-	A	21024-2	WASHER, LOCK (#4) FRONT STP GUIDE	114
REF	-	A	21024-4	WASHER, LOCK (#8) FEED FINGER	113
					112
2	-	A	21024-4	WASHER, LOCK (#8) HOLD DOWN	111
					110
					109
					108
					107
					106
					105
					104
1	-	A	21009-2	SCR, SKT SET (1/4-20x.25 LW) RAM	103
					102
4	-	A	21017-2	SCR, DRIVE (#2x.19) ID PLATE	101
1	-	B	819347-1	PLATE, IDENTIFICATION	100
2	-	A	3-21002-0	SCR, BHC (10-32x.88) DRAG	99
1	-	A	22733-8	SCR, BHC (8-32x.38 LW) ANVIL	98
					97
1	-	A	3-21000-8	SCR, SHC (10-32x.88) MOUNTING	96
1	-	A	2-21002-7	SCR, BHC (10-32x.50) S6 ADJ BLK	95
4	-	A	2-21002-2	SCR, BHC (8-32x.50) SHEAR-TERM SUP	94
2	-	A	2-21000-5	SCR, SHC (8-32x.50) TERM H DWN	93
					92
1	-	A	1-21002-7	SCR, SHC (6-32x.50) CAM	91
2	-	A	2-21000-7	SCR, SHC (8-32x.50) SCR BLK	90
					89
					88
					87
REF	-	A	2-22603-0	SCR, HEX HD (8-32x.31) FEED FINGER	86
2	-	A	1-21000-3	SCR, SHC (4-40x.25) F ST GUIDE	85
REF	-	A	22733-9	SCR, BHC (8-32x.50 SL) STRIPPER	84
					83
					82
1	-	A	3-22603-1	SCR, HEX (10-32x.38) S6 ADJ BL	81
					80
					79
					78
2	-	B	463310-9	BLADE, STRIPPING (#28)	77
					76
					75
1	-	A	690603-1	SPRING, ASSIST	74
1	-	A	23030-1	SCR, SKT CAP (6-32x.25) CP DSC	73
					72
					71

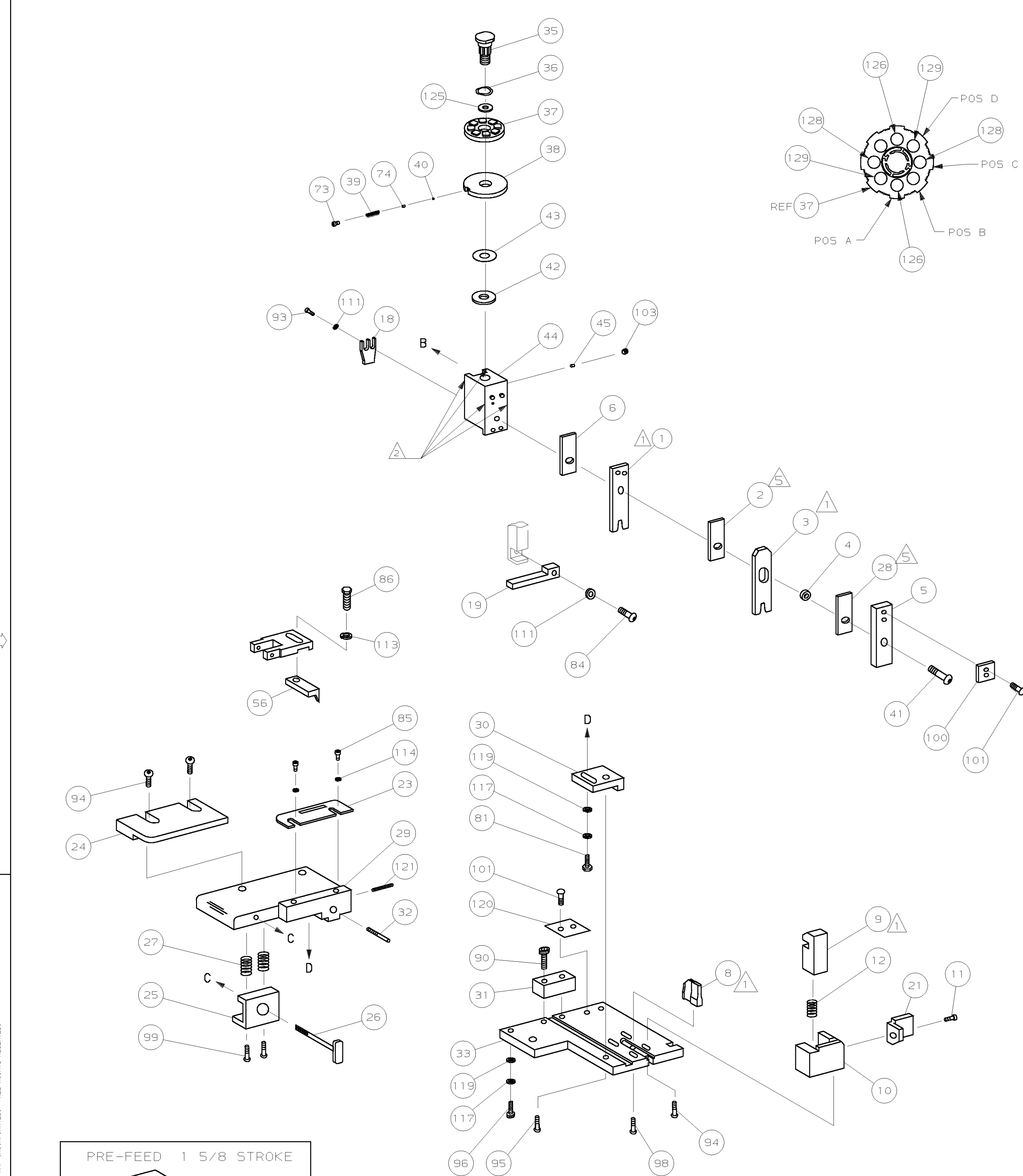

PRE-FEED 1 5/8 STROKE

ROTATED 180°

1 RECOMMENDED SPARE PARTS.
 2 GREASE LIGHTLY.
 3 ITEM NOT SHOWN
 4 GUIDE OFF INSULATION BARREL

1 INSTALL ITEMS NO#2 AND NO#28 WITH THE LONG PORTION OF THE SPACER DOWN TO SUPPORT THE INSULATION CRIMPER.

LOC A
 DIST 66

QTY	REV	REV	PART NO	DESCRIPTION	ITEM NO
-1	U/M	DWG SIZE	PART NO	DESCRIPTION	ITEM NO

QTY	REV	REV	PART NO	DESCRIPTION	ITEM NO
-1	U/M	DWG SIZE	PART NO	DESCRIPTION	ITEM NO

REVISION OF EACH ASSY NO (WHEN BLANK, USE DWG REVISION)

MATL - HT TR - FIN -

DR P.MATHIAS 5/30/96 APP 6-5-96
 T.ELBIN
 CHK 6-5-96 REL -
 C.ERISMAN

AMP AMP Incorporated
 Harrisburg, PA 17105-3608

NAME STRIPPER CRIMPER APPLICATOR MACHINE REF STRIPPER CRIMPER

SCALE - DWG NO 567921 SHEET 1 OF 1 REV A

CASE CODE 00779 CUSTOMER AND ASSEMBLY DRAWING 1 RESTRICTED TO

THIS DRAWING IS A CONTROLLED DOCUMENT.

RELEASED FOR PUBLICATION
 28-APR-99
 BY AMP INCORPORATED. ALL RIGHTS RESERVED.

567921