

- Ideal for printed circuit boards
- High case dielectric strength of 2000VRMS
- Reliable low cost construction
- Compliant to RoHS Directive 2011/65/EU and in accordance to WEEE 2002/96/EC
- Halogen-free according to IEC 61249-2-21 definition



**TS4B**

**MECHANICAL DATA**

**Case :** TS4B

Molding compound, UL flammability classification rating 94V-0  
 Base P/N with suffix "G" on packing code - halogen-free, RoHS compliant

**Terminal :** Matte tin plated leads, solderable per JESD22-B102  
 Meet JESD 201 class 1A whisker test

**Polarity :** Polarity as marked on the body

**Mounting torque :** 5 in-lbs maximum

**Weight :** 4 gram (approximately)

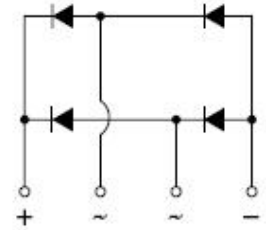

**MAXIMUM RATINGS AND ELECTRICAL CHARACTERISTICS (T<sub>A</sub>=25°C unless otherwise noted)**

PARAMETER	SYMBOL	TSS4B 01G	TSS4B 02G	TSS4B 03G
Maximum repetitive peak reverse voltage	V <sub>RRM</sub>	50	100	200
Maximum RMS voltage	V <sub>RMS</sub>	35	70	140
Maximum DC blocking voltage	V <sub>DC</sub>	50	100	200
Maximum average forward rectified current	I <sub>F(AV)</sub>	4		
Peak forward surge current, 8.3 ms single half sine-wave superimposed on rated load	I <sub>FSM</sub>	150		
Rating for fusing (t<8.3mS)	I <sup>2</sup> T	93		
Maximum instantaneous forward voltage (Note 1) @ 4 A	V <sub>F</sub>	0.98		
Maximum DC reverse current T <sub>J</sub> =25 °C at rated DC blocking voltage T <sub>J</sub> =125°C	I <sub>R</sub>	5 500		
Maximum Reverse Recovery Time(Note 2)	T <sub>rr</sub>	35		
Typical thermal resistance	R <sub>θJC</sub>	5.5		
Operating junction temperature range	T <sub>J</sub>	- 55 to + 150		
Storage temperature range	T <sub>STG</sub>	- 55 to + 150		

Note 1 : Pulse test with PW=300u sec, 1% duty cycle

Note 2 : Reverse Recovery Test Conditions: I<sub>F</sub>=0.5A, I<sub>R</sub>=1.0A, I<sub>RR</sub>=0.25A.

(Note 1)	D2	SMD	TS4B	20 / TUBE
	X2			Forming

Note 1: "x" defines voltage from 50V (TSS4B01G) to 400V (TSS4B04G)

### EXAMPLE

PREFERRED P/N	PART NO.	PACKING CODE	GREEN COMPOUND CODE	DESCRIPTION
TSS4B01G C2	TSS4B01G	C2		
TSS4B01G C2G	TSS4B01G	C2	G	Green compound

### RATINGS AND CHARACTERISTICS CURVES

(TA=25°C unless otherwise noted)

FIG. 1- MAXIMUM FORWARD CURRENT DERATING CURVE

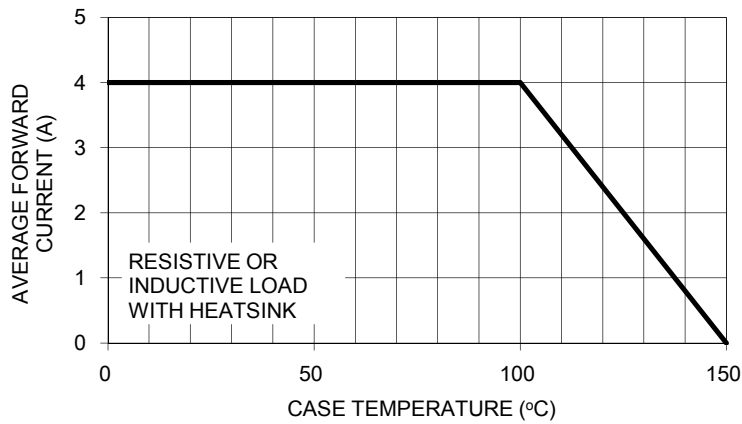

FIG. 2- TYPICAL FORWARD CHARACTERISTICS

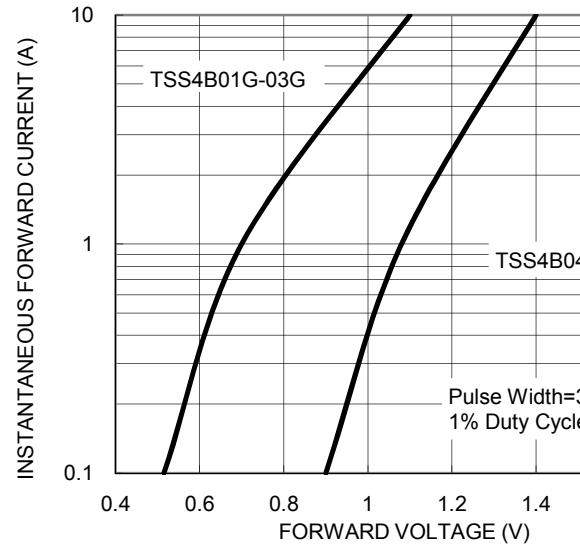

FIG. 3- MAXIMUM NON-REPETITIVE FORWARD SURGE CURRENT

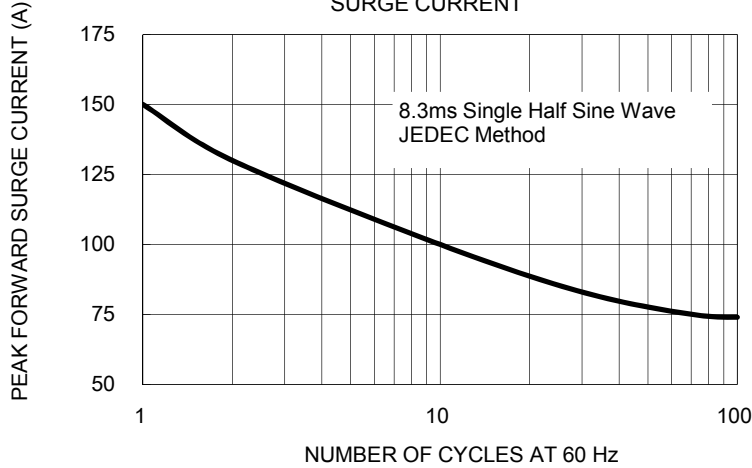
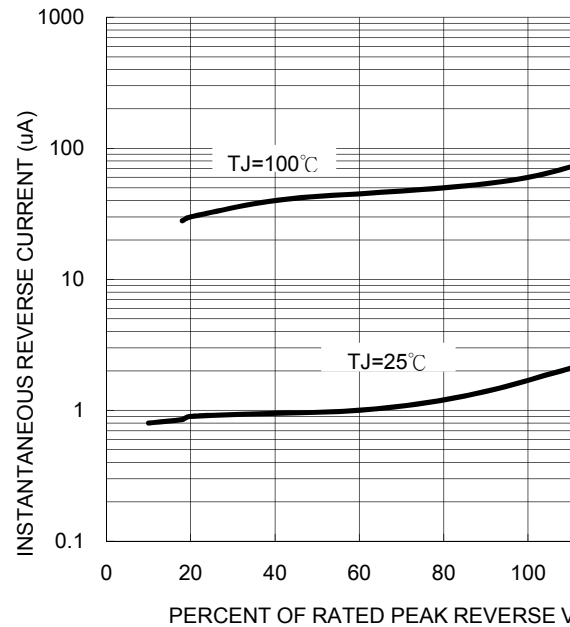
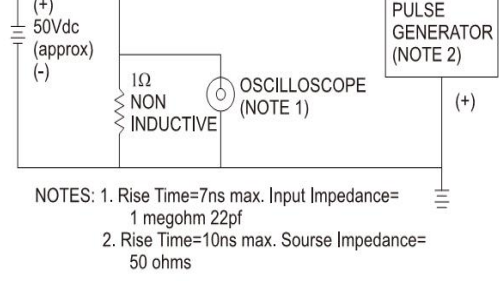
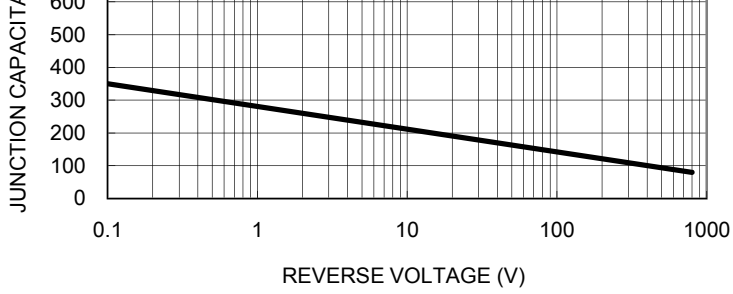
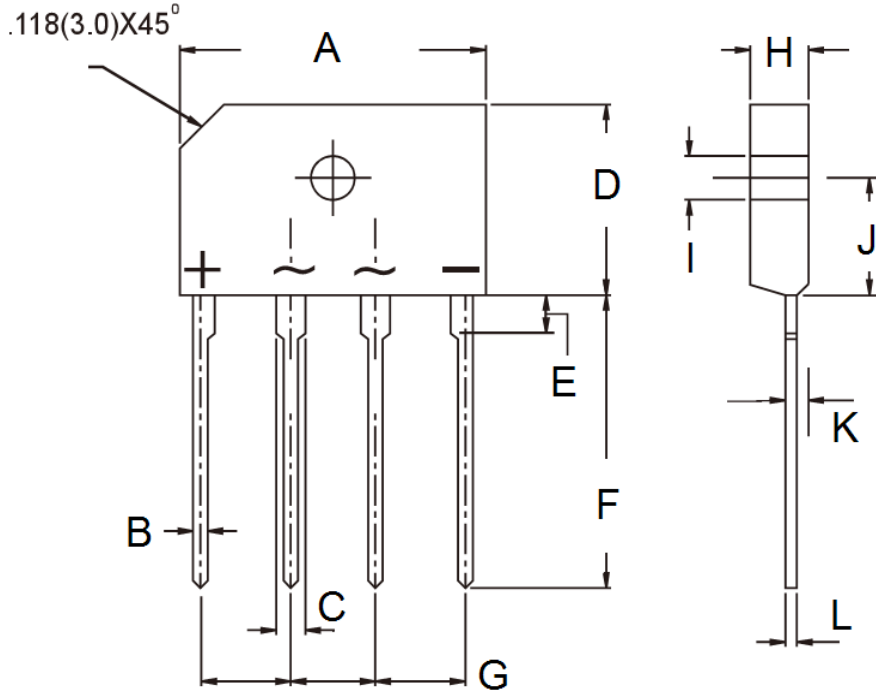

FIG. 4- TYPICAL REVERSE CHARACTERISTICS





PACKAGE OUTLINE DIMENSIONS



DIM.	Unit(mm)		Unit
	Min	Max	
A	24.70	25.30	0.972
B	0.90	1.10	0.035
C	1.80	2.20	0.071
D	14.70	15.30	0.579
E	3.96	4.37	0.156
F	17.00	18.00	0.669
G	7.30	7.70	0.287
H	3.30	3.70	0.130
I	3.10	3.40	0.122
J	9.30	9.70	0.366
K	1.52	1.73	0.060
L	0.55	0.75	0.022

MARKING DIAGRAM



- P/N = Specific Device Code
- G = Green Compound
- YWW = Date Code
- F = Factory Code