

TS10KL60 - TS10KL100

Single Phase 10.0 AMPS.
Glass Passivated Bridge Rectifiers
KBJL

Features

- ✧ Thin Single in-line low profile package ideal for compact required circuit
- ✧ Glass passivated junction
- ✧ High surge current capability
- ✧ Plastic material has Underwriters Laboratory Flammability Classification 94V-0
- ✧ High temperature soldering guaranteed:
260°C/10 seconds
- ✧ Mounting Torque : 5 inch-lbs

Mechanical Data

- ✧ Case: Molded plastic body
- ✧ Terminals: Pure tin plated, lead free, solderable per J-STD-002 guaranteed
- ✧ Polarity : As marked on the Body

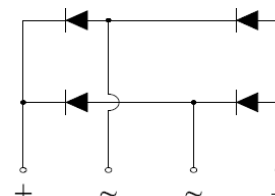
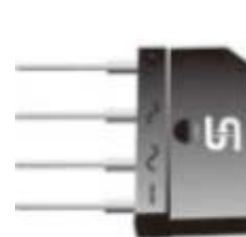

Typical Applications

- ✧ General purpose use in AC to DC full wave rectification for switching power supply.

Ordering Information (example)

Part No.	Package	Packing	Packing code
TS10KL60	KBJL	48 / Tray	T1

Maximum Ratings and Electrical Characteristics

Rating at 25 °C ambient temperature unless otherwise specified.

Parameter	Symbol	TS10KL60	TS10KL80	TS10KL100	Unit
Maximum Repetitive Peak Reverse Voltage	V_{RRM}	600	800	1000	V
Maximum RMS Voltage	V_{RMS}	420	560	700	V
Maximum DC Blocking Voltage	V_{DC}	600	800	1000	V
Maximum Average Forward Rectified Current	$I_{F(AV)}$	10			A
Peak Forward Surge Current, 8.3 ms Single Half Sine-wave Superimposed on Rated Load (JEDEC method)	I_{FSM}	180			A
Rating of fusing ($t < 8.3ms$)	I^2T	134			A ² S
Maximum Instantaneous Forward Voltage @ 5 A (Note 1)	V_F	1.0			V
Maximum Reverse Current @ Rated VR $T_A=25\text{ }^\circ\text{C}$ $T_A=100\text{ }^\circ\text{C}$	I_R	5 150			μA
Typical Thermal Resistance per Leg (Note 2)	$R_{\theta JC}$	11.3			$^\circ\text{C/W}$
Operating Temperature Range	T_J	-55 to +150			$^\circ\text{C}$
Storage Temperature Range	T_{STG}	-55 to +150			$^\circ\text{C}$

Note 1 : Pulse Test with PW=300 usec, 1% Duty Cycle

Note 2 : Mount on Heatsink size of 3" x 5" x 0.25" Al-Plate

Version:A13

RATINGS AND CHARACTERISTIC CURVES (TS10KL60 THRU TS10KL100)

FIG.1 FORWARD CURRENT DERATING CURVE PER DEVICE

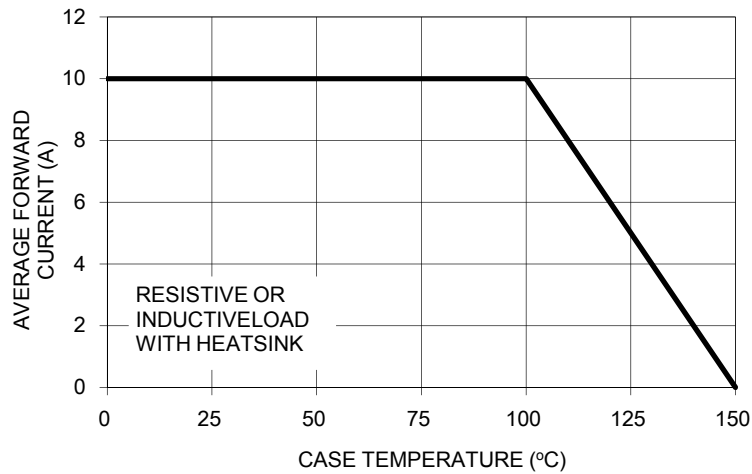

FIG. 3- MAXIMUM NON-REPETITIVE FORWARD SURGE CURRENT PER LEG

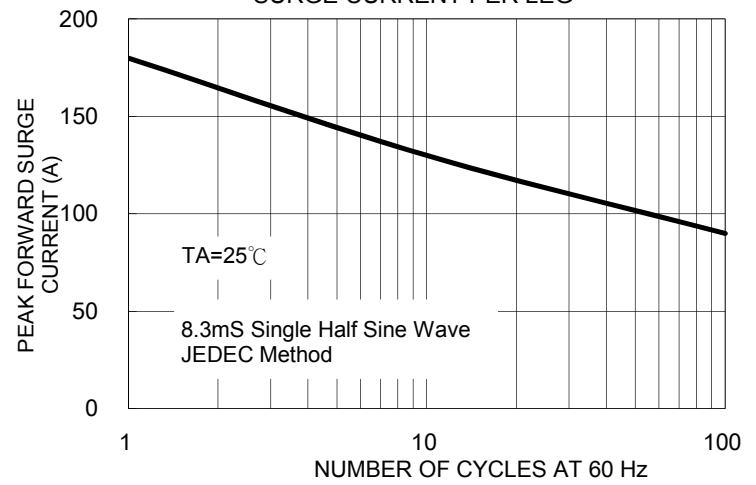

FIG. 5- TYPICAL FORWARD CHARACTERISTICS PER LEG

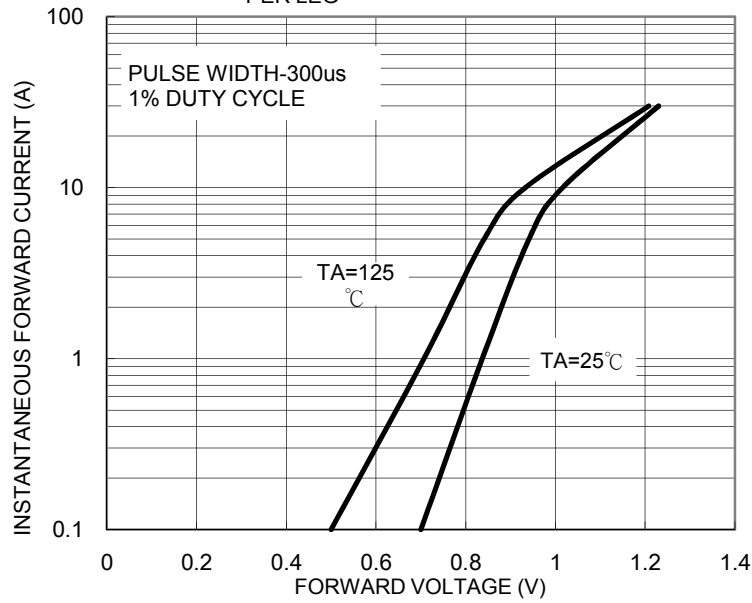

FIG. 2- TYPICAL REVERSE CHARACTERISTICS PER LEG

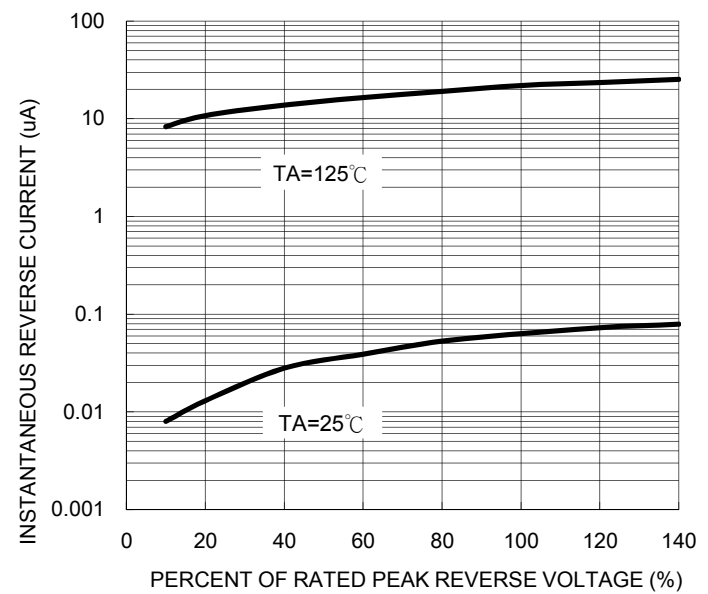
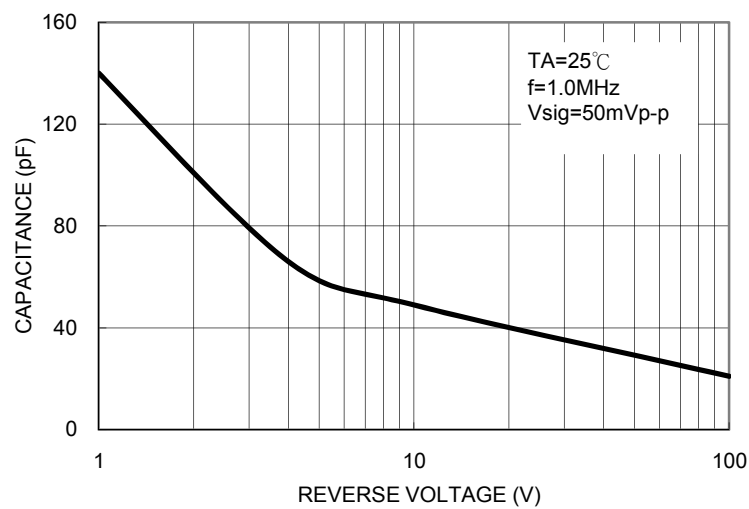

FIG. 4- TYPICAL JUNCTION CAPACITANCE PER LEG



Ordering information

Part No.	Package	Packing	Packing code
TS10KLxx	KBJL	48 / Tray	T1

Note: "xx" is Device Code from "60" thru "100".

Dimensions

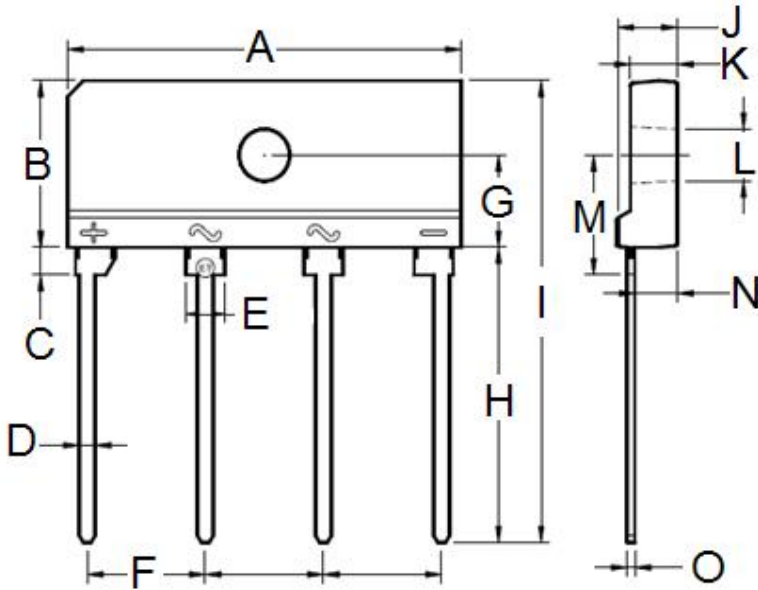

DIM.	Unit(mm)		Unit(inch)	
	Min	Max	Min	Max
A	24.70	25.30	0.972	0.996
B	10.00	10.60	0.394	0.417
C	1.70		0.067	
D	0.90	1.10	0.035	0.043
E	2.30	2.70	0.091	0.106
F	7.30	7.70	0.287	0.303
G	5.50	5.90	0.217	0.232
H	17.70	18.70	0.697	0.736
I	28.50		1.122	
J	3.60	4.00	0.142	0.157
K	2.80	3.20	0.110	0.126
L	3.10	3.40	0.122	0.134
M	7.20	7.60	0.283	0.299
N	2.50	2.90	0.098	0.114
O	0.30	0.70	0.012	0.028

Marking Diagram



P/N = Specific Device Code
 YWW = Date Code

Version:A13