

PHYSICAL DIMENSIONS:

A	6.99 [.275]	+ 0.10 [.004]
B	5.72 [.225]	+ 0.10 [.004]
B ₁	6.73 [.265]	MAX
C	7.62 [.300]	+ 0.13 [.005]
C ₁	8.40 [.330]	MAX.
D	2.41 [.095]	+ 0.08 [.003]
E	0.89 [.035]	+ 0.13 [.005]
E ₁	1.91 [.075]	+ 0.13 [.005]

WIRE:

T ₁	1.91 [.075]	+ 0.25 [.010]
T ₂	0.38 [.015]	+ TYP.
T ₃	0.38 [.015]	+ TYP.

CM2722R151R-10

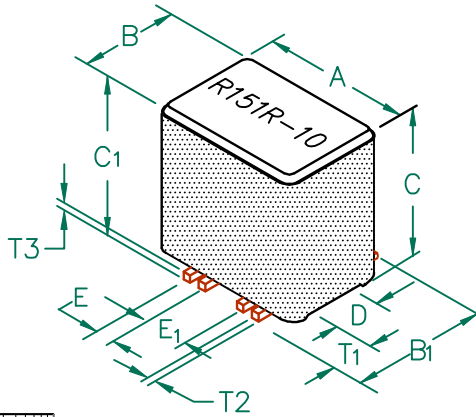

ELECTRICAL CHARACTERISTICS:			
Z @ 100MHz (Ω)	DCR (Ω)	Rated Current	
Nominal	150		
Minimum	120		
Maximum	-	0.02	5,000 mA

NOTES: UNLESS OTHERWISE SPECIFIED

1. TAPED AND REELED per CURRENT EIA SPEC. 13" REELS, 600 PCS per REEL.
2. COMPONENTS SHOULD BE ADEQUATELY PREHEATED BEFORE SOLDERING.
3. REF. CARRIER TAPE SPECIFICATION #CART2722-1P.
4. TERMINATION FINISH IS 100% TIN.
5. THIS PART HAS NO PIN POLARITY.

Z vs. FREQUENCY (C,O,N)

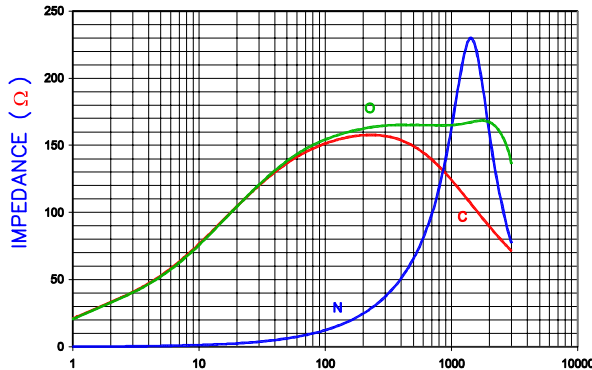

FREQUENCY (MHz)

Z, R, XL vs. FREQUENCY

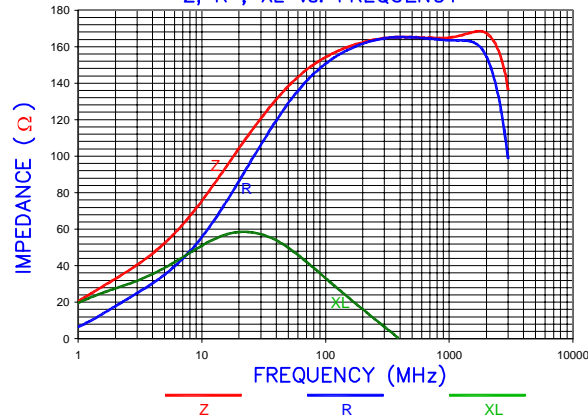

LAND PATTERNS FOR REFLOW SOLDERING

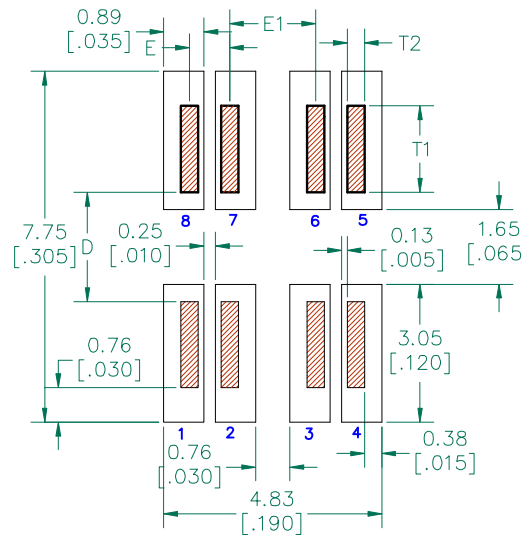

RECOMMENDED SOLDERING CONDITIONS

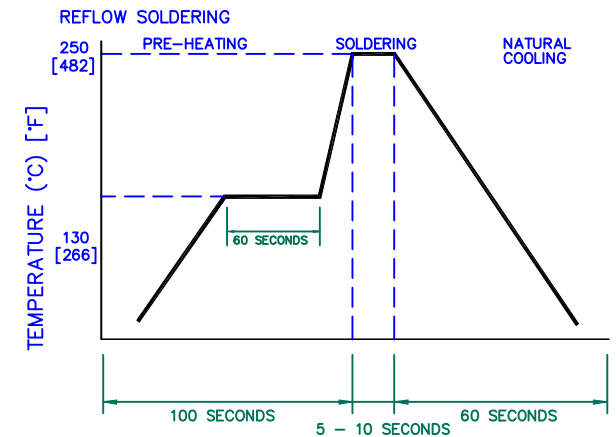

UNCONTROLLED DOCUMENT

DIMENSIONS ARE IN mm (INCHES).				THIS DOCUMENT CONTAINS INFORMATION WHICH IS PROPRIETARY AND CONFIDENTIAL TO STEWARD. NO PRODUCTION OR PUBLICATION OF THIS DOCUMENT IN WHOLE OR IN PART SHALL BE MADE WITHOUT WRITTEN AUTHORIZATION FROM STEWARD.			
				Steward			
				PROJECT/PART NUMBER: CM2722R151R-10	REV A	PART TYPE: ASSEMBLY	DRAWN BY: JRK
				DATE: 5/26/04	SCALE: NTS	SHEET: 2 of 3	
REV A	DESCRIPTION ORIGINAL DRAFT	DATE 5/26/04	INT JRK	CAD # CM2722R151R-10-A-2	TOOL # H0275-1		