

RPCE-01-E-00.25-D-C5E

RPBE-01-01-E

RPBE, RPCE SERIES

IP68 SEALED ETHERNET SOCKET

Mates with:

RCE

SPECIFICATIONS

For complete specifications see www.samtec.com?RPBE

Insulator Material: Black Liquid Crystal Polymer

Contact: Phosphor Bronze

Operating Temp Range: -40 °C to +75 °C

Seal: Rubber

Screw: Stainless Steel

Nut: Stainless Steel

Sealing Washer: Rubber

DUST CAPS

PORT	PART NO.	TYPE
-01	DCA-RPBE-01-01-P	Push-On/No Latch
-01	DCA-RPBE-01-01-L	Latching
-02	DCA-RPBE-02-01-L	

Note: Meets IP68 requirements for dust and waterproof sealing when mated or with dust cap.

RPBE	NO. OF PORTS	LEAD STYLE	PLATING
-01, -02		-01 = Right-angle	-E = 50 μ" (1.27 μm) Gold on contact, Flash Gold on tail

NO. OF PORTS	A	B	C
-01	(46.10) 1.815	(36.95) 1.455	(19.72) .776
-02	(67.10) 2.642	(57.95) 2.281	(40.72) 1.603

APPLICATION

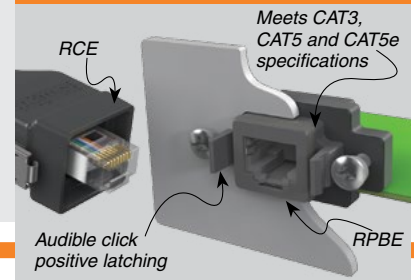

Mates with:

RCE

SPECIFICATIONS

For complete specifications see www.samtec.com?RPCE

Insulator Material: Glass Filled Thermoplastic

Contact: Phosphor Bronze

Shield: Phosphor Bronze

Operating Temp Range: -40 °C to +75 °C

Overmold: Rite Flex 640F

Seal: Rubber

Screw: Stainless Steel

Nut: Stainless Steel

Sealing Washer: Rubber

Wire: 24 AWG

DUST CAPS

PORT	PART NO.	TYPE
-01	DCA-RPBE-01-01-P	Push-On/No Latch
-01	DCA-RPBE-01-01-L	Latching
-02	DCA-RPBE-02-01-L	

Note: Meets IP68 requirements for dust and waterproof sealing when mated or with dust cap.

RPCE	01	PLATING	WIRE LENGTH	END OPTION	C5E
-E = 50 μ" (1.27 μm) Gold on contact, Nickel on shell			-00.25 = (0.25 m) 9.84" -00.50 = (0.50 m) 19.69" Standard lengths	-D = Double Ended -BC = Blunt Cut	

ALSO AVAILABLE (MOQ Required)

- Other wire lengths Contact Samtec.

Due to technical progress, all designs, specifications and components are subject to change without notice.