



JSO SERIES

JACK SCREW STANDOFF

SPECIFICATIONS

For complete specifications and recommended PCB layouts see www.samtec.com?JSO

Material: Stainless Steel
Locking Compound: Nylon

BOARD STACKER	A	B	BOARD STACK HEIGHT
-0415	(4.15) .163	(2.50) .098	4 mm
-0515	(5.15) .203	(3.50) .138	5 mm
-0715	(7.15) .281	(5.50) .217	7 mm
-0815	(8.15) .321	(6.50) .256	8 mm
-1015	(10.15) .400	(8.50) .335	10 mm
-1115	(11.15) .439	(9.50) .374	11 mm
-1615	(16.15) .636	(14.50) .571	16 mm

ALSO AVAILABLE (MOQ Required)

- Other heights
 - Locking compound removed
- Contact Samtec.

Notes:
 Patent Pending

Standoffs are designed, 0.15 mm longer than connector stack heights to allow for processing variables.

Some sizes, styles and options are non-standard, non-returnable.

JSO	BOARD STACKER	LEAD STYLE	LOCKING OPTION
	Specify BOARD STACKER from chart	<p>-01 = Press-In (-0415, -0515, -0715, -0815 only)</p> <p>-03 = Male Thread (-0815, -1015, -1115, -1615 only)</p>	<p>-L = Locking compound (Not available with -01 lead style, Required for -03 lead style)</p>

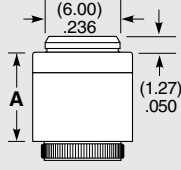
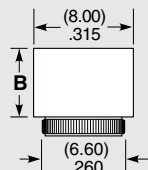
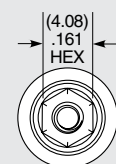
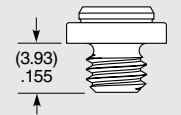
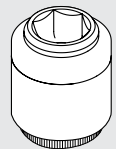
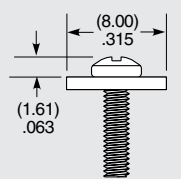

-01 LEAD STYLE

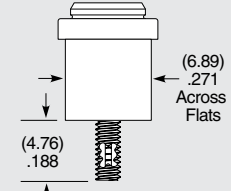
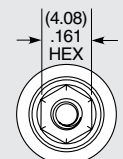
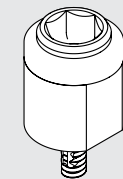
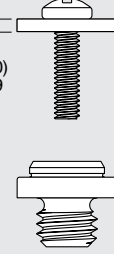
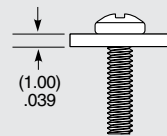

-03 LEAD STYLE

Components are to be packaged in separate bags unassembled.

APPLICATION

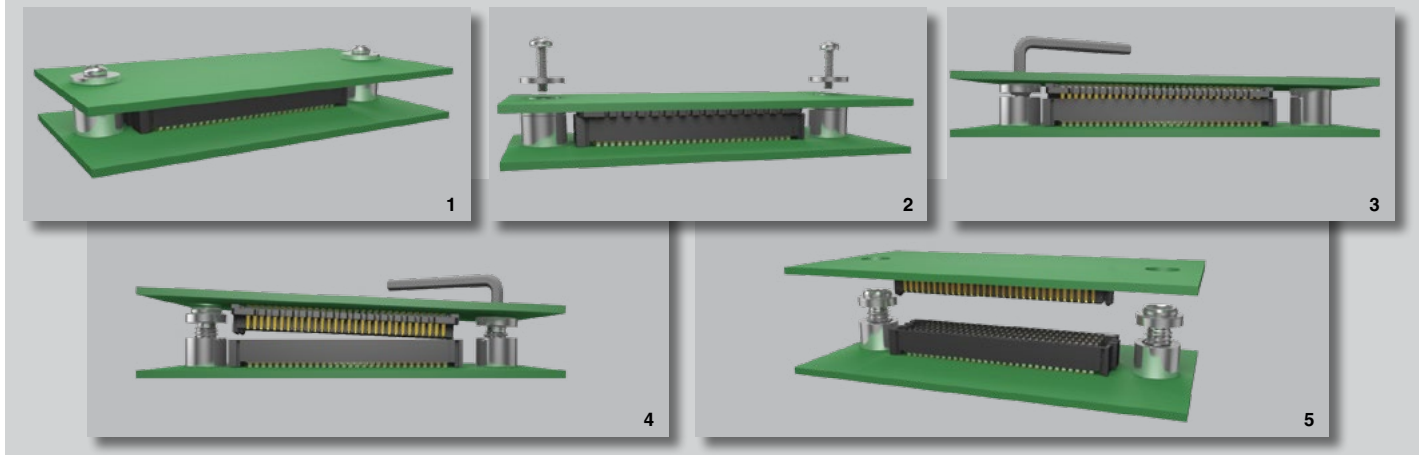

Due to technical progress, all designs, specifications and components are subject to change without notice.