

**Technical data****// P65THR 1 03 - -**

Rotary Code Switch

Through Hole Reflow

**Highlights**

Solid PCB pins

Contacts with abrasion resistant hard gold plating

ESD-protection on request

100 % electronic inspection and testing

Mechanical Data

Type	horizontal
Fixation mode	THR
Height	6.5 mm
Length	10.0 mm
Width	10.0 mm
Pin connection	3+3
Perm. ambient temperature	-60 °C ... +125 °C
Perm. storage temperature	-65 °C ... +135 °C
Torque	(typically) 1.3 Ncm
Mech. lifetime	30.000 steps
Reflow soldering	10 s / 260 °C
Wave soldering	Double Wave acc. DIN EN 61760-1:2006
Iron soldering	2 s / 340 °C
THR through holes	plated through
THR PCB hole diameter	1.0 mm
Outside diameter plated land	1.8 mm

Electrical Data

Operating voltage	≤ 42.0 V
Contact load, static	≤ 0.2 A
Contact load, dynamic	≤ 0.1 A
Minimum load	1.0 μ A 20mVDC
Test voltage	250.0 V 50 Hz / 1.0 min
Contact resistance	< 80.0 mOhm
Insulation resistance	> 100.0 MOhm

Contact pins

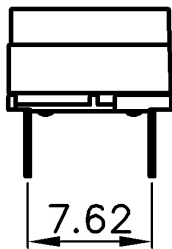

Straight

Packing

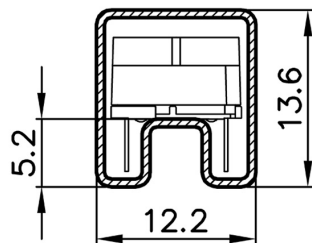

Tube