

# Panel feed-through - QPD W 3PE2,5 M25 0,5 BK - 1582187

Please be informed that the data shown in this PDF Document is generated from our Online Catalog. Please find the complete data in the user's documentation. Our General Terms of Use for Downloads are valid (<http://download.phoenixcontact.com>)



QUICKON panel feed-through, black, 3-pos. +PE, 1.0 mm<sup>2</sup> ... 2.5 mm<sup>2</sup> / 630 V / 20 A, without QUICKON nut, with 4 welded-on 2.5 mm<sup>2</sup> cable wires, 0.5 m long, cut flat at the end.



## Key commercial data

Packing unit	0
Minimum order quantity	1
Catalog page	Page 97 (PC-2011)
GTIN	 4 046356 316897
Custom tariff number	85366990
Country of origin	GERMANY

## Technical data

### General characteristics

Design	QPD 4x2,5
Color	black
Locking type	Screw locking
Connection method	QUICKON connection
Connection method	IDC connection
Number of positions	4
Note number of positions	3+PE
Wrench size, union nut	22 mm
Tightening torque, union nut	5 Nm
Tightening torque, counter nut	5 Nm
Wrench size, counter nut	27 mm
Number of connections	10
Conductor cross section stranded min.	1.5 mm <sup>2</sup>
Conductor cross section stranded max.	2.5 mm <sup>2</sup>
Conductor cross section solid min.	1 mm <sup>2</sup>
Conductor cross section solid max.	2.5 mm <sup>2</sup>
Conductor cross section AWG/kcmil min.	16

# Panel feed-through - QPD W 3PE2,5 M25 0,5 BK - 1582187

## Technical data

### General characteristics

Conductor cross section AWG/kcmil max	14
---------------------------------------	----

### Conductor data

Structure of individual litz in acc. with VDE 0295 / smallest wire diameter	VDE 0295 class 1 to 6 / min. 0.15 mm
Wire insulation material	PVC / PE
Wire diameter including insulation	2.5 mm ... 3.8 mm
External cable diameter	6 mm ... 14 mm (Order Quickon nuts or Quickon connectors separately)

### Environmental conditions

Degree of protection	IP68, 24 h / 2 m
Ambient temperature (operation)	-40 °C ... 80 °C
Ambient temperature (storage/transport)	-40 °C ... 80 °C
Temperature when conductor connected	-5 °C ... 50 °C

### Electrical characteristics

Nominal current $I_N$	20 A
Rated current	20 A
Rated voltage (III/3)	630 V
Rated voltage (III/2)	1000 V
Rated voltage (II/2)	1000 V
Rated surge voltage (III/3)	6 kV
Rated surge voltage (III/2)	8 kV
Rated surge voltage (II/2)	8 kV

### Mechanical characteristics

QUICKON connectability	max. 10
------------------------	---------

### Material data

Contact material	CuZn
Contact surface material	Tin-plated
Contact carrier material	PA
Insulating material	PA
Inflammability class according to UL 94	V0
Surge voltage category	III
Pollution degree	3

## Classifications

### ETIM

ETIM 2.0	EC001297
ETIM 3.0	EC000516
ETIM 4.0	EC000516
ETIM 5.0	EC000516

# Panel feed-through - QPD W 3PE2,5 M25 0,5 BK - 1582187

## Classifications

### UNSPSC

UNSPSC 11	39121522
UNSPSC 12.01	39121522
UNSPSC 13.2	39121522
UNSPSC 6.01	30211923
UNSPSC 7.0901	39121522

### eCl@ss

eCl@ss 4.0	27140815
eCl@ss 4.1	27140815
eCl@ss 5.0	27143423
eCl@ss 5.1	27143423
eCl@ss 6.0	27143423
eCl@ss 7.0	27449001

## Approvals

### Approvals

Approvals

VDE Zeichengenehmigung / IECCEB Scheme / GOST

Ex Approvals

Approvals submitted

### Approval details

VDE Zeichengenehmigung 	
mm <sup>2</sup> /AWG/kcmil	1.5-2.5
Nominal current I <sub>N</sub>	20 A
Nominal voltage U <sub>N</sub>	690 V

IECCEB Scheme 	
mm <sup>2</sup> /AWG/kcmil	1-2.5

## Panel feed-through - QPD W 3PE2,5 M25 0,5 BK - 1582187

### Approvals

Nominal current IN	20 A
Nominal voltage UN	690 V



### Accessories

#### Accessories

#### Assembly

Nut - Q-MU M25 - 1640715



Nut (plastic) to lock the contact carrier from the inside of the device

### Marking

Plastic label - EMLP (13X9)R - 0819453



Plastic label, Roll, white, Unlabeled, Can be labeled with: Thermomark R, Thermomark X, Thermomark S, Mounting type: Adhesive, Lettering field: 13 x 9 mm

### Plug/Adapter

Coding profile - CP-QPD - 1582459



Keying profile red, for pushing into the QUICKON dome and connector, can be positioned in 90° steps.

### Tools

## Panel feed-through - QPD W 3PE2,5 M25 0,5 BK - 1582187

### Accessories

Socket wrench - QSS 22 - 1670206



Allen wrench, for loosening and fastening the QUICKON union nut, WAF 22 mm

---

Engraving material - GPE 13X 9 WH - 0806932



Engraving material, Sheet, white, Unlabeled, Can be labeled with: Gravur, Plotter, Mounting type: Adhesive, Lettering field: 13 x 9 mm

---

Protective cap - QPD QSK 2,5 FS - 1582488



Plastic protective cap, for QPD-QUICKON connectors, green, with holding band, IP68

---

Protective cap - QPD QSK 2,5 - 1582150



Protective cap made of transparent plastic for QPD QUICKON connection 4x 2.5 mm<sup>2</sup>, IP54.

---

Grommet - KV-DI-PG16-1XASI - 1582462



Seal for one AS-i line, 17.2 x 9 mm, from NBR, black, for IP65/67 degree of protection

---

# Panel feed-through - QPD W 3PE2,5 M25 0,5 BK - 1582187

## Accessories

Grommet - KV-DI-PG16-2XASI - 1582464



Seal for two AS-i lines, 17.2 x 9 mm, from NBR, black, for IP65/67 degree of protection

Nut - QPD N 2,5 6-10 BK - 1582226



QUICKON nut, black, 3-pos. +PE, 1.0 mm<sup>2</sup> ... 2.5 mm<sup>2</sup> / 630 V / 20 A, for cables with diameters of 6 mm ... 10 mm.

Nut - QPD N 2,5 9-14 BK - 1582229



QUICKON nut, black, 3-pos. +PE, 1.0 mm<sup>2</sup> ... 2.5 mm<sup>2</sup> / 630 V / 20 A, for cables with diameters of 9 mm ... 14 mm.

## Drawings

### Diagram

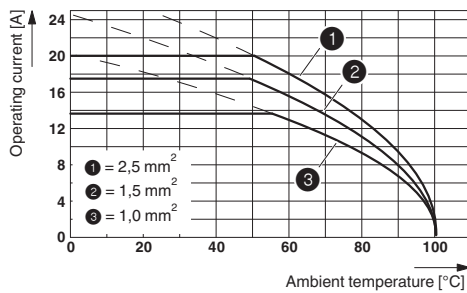

### Dimensioned drawing

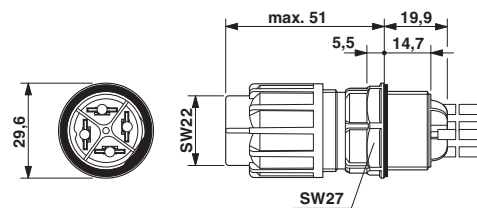

### Dimensional drawing

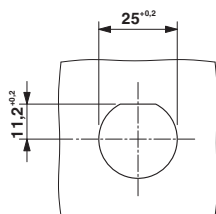

### Panel cutout



---

© Phoenix Contact 2012 - all rights reserved  
<http://www.phoenixcontact.com>