

**Technical Data**  
**Material:**  
 Brass machined, CuZn38Pb2  
 Beryllium copper, heat treated or PHBZ  
 Tin plated : 2um/80u"nickel,5um/200u"tin  
 Gold plated: 2um/80u"nickel,2um/80u"Gold  
 2um/80 u"nickel,gold Flash  
 Glass filled thermoplastic polyester UL94V-0

**Electrical**  
 3 Amps/contact max.  
 4mc/contact  
 10000Mcoat 500VAC  
 100 VRMS /150VDC

**Mechanical**  
 Operating temperature : -40° C to +105° C  
 -67° F to +105° F

Average insertion force with steel pin of: £X0.43mm/0.017" ~ 250g  
 Average withdrawal force with steel pin of £X 0.43mm/0.017" ~50g  
 Mechanical life : min. 200 Cycles

**Environmental data**  
 Solderability (IEC 60068-2-20. Ta) :235° C, 2s  
 Resistance to soldering heat (IEC 60068-2-20. Tb) :  
 -Through hole mount components :260° C, 10s

**RoHS Compliant**

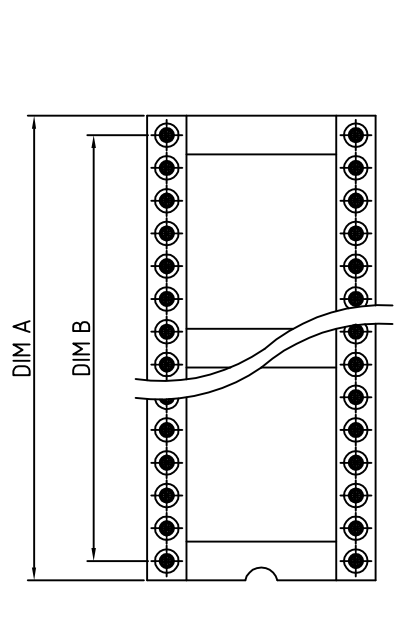
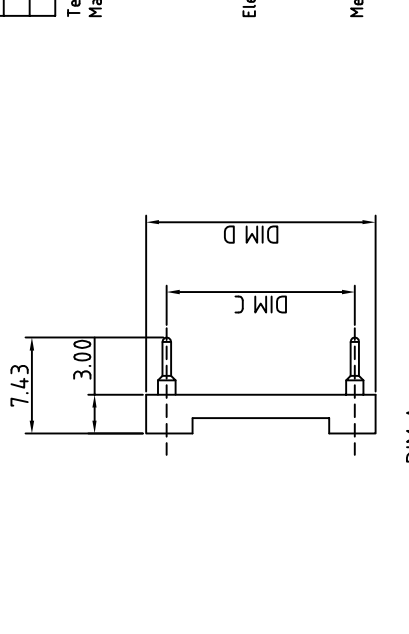

**PART NUMBER:**  
**SAXXX0X0**

No. of Contacts (See chart)  
 0: Tin  
 4: Gold

Plating

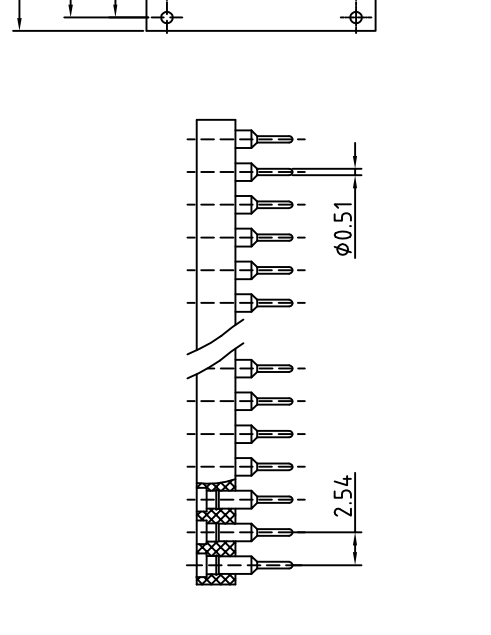
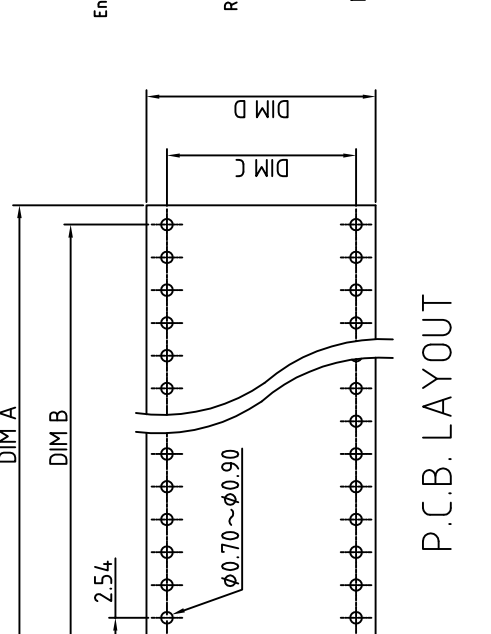

THESE DRAWINGS AND SPECIFICATIONS ARE THE PROPERTY OF ON-SHORE TECHNOLOGY, INC. AND SHALL NOT BE REPRODUCED, COPIED OR USED IN ANY MANNER WITHOUT THE PRIOR WRITTEN CONSENT OF ON-SHORE TECHNOLOGY, INC.

**OSI ON-SHORE TECHNOLOGY, INC.**

IC/SKIT SA 7.43 mmL finished products series (Open frame)

TITLE	PART NO.	DESIGNED	DRAWN	DWG NO.	SAXXX0X0.dwg
SA7430X0	Aaron	Aaron	Aaron	2006.01.12	2006.01.12
SA7430X0	2006.01.12	2006.01.12	2006.01.12	2006.01.12	2006.01.12

CHECKED: Aaron 2006.01.12  
 APPROVED: Aaron 2006.01.12

UNIT: mm  
 SCALE: NONE  
 REV.: C

Tolerance:  
 X: ±0.50  
 XX: ±0.30  
 XXX: ±0.10  
 X\*: ±1"

SHEET: 01/01 REV.: C

**P.C.B. LAYOUT**

P/N	Contact	Dim A	Dim B	Dim C	Dim D	P/N	Contact	Dim A	Dim B	Dim C	Dim D
SA0630X0	6	7.62	5.08	7.62	10.16	SA2460X0	24	30.48	27.94	15.24	17.78
SA0830X0	8	10.16	7.62	7.62	10.16	SA2860X0	28	35.56	33.02	15.24	17.78
SA1030X0	10	12.70	10.16	7.62	10.16	SA3260X0	32	40.64	38.10	15.24	17.78
SA1430X0	14	17.78	15.24	7.62	10.16	SA3660X0	36	45.72	43.18	15.24	17.78
SA1630X0	16	20.32	17.78	7.62	10.16	SA4060X0	40	50.80	48.26	15.24	17.78
SA1830X0	18	22.86	20.32	7.62	10.16	SA4260X0	42	53.34	50.80	15.24	17.78
SA2030X0	20	25.40	22.86	7.62	10.16	SA4860X0	48	60.96	58.42	15.24	17.78
SA2430X0	24	30.48	27.94	7.62	10.16	SA5260X0	52	66.04	63.50	15.24	17.78
SA2830X0	28	35.56	33.02	7.62	10.16	SA6490X0	64	81.28	78.74	22.86	25.40
SA2240X0	22	27.94	25.40	10.16	12.70						