

4611110010418

保密

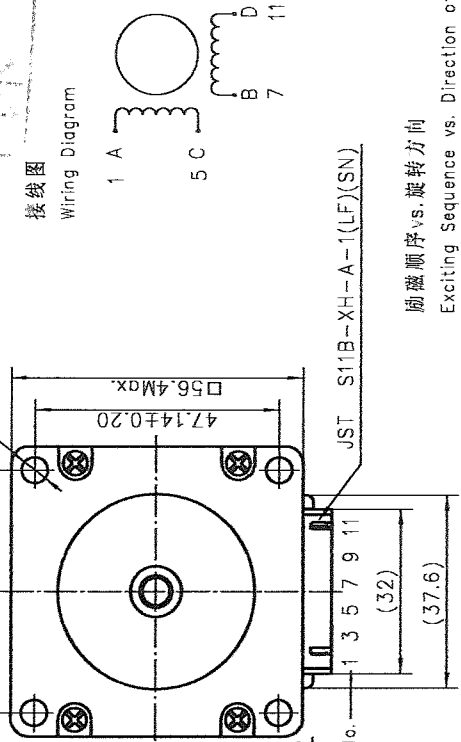

励磁顺序 vs. 旋转方向
Exciting Sequence vs. Direction of Rotation

STEP	A	B	C	D	ICCP
1	+	+	-	-	-
2	-	+	+	-	+
3	-	-	+	+	+
4	+	-	-	+	+

从安装面看为顺时针方向
Clockwise view from mounting side

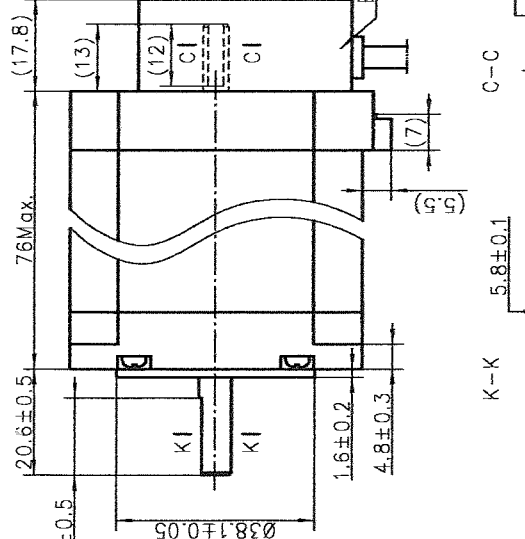
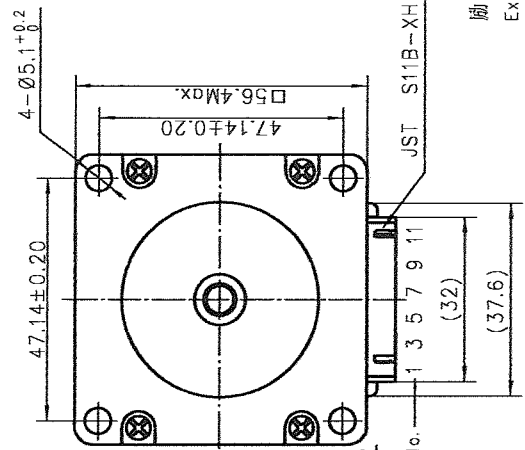

铭牌 Label Detail

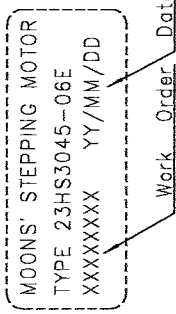

编码器 Encoder Detail

型号(Model): HS302CH14M100

Pin No.	1	2	3	4	5
COLOR	GRN(绿)	WHT(白)	YEL(黄)	RED(红)	BLK(黑)
SIGNAL	CHB	CHA	Z	Vcc	GND

规格 Specifications

1. 相数 Number of Phase	2
2. 步距角 Step Angle	1.8°
3. 额定电压 Rated Voltage	4.2 V DC
4. 额定电流 Rated Current	2.1 Amp
5. 保持力矩 Holding Torque	1.65 N.m Min. (Two phase on/rated current)
6. 相电阻 Phase Resistance	2.0 ohm ±10% (20°C)
7. 相电感 Phase Inductance	8.45 mH ±20% (1kHz 1V rms)
8. 转子惯量 Rotor Inertia	460g.cm ²
9. 电机重量 Motor Weight	1kg
10. 绝缘等级 Insulation Class	B(130°C)

REV.	版本记录 REVISION RECORD	DATE	UNLESS OTHERWISE SPECIFIED	4	5	6	8
A	原始版本 Original revision	2012.07.18	徐徐	2012.07.18	徐徐	2012.07.18	徐徐

MOONS'		Hybrid Stepping Motor	
Shanghai Moons' Electric Co., Ltd.			
This document is released for information only. Its reproduction in whole or in part or its dissemination to third parties is prohibited. All trademarks and registered trademarks appearing on this document are the property of their respective owners.			
Type: 23HS3045-06E	Rev.A	SCALE 1:1	Sheet 1 of 1

批准 Approve	标准化 Standard	工艺 Technology	审核 Check	设计 Design	NAME	SIGNATURE	DATE