

10		9		8		7		6		5		4		3		2		19070			
LOOSE PIECE				TAPE MOUNTED				SPECIFICATIONS													
MATERIAL NUMBER	ALTERNATE NUMBER	MATERIAL NUMBER	ALTERNATE NUMBER	STUD SIZE	"S" ±.005/(0.13)	"W" MAX.	"C" MIN.	"L" MAX.	"ID" MIN.	STOCK THICKNESS REFERENCE	"H" ±.020/-.051										
F	I90700005	AA-220-02X	I90700006	AA-220-02XT	2	.094/(2.39)	.235/(6.00)	.157/(3.99)	.709/(18.01)	.062/(1.57)	.028/(0.71)	.980/(24.89)									
	I90700007	AA-220-04X	I90700008	AA-220-04XT	4	.119/(3.02)															
	I90700009	AA-220-06X	I90700010	AA-220-06XT	6	.146/(3.71)															
	I90700011	AA-221-06X	I90700012	AA-221-06XT	6	.146/(3.71)	.322/(8.18)	.270/(6.86)	.866/(22.00)	.062/(1.57)	.028/(0.71)										
	I90700013	AA-221-08X	I90700014	AA-221-08XT	8	.173/(4.39)															
	I90700015	AA-221-10X	I90700017	AA-221-10XT	10	.198/(5.03)															
	I90700019	AA-221-209X	I90700020	AA-221-209XT	209	.209/(5.18)	.477/(12.11)	.386/(9.80)	1.060/(26.92)	.062/(1.57)	.028/(0.71)										
E	I90700021	AA-222-10X	I90700022	AA-222-10T	10	.198/(5.03)															
	I90700023	AA-222-14X	I90700024	AA-222-14XT	14	.265/(6.73)															
	I90700026	AA-222-56X	I90700027	AA-222-56XT	56	.328/(8.33)	.544/(13.82)	.552/(14.02)	1.259/(31.98)	.055/(1.40)	.031/(0.79)		1.172/(29.77)								
	I90700029	AA-226-10X	I90700030	AA-226-10XT	10	.198/(5.03)															
	I90700031	AA-226-14X	I90700032	AA-226-14XT	14	.265/(6.73)															
	I90700036	AA-226-56X	I90700037	AA-226-56XT	56	.328/(8.33)	.264/(6.70)	.240/(6.10)	.807/(20.50)	.062/(1.57)	.028/(0.71)	.980/(24.89)									
	I90700033	AA-226-38X	I90700035	AA-226-38XT	38	.390/(9.91)															
D	I90700038	AA-232-04X	I90700039	AA-232-04XT	4	.119/(3.02)															
	I90700040	AA-232-06X	I90700042	AA-232-06XT	6	.146/(3.71)	.283/(7.20)	.240/(6.10)	.816/(20.73)	.062/(1.57)	.028/(0.71)										
	I90700044	AA-232-08X	I90700045	AA-232-08XT	8	.173/(4.39)															
	I90700051	AA-233-10X	I90700052	AA-233-10XT	10	.198/(5.03)															
	I90700001	AA-2111-02X	I90700002	AA-2111-02XT	2	.094/(2.39)	.197/(5.00)	.173/(4.40)	.715/(18.16)	.055/(1.40)	.031/(0.79)										
	I90700003	AA-2111-04X	I90700004	AA-2111-04XT	4	.119/(3.02)															

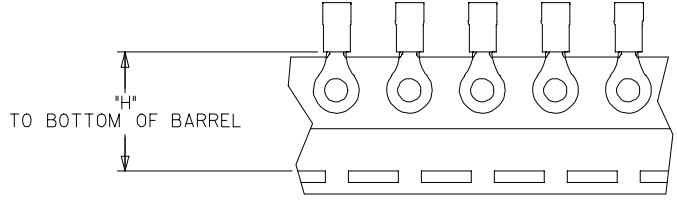
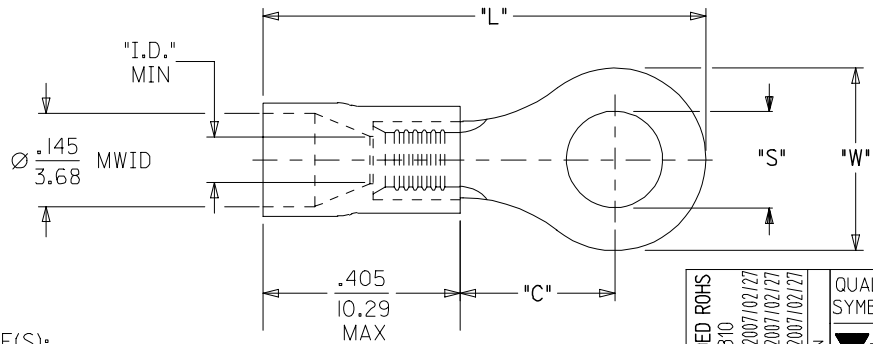

SALES DRAWING

- NOTE(S):
 1. MATERIAL: COPPER
 PLATING: ELECTROPLATE TIN
 2. FERRULE: TIN-PLATED BRASS
 3. INSULATION: RED MOLDED PVC
 4. MWID=MAXIMUM WIRE INSULATION DIA.
 5. ALL DIMENSIONS IN INCHES (MM).
 6. ASSEMBLY IS ROHS COMPLIANT.

173 WAS 146 & ADDED ROHS EC NO: ETC2007-0310 DR: WNEHLE 2007/02/27 CHKD: JMACNEIL 2007/02/27 APPR: JMACNEIL 2007/02/27	QUALITY SYMBOLS ▽=0 ▽=0	GENERAL TOLERANCES (UNLESS SPECIFIED)	DIMENSION STYLE IN/MM	SCALE ---	DESIGN UNITS INCH	THIRD ANGLE PROJECTION
	DESCRIPTION	mm INCH	DRAWN BY DATE DMYRICK 2005/7/22	TITLE RING TONGUE TERMINAL KRIMP TITE, 200-SERIES 22-18 AWG	MOLEX INCORPORATED	
REV	DRAFT WHERE APPLICABLE MUST REMAIN WITHIN DIMENSIONS	ANGULAR ±---°	CHECKED BY DATE HBEITZEL 2005/7/22	APPROVED BY DATE RDEROSS 2005/7/22	MATERIAL NO. SEE CHART	DOCUMENT NO. SD-19070-003
			SIZE B	THIS DRAWING CONTAINS INFORMATION THAT IS PROPRIETARY TO MOLEX INCORPORATED AND SHOULD NOT BE USED WITHOUT WRITTEN PERMISSION		