

部番 No.	部品名 PARTS NAME	材質 MATERIAL	記事 ARTICLE
①	ハウジング HOUSING	ガラス入り耐熱樹脂 G.F. HEAT RESISTANT PLASTIC	UL94V-0, 色:黒 UL94V-0, COLOR: BLACK
②	ピン PIN	黄銅 t0.25 BRASS t0.25	接点部 : 金メッキ0.76μmMIN. CONTACT AREA : GOLD 0.76μmMIN. 半田付け部 : 錫メッキ1μmMIN. SOLDERTAIL AREA : TIN 1μmMIN. 下地メッキ : ニッケルメッキ2μmMIN. UNDER-PLATING : NICKEL 2μmMIN.
③	シェル SHELL	りん青銅 t0.4 PHOSPHOR BRONZE t0.4	錫メッキ: 1.0μmMIN.* TIN : 1.0 μmMIN. 下地メッキ : ニッケルメッキ1.27μmMIN.* UNDER-PLATING : NICKEL 1.27 μmMIN.

※半田付け部のみ。
ONLY SOLDERING PART.

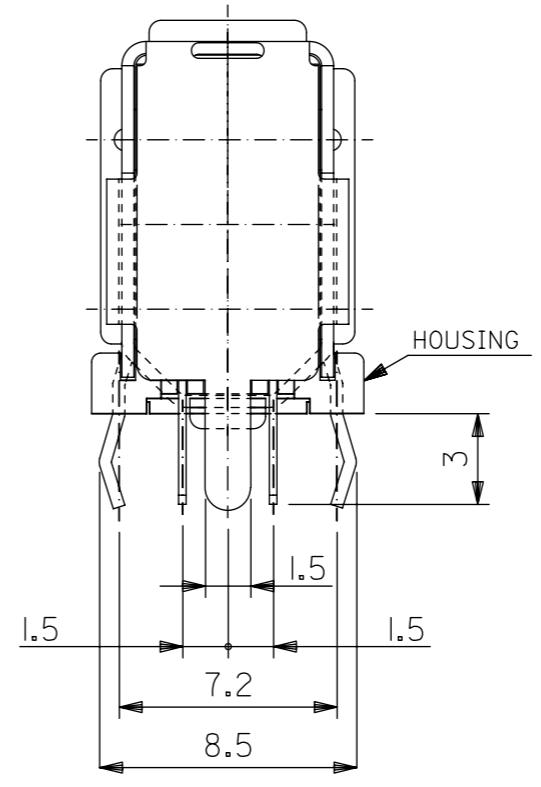

注記:
NOTES:
1. 本製品は53460-0629のリフロータイプ対応品である。
THIS PRODUCT IS REFLOW DIP VERSION OF 53460-0629.

6	53460-0639	53460-**39
CKT	MATERIAL NO.	MODEL NO.

SYMBOLS ▽ = 0 ▽ = 0 ▽ = 0 ▽ = 0 ▽ = 0 ▽ = 0 □ = 0 ■ = 0 ▽ = 0	THIS DRAWING CONTAINS INFORMATION THAT IS PROPRIETARY TO MOLEX ELECTRONIC TECHNOLOGIES, LLC AND SHOULD NOT BE USED WITHOUT WRITTEN PERMISSION. DIMENSION UNITS: mm SCALE: 4:1 GENERAL TOLERANCES (UNLESS SPECIFIED): ANGULAR TOL ± 3.0° 4 PLACES ± 0.2 3 PLACES ± 0.2 2 PLACES ± 0.2 1 PLACE ± 0.2 0 PLACES ± 0.2 DRAFT WHERE APPLICABLE MUST REMAIN WITHIN DIMENSIONS	CURRENT REV DESC: EC NO: 173518 DRWN: RYANAIDANI 2018/03/09 CHK'D: ASHIMOTSU 2018/03/13 APPR: RTAKEUCHI 2018/03/15 INITIAL REVISION: DRWN: KTAKEUCHI01 2016/12/13 APPR: RTAKEUCHI 2018/03/15	molex 2.0 I/O CONN. SOCKET RIGHT-ANGLE UPRIGHT WITH KINK -LEAD FREE- PRODUCT CUSTOMER DRAWING
	DOCUMENT NUMBER: 534600000 DOC TYPE: PSD DOC PART: 001 REVISION: A	MATERIAL NUMBER: 53460 CUSTOMER:	SHEET NUMBER: 1 OF 3

リフローDip用基板
PCB FOR REFLOW DIP

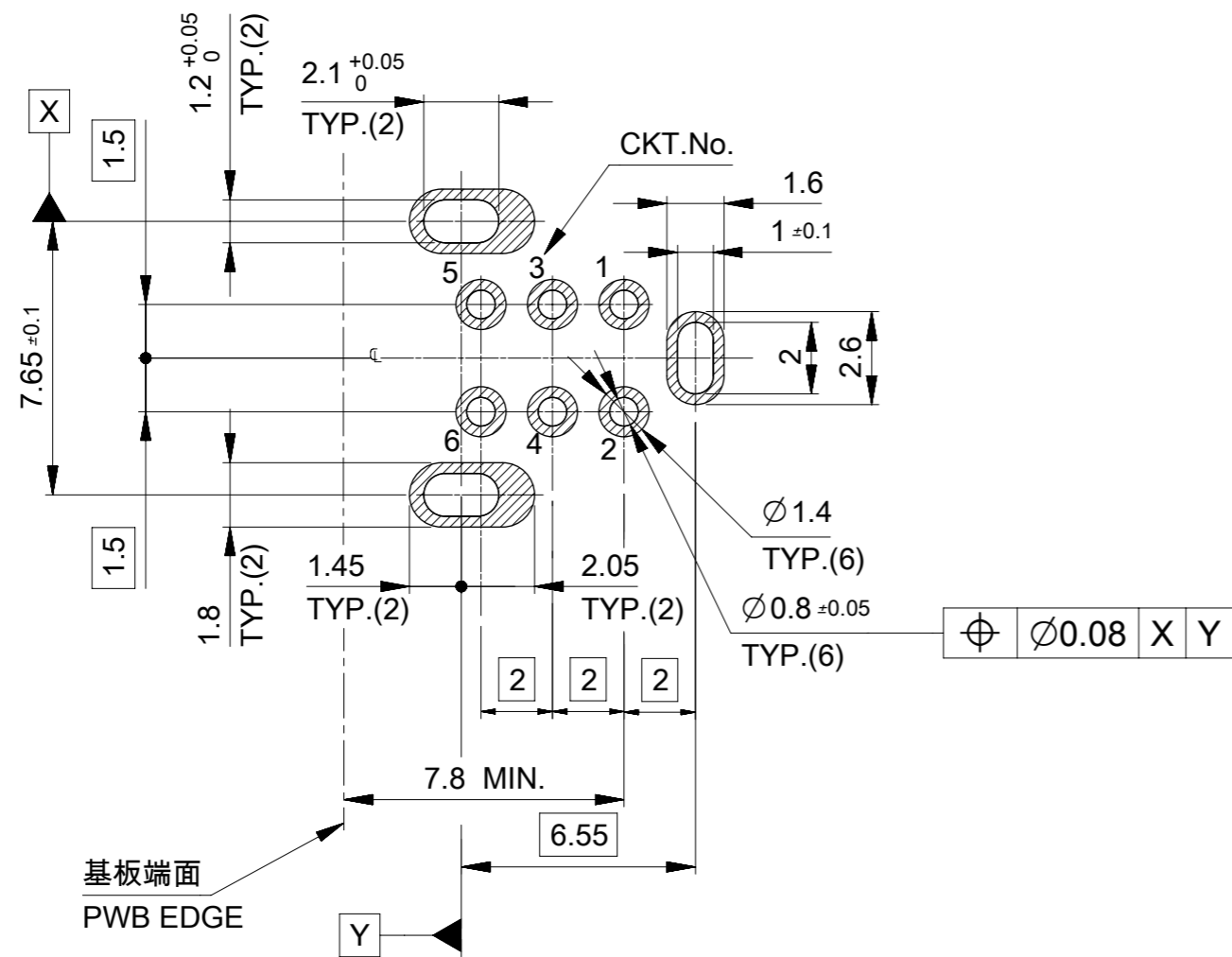

基板推奨寸法(基板厚t=1.6)
(COMPONENT SIDE)

RECOMMENDED PCB PATTERN LAYOUT
(PCB THICKNESS t=1.6±0.2)

通常Dip用基板
PCB FOR DIP

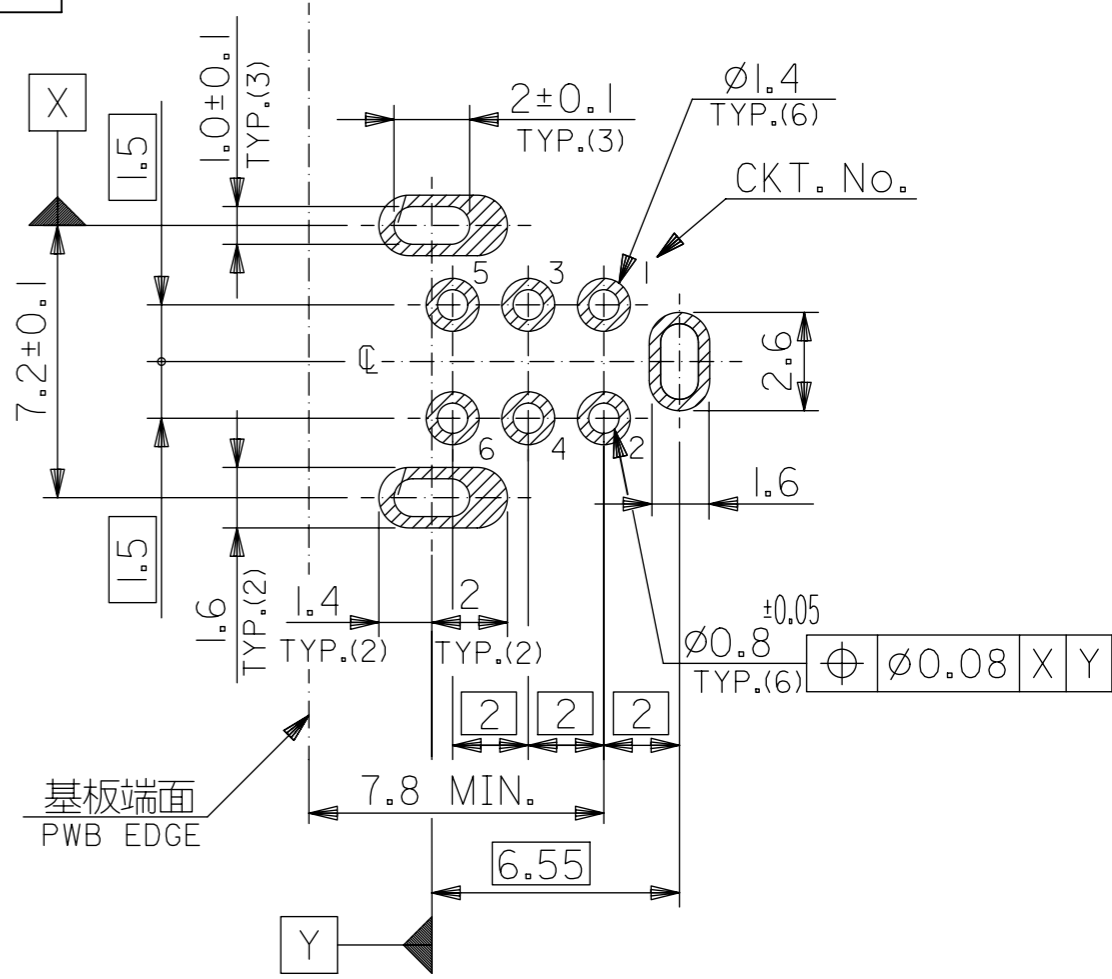

P.C. BOARD HOLE DIM. (t=1.6)
(COMPONENT SIDE)

SYMBOLS	THIS DRAWING CONTAINS INFORMATION THAT IS PROPRIETARY TO MOLEX ELECTRONIC TECHNOLOGIES, LLC AND SHOULD NOT BE USED WITHOUT WRITTEN PERMISSION		CURRENT REV DESC:			molex		
	▽ = 0	mm						
▽ = 0	GENERAL TOLERANCES (UNLESS SPECIFIED)		EC NO: 173518			2.0 I/O CONN. SOCKET		
▽ = 0	ANGULAR TOL ± 3.0°		DRWN: RYANAIDANI 2018/03/09			RIGHT-ANGLE UPRIGHT WITH KINK -LEAD FREE-		
▽ = 0	4 PLACES ± 0.2		CHK'D: ASHIMOTSU 2018/03/13			PRODUCT CUSTOMER DRAWING		
▽ = 0	3 PLACES ± 0.2		APPR: RTAKEUCHI 2018/03/15			DOCUMENT NUMBER		
▽ = 0	2 PLACES ± 0.2		INITIAL REVISION:			534600000		
▽ = 0	1 PLACE ± 0.2		DRWN: KTAKEUCHI01 2016/12/13			DOC TYPE		
▽ = 0	0 PLACES ± 0.2		APPR: RTAKEUCHI 2018/03/15			PSD		
□ = 0	DRAFT WHERE APPLICABLE MUST REMAIN WITHIN DIMENSIONS		THIRD ANGLE PROJECTION			DOC PART		
□ = 0			DRAWING			001		
□ = 0			SERIES			REVISION		
□ = 0			A3-SIZE			A		
□ = 0			53460			SHEET NUMBER		
□ = 0						2 OF 3		

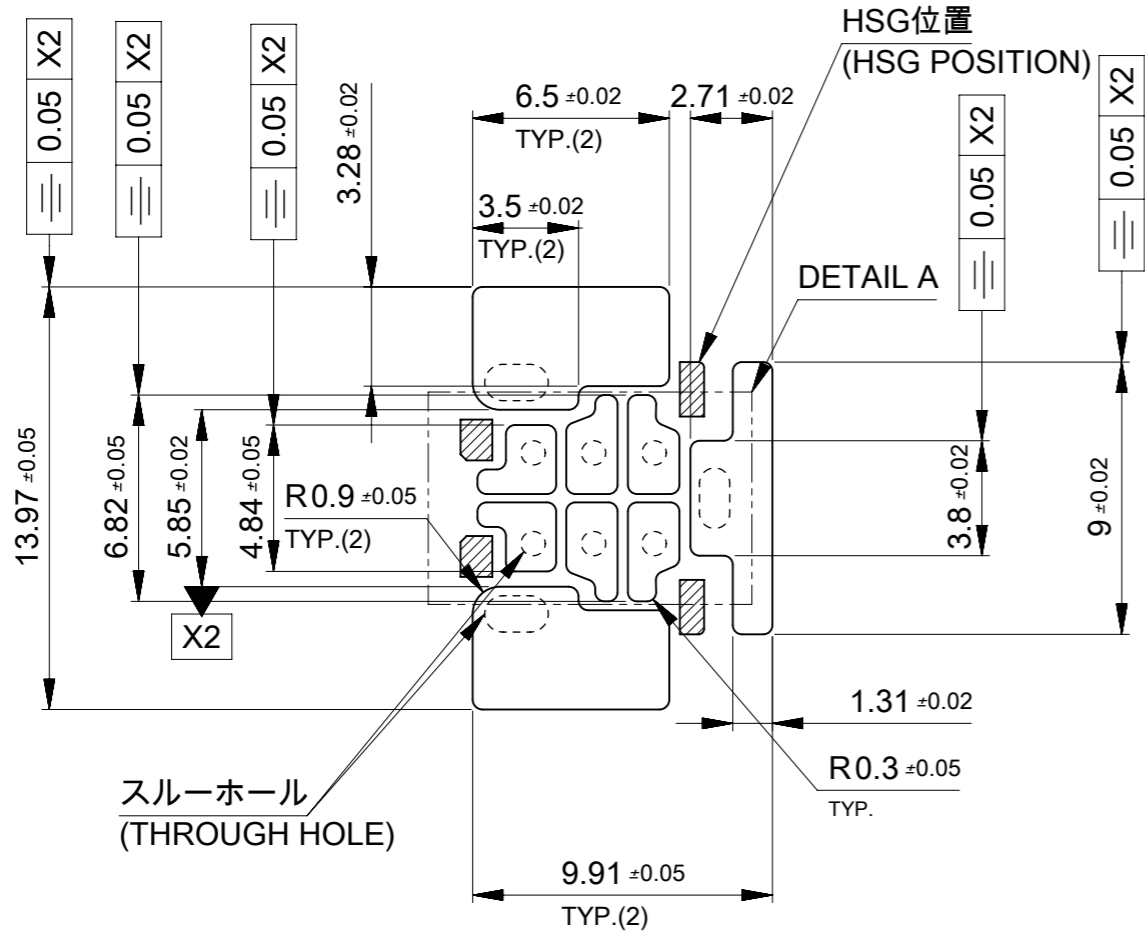

メタルマスク推奨寸法
(メタルマスク厚t=0.15)
(COMPONENT SIDE)

RECOMMENDED METALMASK LAYOUT
(METAL MASK THICKNESS t=0.15)

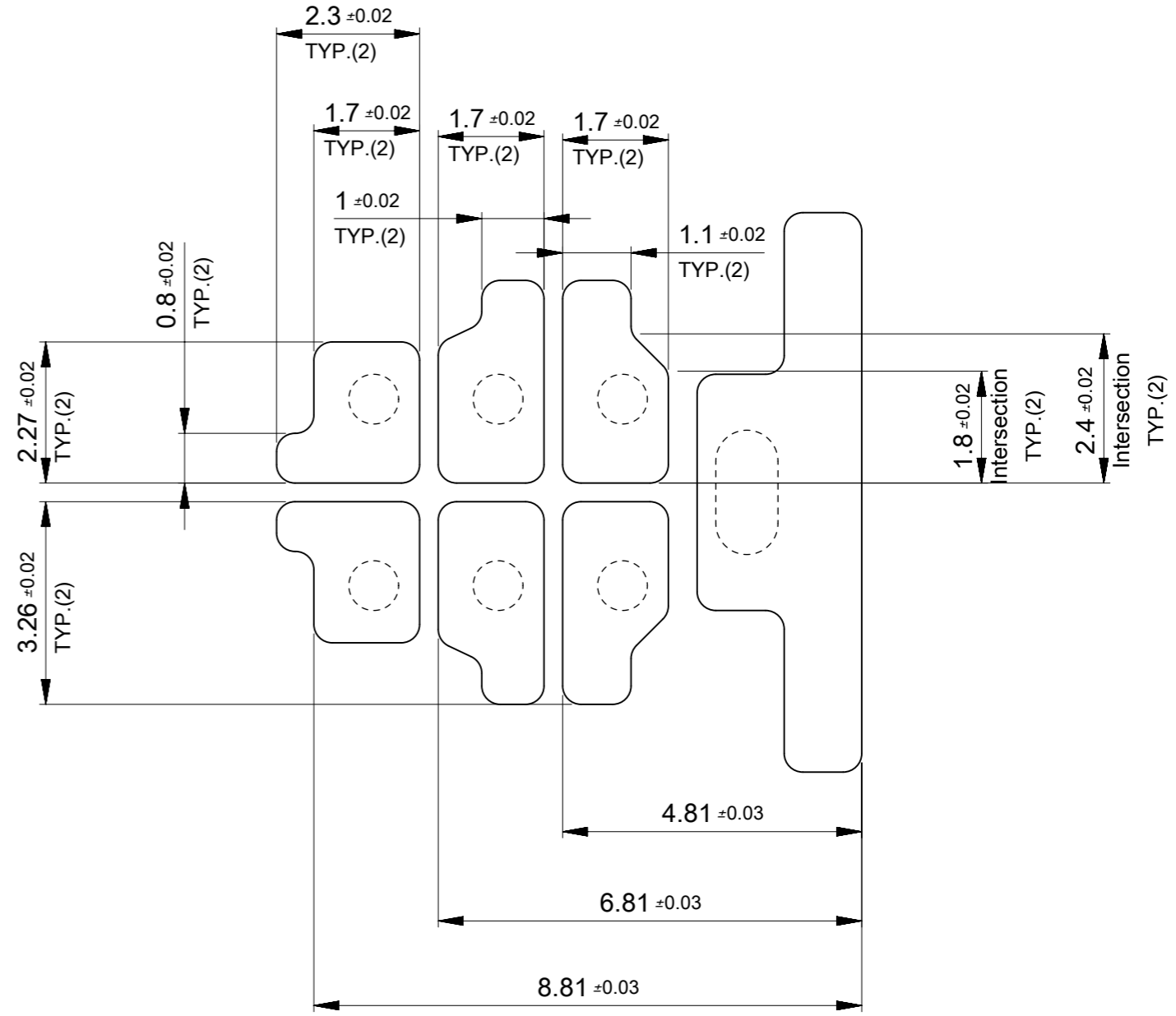

DETAIL A
SCALE 10:1

SYMBOLS ▽ = 0 ▽ = 0 ▽ = 0 ▽ = 0 ▽ = 0 ▽ = 0 ▽ = 0 ▽ = 0 ▽ = 0 ▽ = 0 ▽ = 0	THIS DRAWING CONTAINS INFORMATION THAT IS PROPRIETARY TO MOLEX ELECTRONIC TECHNOLOGIES, LLC AND SHOULD NOT BE USED WITHOUT WRITTEN PERMISSION	CURRENT REV DESC:					
	DIMENSION UNITS: mm	SCALE: 5:1	EC NO: 173518				2.0 I/O CONN. SOCKET RIGHT-ANGLE UPRIGHT WITH KINK -LEAD FREE-
	GENERAL TOLERANCES (UNLESS SPECIFIED)		DRWN: RYANAIDANI 2018/03/09		DOCUMENT NUMBER: 534600000		
	ANGULAR TOL ± 3.0°		CHK'D: ASHIMOTSU 2018/03/13		DOC TYPE: PSD		
	4 PLACES ± 0.2		APPR: RTAKEUCHI 2018/03/15		DOC PART: 001		
3 PLACES ± 0.2		INITIAL REVISION:		REVISION: A			
2 PLACES ± 0.2		DRWN: KTAKEUCHI01 2016/12/13		SHEET NUMBER: 3 OF 3			
1 PLACE ± 0.2		APPR: RTAKEUCHI 2018/03/15		MATERIAL NUMBER: 53460			
0 PLACES ± 0.2		DRAFT WHERE APPLICABLE MUST REMAIN WITHIN DIMENSIONS		CUSTOMER: A3-SIZE			
THIRD ANGLE PROJECTION		DRAWING: A3-SIZE		SERIES: 53460			