

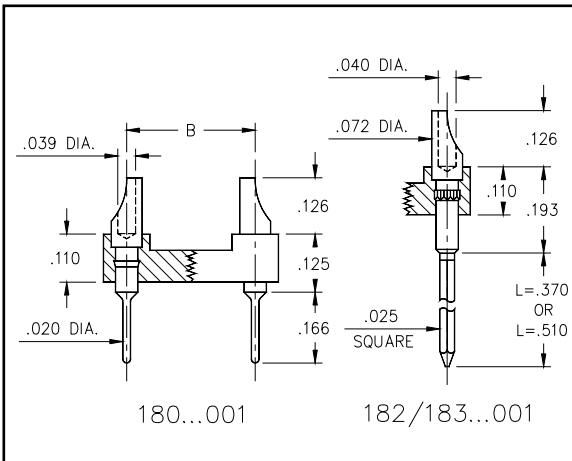

Solder Tail and Wrapost
Open Frame

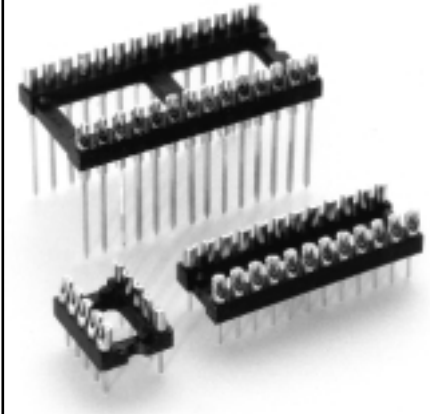

- Series 180, 182, 183 DIL Headers are equipped with solder cups for wiring applications.
- Terminations are pluggable .020" diameter solder tails (M-M# 8000), see page 174 for details; or 2 & 3-level wrapposts, (M-M# 8301) see page 184 for details.



Total number of pins				Quantity per tube	Ordering Information		
	A	B	C		Solder Tail	2 Level Wrapost L = .370	3 Level Wrapost L = .510
	10	0.5	0.2		0.3	41	180-XX-210-00-001
4	0.2	0.3	0.4	102	180-XX-304-00-001	182-XX-304-00-001	183-XX-304-00-001
6	0.3	0.3	0.4	67	180-XX-306-00-001	182-XX-306-00-001	183-XX-306-00-001
8	0.4	0.3	0.4	50	180-XX-308-00-001	182-XX-308-00-001	183-XX-308-00-001
10	0.5	0.3	0.4	40	180-XX-310-00-001	182-XX-310-00-001	183-XX-310-00-001
14	0.7	0.3	0.4	28	180-XX-314-00-001	182-XX-314-00-001	183-XX-314-00-001
16	0.8	0.3	0.4	25	180-XX-316-00-001	182-XX-316-00-001	183-XX-316-00-001
18	0.9	0.3	0.4	22	180-XX-318-00-001	182-XX-318-00-001	183-XX-318-00-001
20	1.0	0.3	0.4	20	180-XX-320-00-001	182-XX-320-00-001	183-XX-320-00-001
22	1.1	0.3	0.4	18	180-XX-322-00-001	182-XX-322-00-001	183-XX-322-00-001
24	1.2	0.3	0.4	16	180-XX-324-00-001	182-XX-324-00-001	183-XX-324-00-001
28	1.4	0.3	0.4	14	180-XX-328-00-001	182-XX-328-00-001	183-XX-328-00-001
20	1.0	0.4	0.5	20	180-XX-420-00-001	182-XX-420-00-001	183-XX-420-00-001
22	1.1	0.4	0.5	18	180-XX-422-00-001	182-XX-422-00-001	183-XX-422-00-001
24	1.2	0.4	0.5	16	180-XX-424-00-001	182-XX-424-00-001	183-XX-424-00-001
28	1.4	0.4	0.5	14	180-XX-428-00-001	182-XX-428-00-001	183-XX-428-00-001
32	1.6	0.4	0.5	12	180-XX-432-00-001	182-XX-432-00-001	183-XX-432-00-001
24	1.2	0.6	0.7	16	180-XX-624-00-001	182-XX-624-00-001	183-XX-624-00-001
28	1.4	0.6	0.7	14	180-XX-628-00-001	182-XX-628-00-001	183-XX-628-00-001
32	1.6	0.6	0.7	12	180-XX-632-00-001	182-XX-632-00-001	183-XX-632-00-001
36	1.8	0.6	0.7	11	180-XX-636-00-001	182-XX-636-00-001	183-XX-636-00-001
40	2.0	0.6	0.7	10	180-XX-640-00-001	182-XX-640-00-001	183-XX-640-00-001
42	2.1	0.6	0.7	9	180-XX-642-00-001	182-XX-642-00-001	183-XX-642-00-001
48	2.4	0.6	0.7	8	180-XX-648-00-001	182-XX-648-00-001	183-XX-648-00-001
50	2.5	0.6	0.7	8	180-XX-650-00-001	182-XX-650-00-001	183-XX-650-00-001
52	2.6	0.6	0.7	7	180-XX-652-00-001	182-XX-652-00-001	183-XX-652-00-001
50	2.5	0.9	1.0	8	180-XX-950-00-001	182-XX-950-00-001	183-XX-950-00-001
52	2.6	0.9	1.0	7	180-XX-952-00-001	182-XX-952-00-001	183-XX-952-00-001
64	3.2	0.9	1.0	6	180-XX-964-00-001	182-XX-964-00-001	183-XX-964-00-001
SPECIFY PLATING CODE XX=					10	90	
Pin Plating					10μ" Au	200μ" Sn/Pb	