

# Data Sheet

## 360271

Page 1/4

P/N

360271

2017/01/24

### Illustration

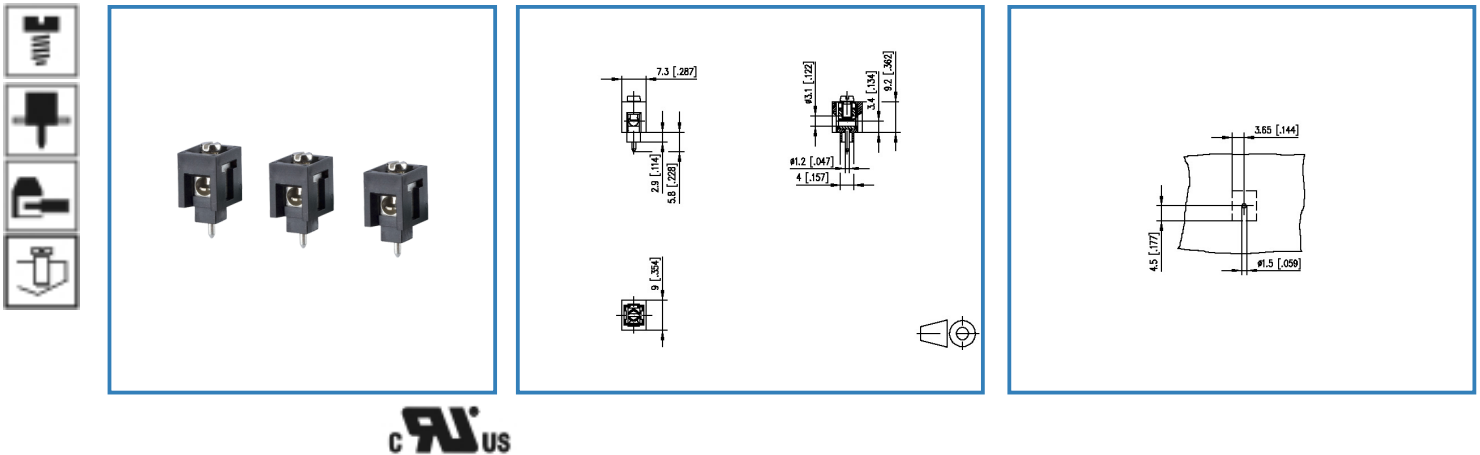

see enlarged drawing at the end of the document

### Product specification

- screw type terminal block, solderable
- direction of connection 90°
- wire protector
- color black
- with molded housing, single solder pin, screw brought down by hand (transport safety)

# Data Sheet

## 360271

Page 2/4

P/N

360271

2017/01/24

### Technical Data

#### General Data

Tightening torque SEV	0.5 Nm
Tightening torque UL	7 lb-in
Solder pin length	2.9 mm
min. number of poles	1
max. number of poles	1
Insulating material class	CTI 600

#### Connection data

Rated wiring solid wire	0.33 - 2 mm <sup>2</sup> / AWG 22 - 14
Rated wiring stranded wire	0.33 - 1.5 mm <sup>2</sup> / AWG 22 - 14

#### Approvals

 V / A / AWG	50 / 15 / 24 - 14
------------------------------------------------------------------------------------------------	-------------------

#### Material

terminal body material	CuZn
terminal body surface	Ni + Sn
screw surface	Zn Cr(VI)-frei/free
wire protector material	CuNi18
screw thread	M3

#### Climatic properties

upper limit temperature	105 °C
lower limit temperature	-40 °C

#### General

solderability	Acc. to JEDEC JESD22-B102E 245°C/5s
Tolerance	ISO 2768 -mH

# Data Sheet

## 360271

Page 3/4

P/N

360271

2017/01/24

### Illustration

Drawing

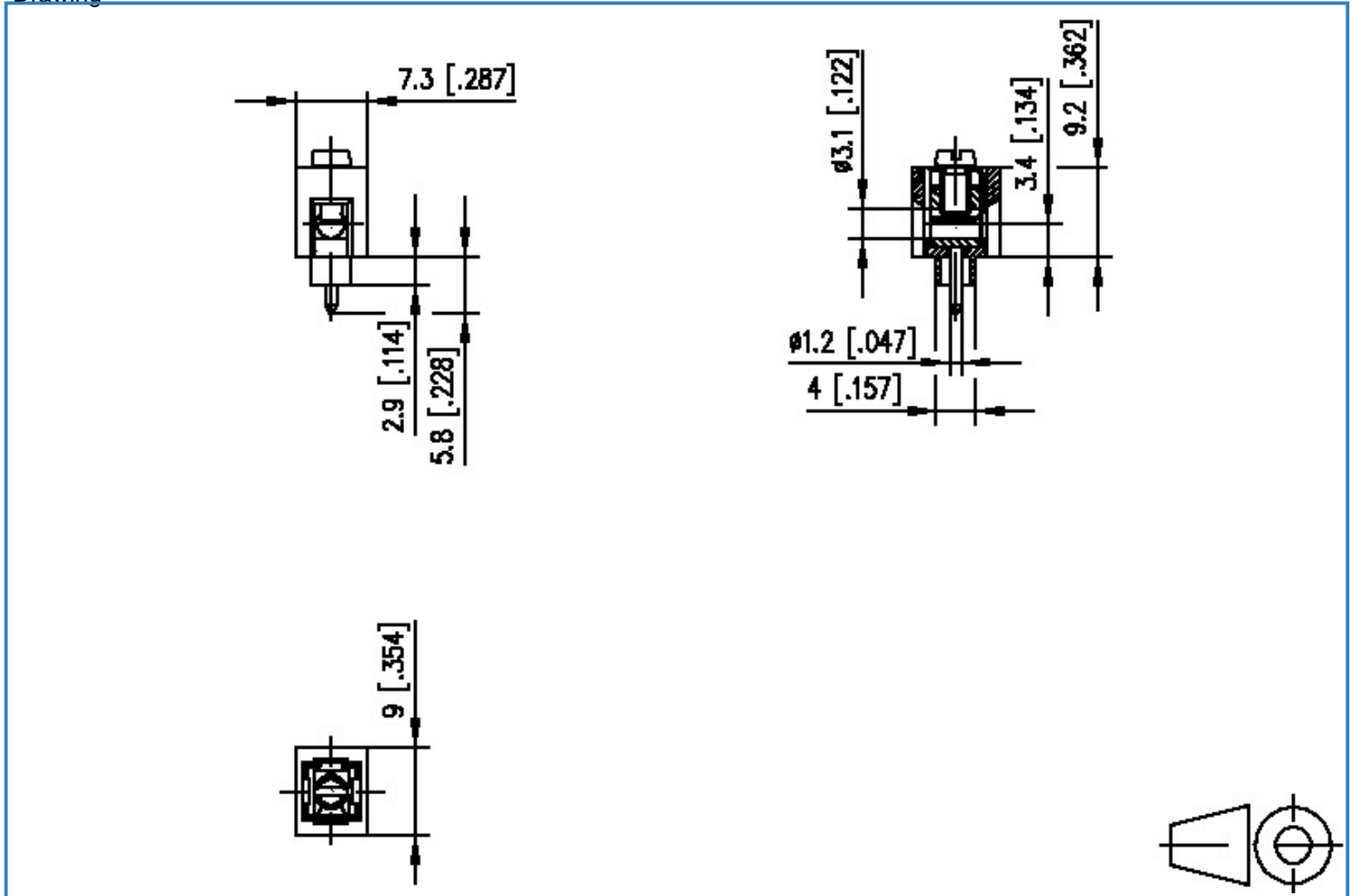

# Data Sheet

## 360271

Page 4/4

P/N

360271

2017/01/24

PCB Layout

