

SUMMARY

Wires

Low voltage 65



Image is for illustrative purpose only

Series 1R
Termination type Female crimp
IP rating 50
AWG wire size 32.00 - 28.00
Cable Ø 2.00 - 9.20 mm
Status active
Matching parts [FGG.1R.365.GLC92](#)

Download

[Request a quote](#)

[Catalog](#)

TECHNICAL DETAILS

Mechanics

Shell Style/Model EBG*: Fixed receptacle, key (G) or key (A) with visible shell
Keying 3 keys (alpha=50,beta=30, plug: male contacts, receptacle: female contacts)
Housing Material Crastin® PBT (Polybutylene terephthalate), grey
Weight 16.86 g

Performance

Configuration 1R.365 : 65 low voltage
Insulator L: PEEK (UL 94 / V-0/1.5)
Rated Current 0.5 Amps

Specifications

Contact Type: Crimp
Test voltage (kV rms) Contact-contact: 0.6

Others

LEMO products and services are provided "as is". LEMO makes no warranties or representations with regard to LEMO product & services or use of them, express, implied or statutory, including for accuracy, completeness, or security. The user is fully responsible for his products and applications using LEMO components.

DRAWINGS

Draws

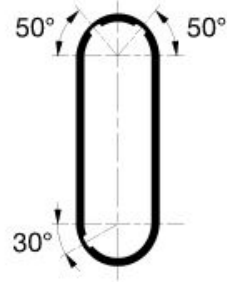
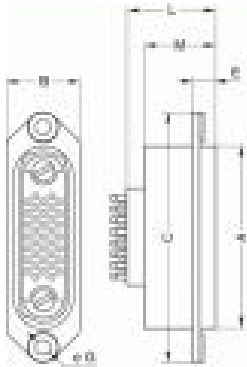

Dimensions

| | A | B | L | M |
|-----|------|------|------|------|
| mm. | 24.5 | 9 | 30.5 | 23.5 |
| in. | 0.96 | 0.35 | 1.20 | 0.93 |

RECOMMENDED BY LEMO

Tools

- Crimp Tool: [DPC.91.701.V](#)
Crimp settings: AWG/Selector = 28-30-32/4-3-3
Positionner: [DCE.91.051.BVM](#)
Extractor: [DCF.91.050.2LT](#)
Replacement contact: EGG.00.654.ZZM

Cables

LEMO products and services are provided "as is". LEMO makes no warranties or representations with regard to LEMO product & services or use of them, express, implied or statutory, including for accuracy, completeness, or security. The user is fully responsible for his products and applications using LEMO components.