

P.C.B. LAYOUT

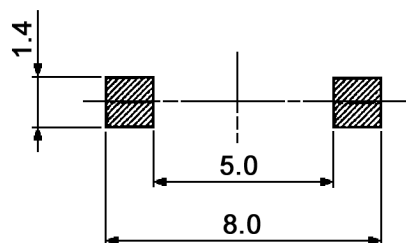

CIRCUIT DIAGRAM

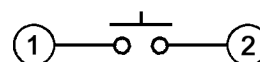

Specifications:

Contact rating:	min. 20mV, max. 32V DC
Switching current:	min. 1mA, max. 50mA
Switching power:	max. 1VA
Contact resistance:	100mOhm max.
Insulation resistance:	100MOhm min. at 100V DC for 1 minute
Dielectric strength:	100V AC for 1 minute (50/60Hz, 2mA)
Operating temperature:	-20°C to +70°C
Operating force:	300gf +150/-50gf
Actuator strength:	30N for 1 minute
Mechanical life:	100 000 cycles
Soldering heat resistance:	reflow soldering: 240°C +/-5°C, 5sec. max.
Packaging:	2500 pcs./reel
Material:	Terminal: C5191R-EH, Ag Case: PA46, black Contact plate: SUS, Ag Cover: SUS, washing Stem: PA46, natural

Compliance: RohS II (2011/65/EU)

Tolerances:	Date	Name
		04/06
Specifications	10/14	dr
Actuator strength	05/08	dr
Modifications	Date	Name

TSS 309 S

30 08 60

Page

1/1

knitter-switch