

P.C.B. LAYOUT

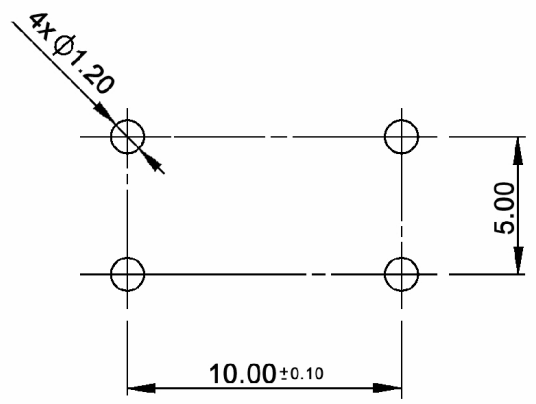

Specifications:

- Contact rating: 100mA, 42V DC/AC max.
(0.01mA, 0.02V DC/AC min.)
- Switching power: 1W max.
- Contact resistance: 100mOhm max.
- Insulation resistance: 1 000MOhm
- Dielectric strength: 150V AC (50Hz)
- Operating temperature: -40°C to +80°C
- Mechanical life: 1 000 000 cycles
- Operating force: 3.6 +/-0.7N
- Stop strength: 100N
- Travel: 0.61 +/-0.1mm
- Bounce: 5ms max.
- Packaging unit: 45 pcs. / stick
- Material: All plastic material UL94HB
Contact: stainless steel, gold plated over nickel
Terminal: brass, tin over nickel

CIRCUIT DIAGRAM

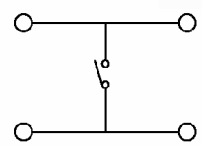

| | | | |
|----------------|---------------|-------|-----------------------|
| Tolerances: | <10: ±0.2mm | Date | Name |
| | 10-30: ±0.3mm | 11/08 | dr |
| | | | |
| | | | |
| | | | |
| Specifications | 07/11 | dr | knitter-switch |
| Plating | 01/11 | dr | |
| Modifications | Date | Name | |

TSE 12 S-1

30 16 55