

**Features**

- Reduced RFI and EMI
- Reduced Snubbing
- Extensive Characterization of Recovery Parameters
- Hermetic

$V_R = 200V$
$I_{F(AV)} = 50A$
$t_{rr} = 35ns$

**Description**

These Ultrafast, soft recovery diodes are optimized to reduce losses and EMI/RFI in high frequency power conditioning systems. An extensive characterization of the recovery behavior for different values of current, temperature and di/dt simplifies the calculations of losses in the operating conditions. The softness of the recovery eliminates the need for a snubber in most applications. These devices are ideally suited for power converters, motors drives and other applications where switching losses are significant portion of the total losses.

**Absolute Maximum Ratings**

	Parameter	Max.	Units
$V_R$	Cathode to Anode Voltage ( Per Leg )	200	V
$I_{F(AV)}$	Continuous Forward Current, ① $T_C = 107^\circ C$	50	A
$I_{FSM}$	Single Pulse Forward Current, ② $T_C = 25^\circ C$ ( Per Leg )	300	
$P_D @ T_C = 25^\circ C$	Maximum Power Dissipation	130	W
$T_J, T_{STG}$	Operating Junction and Storage Temperature Range	-55 to +150	$^\circ C$

**Note:** ① D.C. = 50% rect. wave  
 ② 1/2 sine wave, 60 Hz , P.W. = 8.33 ms

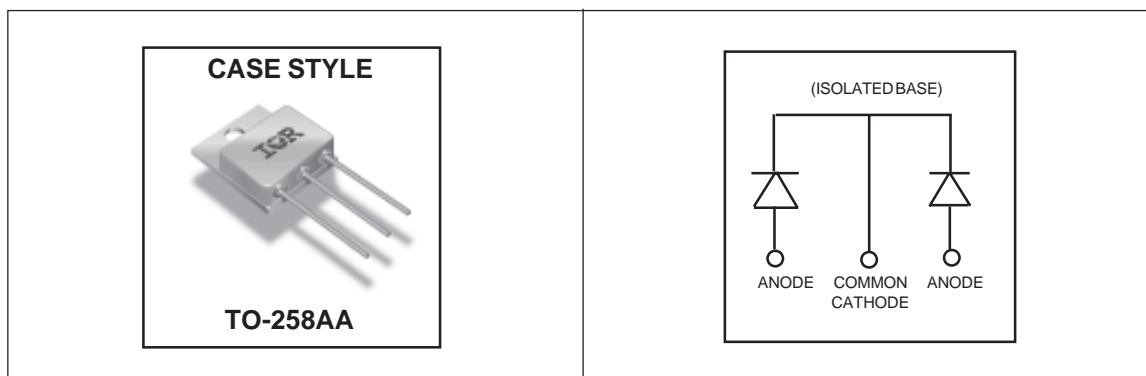

**Electrical Characteristics ( Per Leg )@ T<sub>J</sub> = 25°C (unless otherwise specified)**

	Parameter	Min.	Typ.	Max.	Units	Test Conditions
V <sub>BR</sub>	Cathode Anode Breakdown Voltage	200	—	—	V	I <sub>R</sub> = 100μA
V <sub>F</sub>	Forward Voltage See Fig. 1	—	—	1.36	V	I <sub>F</sub> = 25A, T <sub>J</sub> = -55°C
		—	—	1.20		I <sub>F</sub> = 25A, T <sub>J</sub> = 25°C
		—	—	1.49		I <sub>F</sub> = 50A, T <sub>J</sub> = 25°C
		—	—	0.99		I <sub>F</sub> = 25A, T <sub>J</sub> = 125°C
I <sub>R</sub>	Reverse Leakage Current See Fig. 2	—	—	10	μA	V <sub>R</sub> = V <sub>R</sub> Rated
		—	—	100	μA	V <sub>R</sub> = V <sub>R</sub> Rated, T <sub>J</sub> = 125°C
C <sub>T</sub>	Junction Capacitance, See Fig. 3	—	—	200	pF	V <sub>R</sub> = 200V
L <sub>S</sub>	Series Inductance	—	8.7	—	nH	Measured from anode lead to cathode lead , 6mm ( 0.025 in) from package

**Dynamic Recovery Characteristics ( Per Leg ) @ T<sub>J</sub> = 25°C (unless otherwise specified)**

	Parameter	Min.	Typ.	Max.	Units	Test Conditions
t <sub>rr</sub>	Reverse Recovery Time	—	—	35	ns	I <sub>F</sub> = 0.5A, V <sub>R</sub> = 30V, di/dt = 300A/μs
t <sub>rr1</sub>	Reverse Recovery Time	—	46	—	ns	T <sub>J</sub> = 25°C See Fig.
t <sub>rr2</sub>		—	84	—		T <sub>J</sub> = 125°C 5
I <sub>R</sub> RM1	Peak Recovery Current	—	5.7	—	A	T <sub>J</sub> = 25°C See Fig.
I <sub>R</sub> RM2		—	12.5	—		T <sub>J</sub> = 125°C 6
Q <sub>rr1</sub>	Reverse Recovery Charge	—	150	—	nC	T <sub>J</sub> = 25°C See Fig.
Q <sub>rr2</sub>		—	595	—		T <sub>J</sub> = 125°C 7
di <sub>(rec)M</sub> /dt1	Peak Rate of Fall of Recovery Current During t <sub>b</sub>	—	530	—	A/μs	T <sub>J</sub> = 25°C See Fig.
di <sub>(rec)M</sub> /dt2		—	1130	—		T <sub>J</sub> = 125°C 8

**Thermal - Mechanical Characteristics**

	Parameter	Typ.	Max.	Units
R <sub>thJC</sub>	Junction-to-Case, Single Leg Conducting	—	0.96	°C/W
Wt	Weight	10.9	—	g

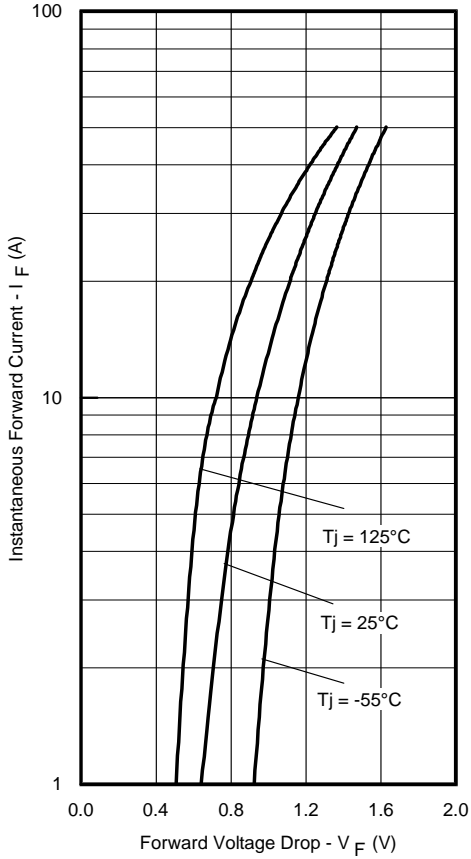

**Fig. 1** - Maximum Forward Voltage Drop Vs. Instantaneous Forward Current ( Per Leg )

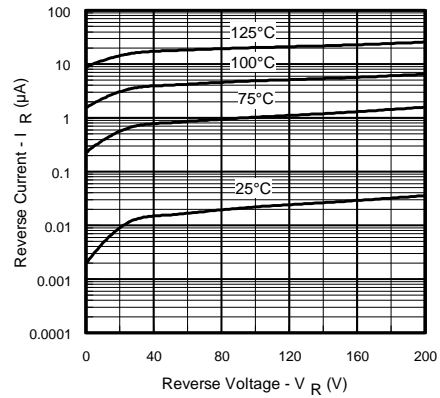

**Fig. 2** - Typical Reverse Current Vs. Reverse Voltage ( Per Leg )

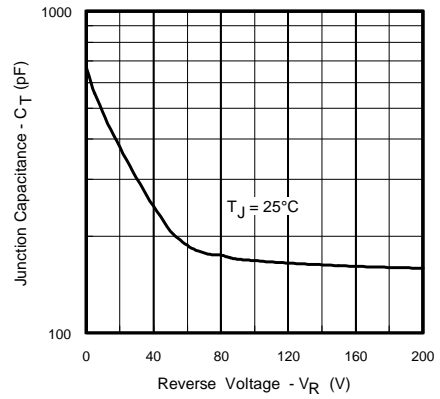

**Fig. 3** - Typical Junction Capacitance Vs. Reverse Voltage ( Per Leg )

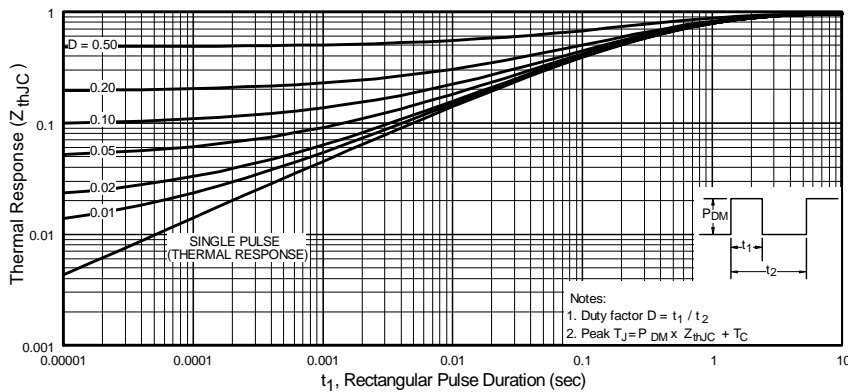

**Fig. 4** - Maximum Thermal Impedance  $Z_{thjc}$  Characteristics ( Per Leg )

# HFB50HC20C

International  
**IRF** Rectifier

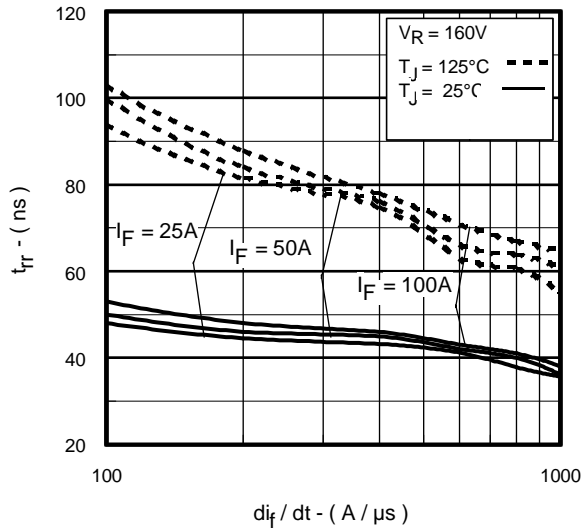

Fig. 5 - Typical Reverse Recovery Vs.  $di_f/dt$  (Per Leg)

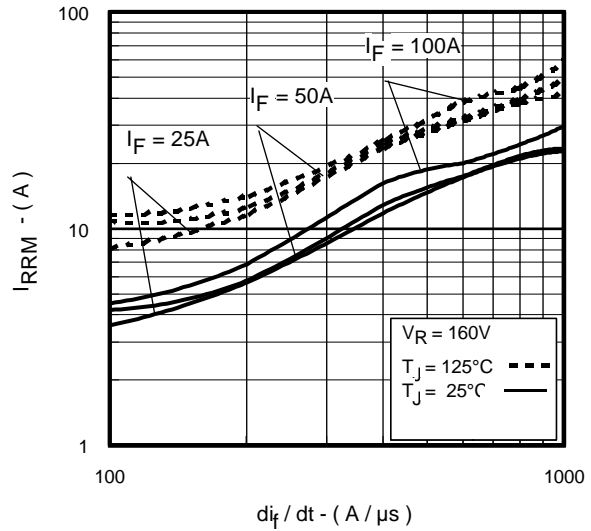

Fig. 6 - Typical Recovery Current Vs.  $di_f/dt$  (Per Leg)

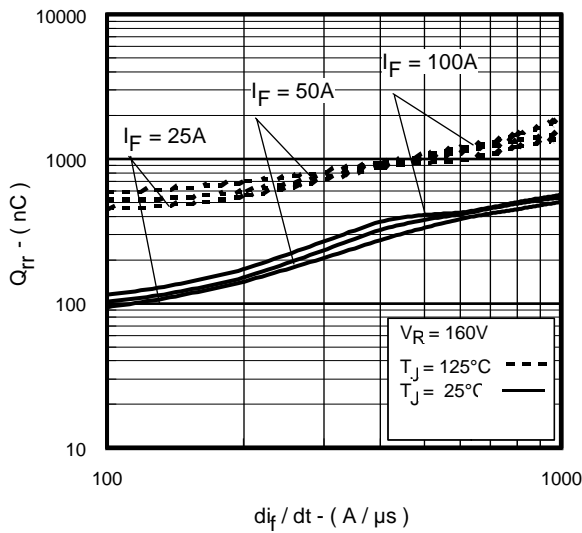

Fig. 7 - Typical Stored Charge Vs.  $di_f/dt$  (Per Leg)

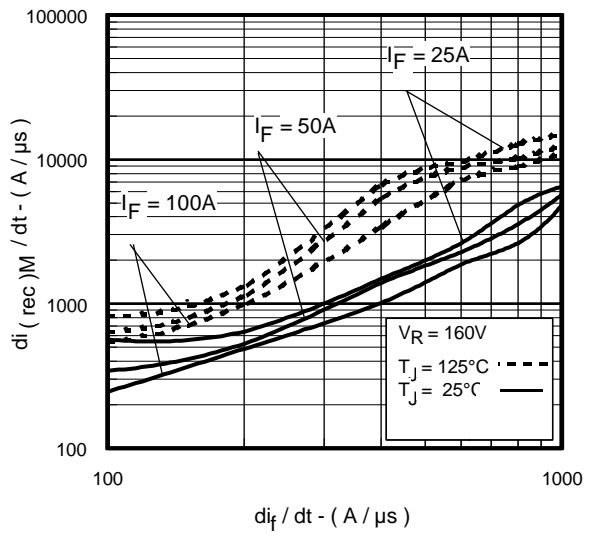

Fig. 8 - Typical  $di_{(rec)M}/dt$  Vs.  $di_f/dt$  (Per Leg)

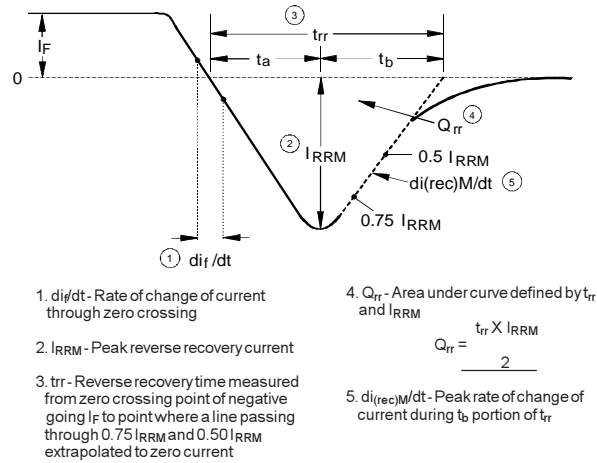
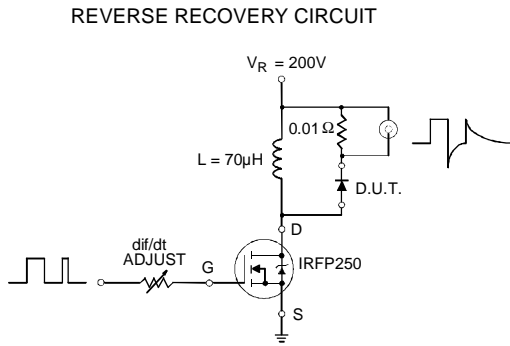
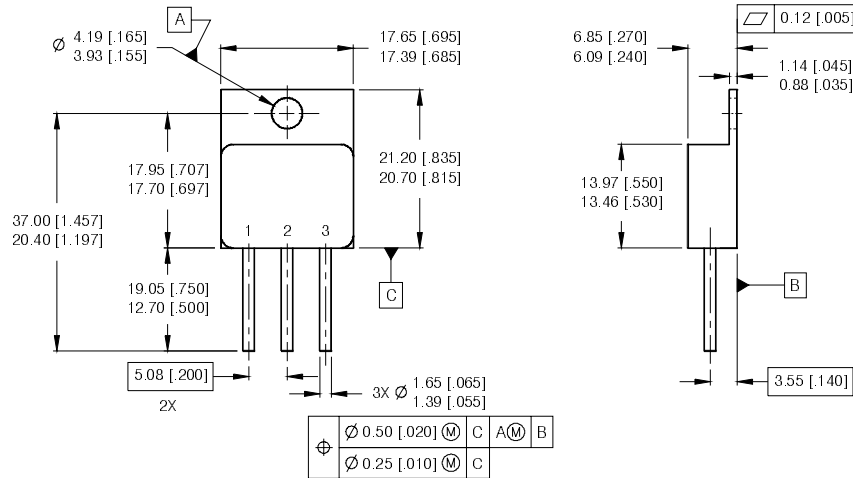

Fig. 9 - Reverse Recovery Parameter Test Circuit

Fig. 10 - Reverse Recovery Waveform and Definitions

Case Outline and Dimensions — TO-258AA



NOTES:

1. DIMENSIONING & TOLERANCING PER ASME Y14.5M-1994.
2. ALL DIMENSIONS ARE SHOWN IN MILLIMETERS [INCHES].
3. CONTROLLING DIMENSION: INCH.
4. CONFORMS TO JEDEC OUTLINE TO-258AA.

PIN ASSIGNMENTS

- 1 = ANODE 1
- 2 = COMMON CATHODE
- 3 = ANODE 2