



CABLE 234 RF: RP SMA STRAIGHT PLUG + RP SMA STRAIGHT BULKHEAD JACK W/O-RING RATED TO IP67/68 + MULTIPLE CABLE SIZES

SPECIFICATIONS :

1. RP SMA STRAIGHT PLUG, P/N:
 FOR RG178 CABLE: RFCT-SMA017-M78.
 FOR $\phi 1.13\text{MM}$ CABLE: RFCT-SMA042-M13.
2. COAXIAL CABLE, SEE P/N FOR DETAIL.
3. RP SMA STRAIGHT BULKHEAD JACK W/O-RING RATED TO IP67/68,
 P/N: RFCT-SMA008-F78.

USAGE PRECAUTIONS: CABLES USING 'MICRO' COAX ARE DELICATE:
 (i) HANDLE WITH CARE.
 (ii) DO NOT TWIST; APPLY EXCESSIVE FORCES OR SHARP BENDS TO THE CABLE. DO NOT FORCEFULLY DEFORM WIRES.
 (iii) CONSULT CONNECTOR MANUFACTURER'S DATASHEETS FOR DETAILED NOTES ON HANDLING INSTRUCTIONS.

ENVIRONMENTAL:

- A. BULKHEAD MOUNTED CONNECTOR (RFCT-SMA008-F78) TESTED TO THE FOLLOWING SPECIFICATION:
- i. IP6X - DUST TIGHT - NO PARTICLE INGRESS.
 - ii. IPX7 WATERPROOF FOR 30 MINUTES UP TO 1 METER UNDERWATER.
 - iii. IPX8 WATERPROOF FOR 48 HOURS AT 1 METER UNDERWATER.
 - iv. IPX8 WATERPROOF FOR 12 HOURS AT 5 METERS UNDERWATER.
 - v. PRESSURE TEST - 1 BAR FOR 10 SECONDS.

NOTES:

1. WORKING FREQUENCY RANGE: DC-3GHz.
2. OPERATING TEMPERATURE: $-55^{\circ}\text{C} \sim +125^{\circ}\text{C}$.

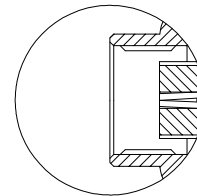
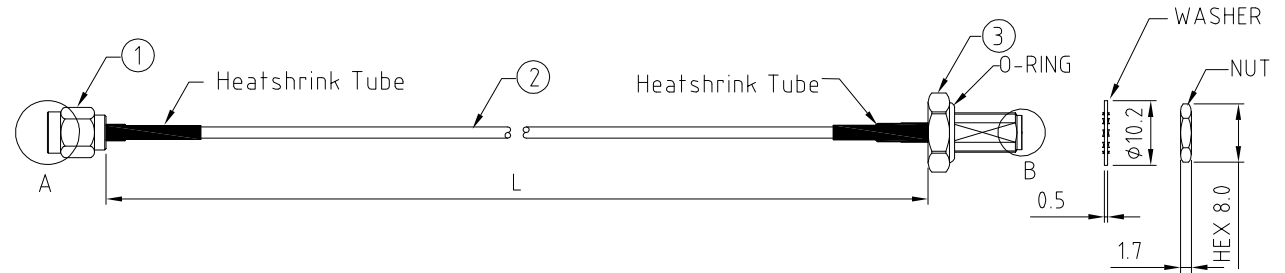

DETAIL A

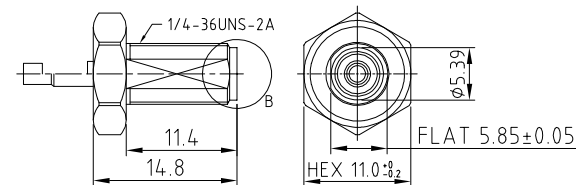

SMA JACK DETAIL DRAWING

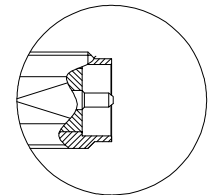

DETAIL B

HOW TO ORDER
 CABLE 234 RF - X X X X - X - X

"L" LENGTH IN MM:
 eg: 100MM = 0100
 (MIN. 0050-MAX.2000)
 STANDARD = 0100, 0150, 0200)
 Tolerance: <50mm: $\pm 2\text{mm}$.
 51-200mm: $\pm 5\text{mm}$.
 201-500mm: $\pm 7\text{mm}$.
 >501mm: $\pm 10\text{mm}$.

CABLE SIZE OPTIONS:
 1 = RG178 CABLE, COLOR: BROWN.
 2 = $\phi 1.13\text{MM}$ CABLE, COLOR: GRAY.

WASHER AND NUT OPTIONS:
 BLANK = SEPARATELY PACKED (STANDARD)
 A = ALL ASSEMBLED WITH CONNECTOR

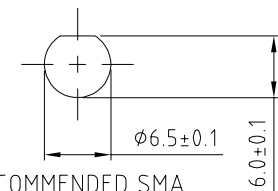

RECOMMENDED SMA MOUNTING HOLE

REV. DATE & DRN
 10 26/05/16 - R/H RELEASE
 11 20/12/17 - NYW
 12 28/11/18 - NYW
 13 27/05/19 - NYW
 ADD SMA JACK DETAIL DRAWING
 ADD OPERATING TEMP.

Scale: NTS	THIRD ANGLE	Unstated: .X .XX .XXX	Tolerances: N/A N/A N/A
Drawn: RJH		ANGLES	N/A
App'd: XXX	Title: CABLE ASSEMBLY		
Date: 27 MAY '19	Revision: 13	Unit: mm	

 IP67/68 Rated Cables	 www.gradconn.com	Type: Cable 234 RF
		CABLE 234 RF
Drawing Number:		Sheet 1 of 1
© THIS DRAWING IS CONFIDENTIAL AND MUST NOT BE COPIED OR DISCLOSED WITHOUT WRITTEN CONSENT		Drawing © E and O E