

# POWER RELAY

## 1 POLE - 6A (Medium Load Control)

### SLIM TYPE

## FTR-LY Series

RoHS Compliant

#### ■ FEATURES

- Slim(15.0mm(h) x 5.0 mm(w) x 28.0mm (l))
- Mounting space: 140mm<sup>2</sup>, weight: 5.0g
- High insulation in small package (between coil and contacts)
  - Insulation Distance: 8mm min.)
  - Dielectric strength: 4,000 VAC
  - Surge strength: 6,000V
- Plastic materials
  - UL94 flame class V-0
  - CTI>250 (UL CTI level class 2)
- UL, CSA, VDE, SEMKO under approval
  - UL: conforms to UL508, 1604
  - CSA: conforms to CSA22.2 No.14
  - SEMKO: conforms to EN61058-1, 61095
  - VDE: conforms to VDE 0435, 0631, 0700
- Contains no lead and features cadmium-free contacts
- Socket type available
- RoHS Compliant since production



#### ■ ORDERING INFORMATION

[Example]    FTR-LY    A    A    005    Y    SK  
                   (a)    (b)    (c)    (d)    (e)    (f)

(a)	Series Name	FTR-LY : FTR-LY Series			
(b)	Contact Arrangement	A	: 1 form A	P	: 1 form A (Right Angle Type)
		C	: 1 form C	R	: 1 form C (Right Angle Type)
(c)	Coil Type / Enclosure	A	: Standard / Plastic sealed		
(d)	Nominal Voltage	005	: 5 VDC,	006	: 6VDC,
		012	: 12VDC,	024	: 24VDC,
				048	: 48VDC
(e)	Contact Material	Y	: Silver alloy		
		V	: Gold plated silver alloy		
(f)	Socket Type	NIL	: PCB mounting type		
		SK	: Socket mounting type (contact arrangement A&C only)		

Actual marking does not carry the type name : "FTR" and "SK"

E.g.: Ordering code: FTR-LYAA012Y

Actual marking: LYAA012Y

# FTR-LY SERIES

## ■ SPECIFICATIONS

Item		FTR-LY		
Contact	Arrangement	1 form C	1 form A	
	Material	Gold plated silver alloy, silver alloy		
	Style	Single		
	Resistance (initial)	Maximum 100m ohms		
	Rating	6A 250VAC or 6A 30VDC		
	Maximum Carrying Current	6A		
	Maximum Switching Power	1,500VA		
	Maximum Switching Voltage	250VAC		
	Minimum Switching Load*1	10mA 5VDC		
	Maximum Switching Current	6A		
Coil	Operating Temperature	-40° C to +85° C (no frost)		
	Rating Power	170mW		
	Must operate power	75mW		
	Max. allowable voltage	150% of nominal voltage (at 20 deg.)		
Time Value	Operate Time (without diode)	Maximum 8ms (at nominal voltage, no bounce)		
	Release Time (without diode)	Maximum 4ms (at nominal voltage, no bounce)		
Insulation	Resistance (at 500VDC)	Minimum 1,000 Mohms		
	Dielectric Strength	Between open contacts	1,000 VAC 1 minute	
		Between coil and contacts	4,000 VAC 1 minute	
	Surge Strength	6,000V (at 1.2 x 50 micro sec.)		
Life	Mechanical	10 x 10 <sup>6</sup> operations minimum		
	Electrical	AC contact rating	60 x10 <sup>3</sup> ops. min. (N.O.) 30 x10 <sup>3</sup> ops. min. (N.C.) at 6A 250VAC/30VDC	
Other	Vibration Resistance	Misoperation	10 to 55 Hz, at double amplitude of 1.0mm	
		Endurance	10-55 Hz, at double amplitude of 1.5mm	
	Shock Resistance	Misoperation	Min. 50m/s <sup>2</sup> (11±1ms)	Min. 100m/s <sup>2</sup> (11±1ms)
		Endurance	Min. 1,000m/s <sup>2</sup> (6±1ms)	
	Weight	Approximately 4g		

# FTR-LY SERIES

## COIL DATA CHART

Model		Nominal Voltage	Coil Resistance (± 10%)	Must Operate Voltage	Must Release Voltage	Nominal Power
1 form A type	1 form C type					
FTR-LYAA005Y(-SK)	FTR-LYCA005Y(-SK)	5VDC	147 Ω	3.3VDC	0.25VDC	170mW
FTR-LYAA006Y(-SK)	FTR-LYCA006Y(-SK)	6VDC	212 Ω	4.0VDC	0.3VDC	170mW
FTR-LYAA012Y(-SK)	FTR-LYCA012Y(-SK)	12VDC	847 Ω	8.0VDC	0.6VDC	170mW
FTR-LYAA024Y(-SK)	FTR-LYCA024Y(-SK)	24VDC	3,388 Ω	15.9VDC	1.2VDC	170mW
FTR-LYAA048Y(-SK)	FTR-LYCA048Y(-SK)	48VDC	10,600 Ω	31.7VDC	2.4VDC	217mW
FTR-LYPA005Y	FTR-LYRA005Y	5VDC	147 Ω	3.3VDC	0.25VDC	170mW
FTR-LYPA006Y	FTR-LYRA006Y	6VDC	212 Ω	4.0VDC	0.3VDC	170mW
FTR-LYPA012Y	FTR-LYRA012Y	12VDC	847 Ω	8.0VDC	0.6VDC	170mW
FTR-LYPA024Y	FTR-LYRA024Y	24VDC	3,388 Ω	15.9VDC	1.2VDC	170mW
FTR-LYPA048Y	FTR-LYRA048Y	48VDC	10,600 Ω	31.7VDC	2.4VDC	217mW

Note: All values in the table are measured at 20°C.

## DIMENSIONS

Thru hole type

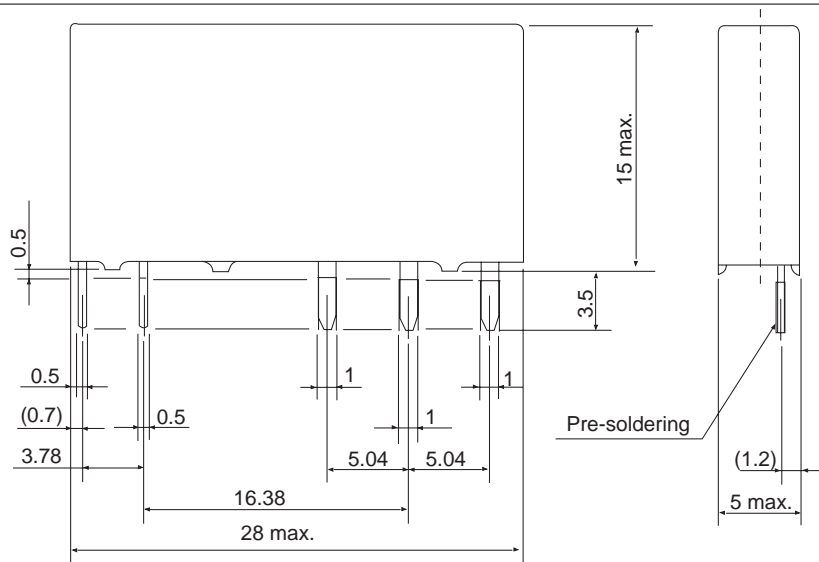

Drilling Plan (BOTTOM VIEW)

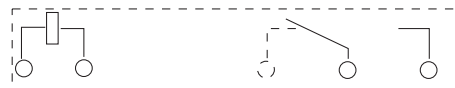

Wiring Diagram (BOTTOM VIEW)

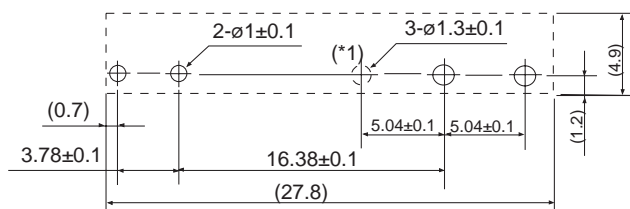

\*1: This terminal is not applicable for 1 form A type

Unit: mm

# FTR-LY SERIES

## ■ DIMENSIONS

Right Angle type

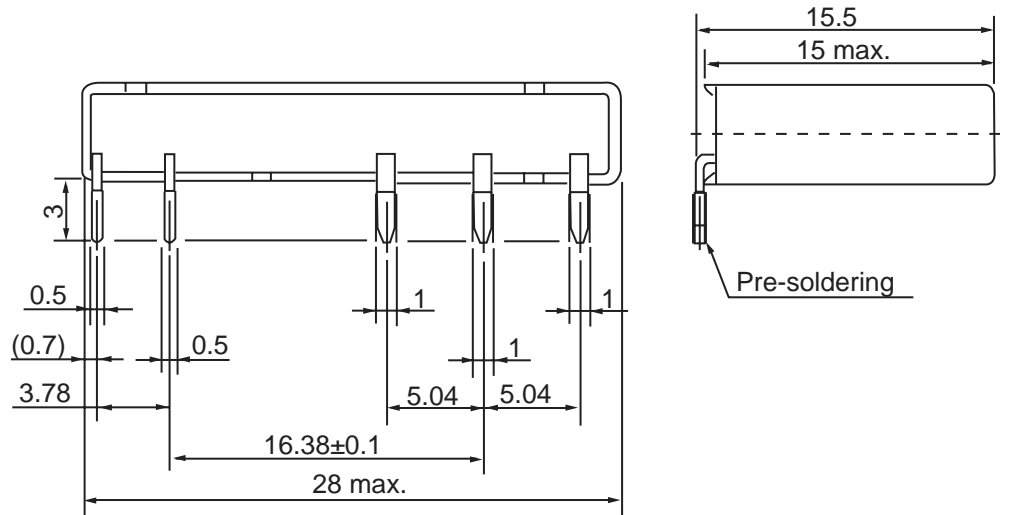

Drilling Plan  
(Bottom view)

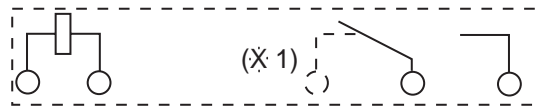

Wiring Diagram  
(Bottom view)

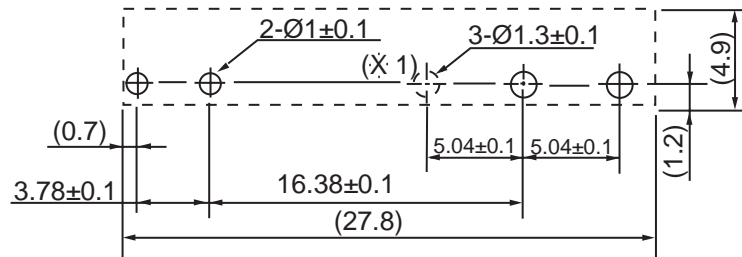

(X 1): this terminal is not applicable for 1 form A type

Unit: mm

# FTR-LY SERIES

## ■ DIMENSIONS

Socket type

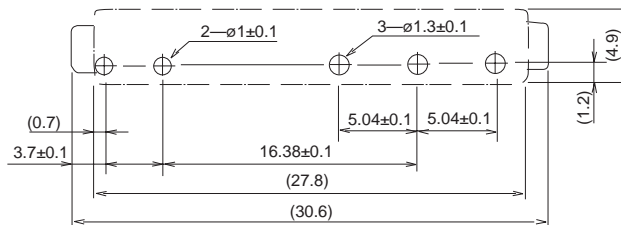
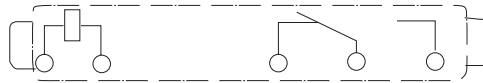
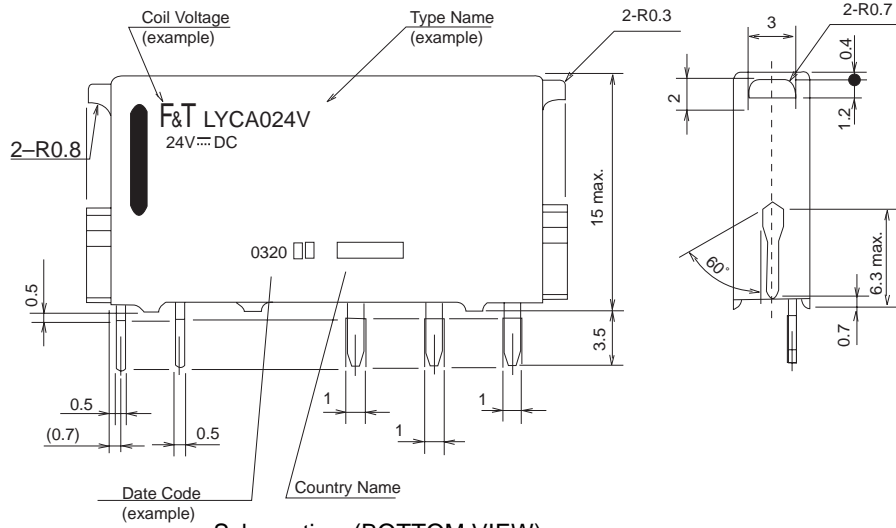

- Notes: 1. Socket ordering code  
2. Standard IC socket is not recommended. Please use JM-6S

Unit: mm

## **Fujitsu Components International Headquarter Offices**

### **Japan**

Fujitsu Component Limited  
Gotanda-Chuo Building  
3-5, Higashigotanda 2-chome, Shinagawa-ku  
Tokyo 141, Japan  
Tel: (81-3) 5449-7010  
Fax: (81-3) 5449-2626  
Email: [promothq@ft.ed.fujitsu.com](mailto:promothq@ft.ed.fujitsu.com)  
Web: [www.fcl.fujitsu.com](http://www.fcl.fujitsu.com)

### **North and South America**

Fujitsu Components America, Inc.  
250 E. Caribbean Drive  
Sunnyvale, CA 94089 U.S.A.  
Tel: (1-408) 745-4900  
Fax: (1-408) 745-4970  
Email: [marcom@fcai.fujitsu.com](mailto:marcom@fcai.fujitsu.com)  
Web: [www.fcai.fujitsu.com](http://www.fcai.fujitsu.com)

### **Europe**

Fujitsu Components Europe B.V.  
Diamantlaan 25  
2132 WV Hoofddorp  
Netherlands  
Tel: (31-23) 5560910  
Fax: (31-23) 5560950  
Email: [info@fceu.fujitsu.com](mailto:info@fceu.fujitsu.com)  
Web: [www.fceu.fujitsu.com](http://www.fceu.fujitsu.com)

### **Asia Pacific**

Fujitsu Components Asia Ltd.  
102E Pasir Panjang Road  
#04-01 Citilink Warehouse Complex  
Singapore 118529  
Tel: (65) 6375-8560  
Fax: (65) 6273-3021  
Email: [fcal@fcal.fujitsu.com](mailto:fcal@fcal.fujitsu.com)  
[www.fcal.fujitsu.com](http://www.fcal.fujitsu.com)

© 2004 Fujitsu Components America, Inc. All company and product names are trademarks or registered trademarks of their respective owners. Rev. 11/09/2004.