

Tous droits strictement réservés. Reproduction ou communication a des tiers interdite sans autorisation écrite de la Direction des ventes et du marketing. Property of FCI. Droits de reproduction FCI.

**FCI**

All rights strictly reserved. Reproduction or communication to third parties in any form without the written authorization of the sales and marketing department. Property of FCI. Copyright FCI.

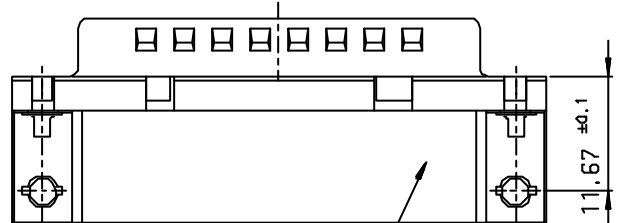
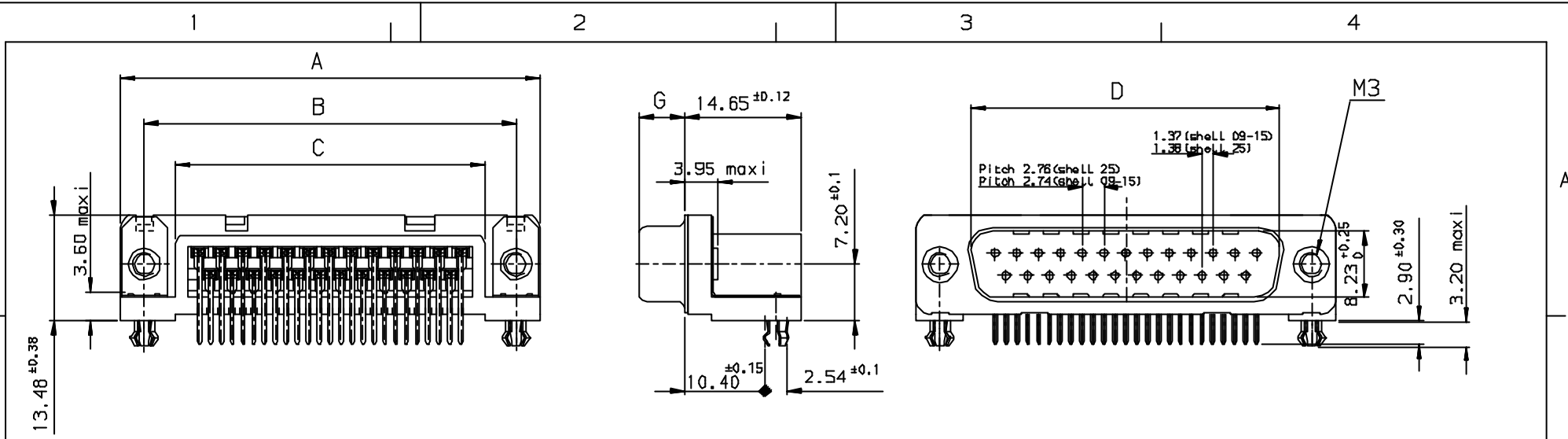

Part Number & Date Code Printing  
PC card drilling dimensions(after plating)  
(thickness 1.60±0.20mm)

Pull Parts							
SHELL	A±0.38	B±0.12	C±0.10	D±0.25	G±0.25	PART NUMBER	LEAD FREE P/N0
09	30.81	24.99	16.96	16.79	5.90	DD9P13A4GLD0	D09P13A4GLD0**
15	39.14	33.32	25.18	25.12	5.90	D15P13A4GL00	D15P13A4GL00**
25	53.03	47.04	39.12	38.84	5.70	D25P13A4GL00	D25P13A4GL00**

GENERAL CHARACTERISTICS SEE: DRAWING C01-8646-0000

LF FOR LEAD FREE

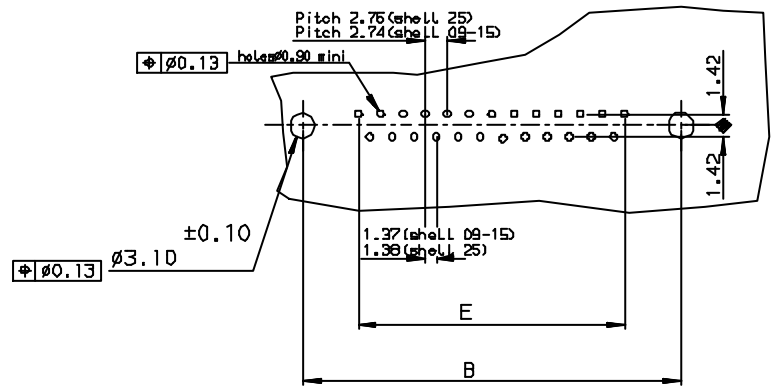

q	DATE	REVISION DESCRIPTION
1	27/7/05	LEAD FREE DETAILS ADDED

Utr	Eon no	Dr	date
g	105-0124	J5	27/7/05

Dr JOHN SLEEBA		6/01/95	Product Family	✓	Tolerance LINEAR ±0.1 ANGULAR ±1°	Projection	MM
Eng GEORGE VJ		6/01/95	Spec ref			Size	A3
Chr GEORGE VJ		27/07/05	Material			Scale	
Appr K Somasundaram		27/07/05				ECN	
<b>FCI</b>		Title MALE CONNECT.DELTA D RIGHT ANGLE WITH NUT,HARPOON & METAL PLATE.		Dwg no C01-8646-0164		Rev. 9	
Catalog no		DELTA-D		CUSTOMER COPY		Sheet 1 of 1	