

Tous droits strictement réservés. Reproduction ou communication à des tiers interdite sous quelque forme que ce soit sans autorisation écrite du propriétaire. Propriété de c FCI. Droits de reproduction FCI.

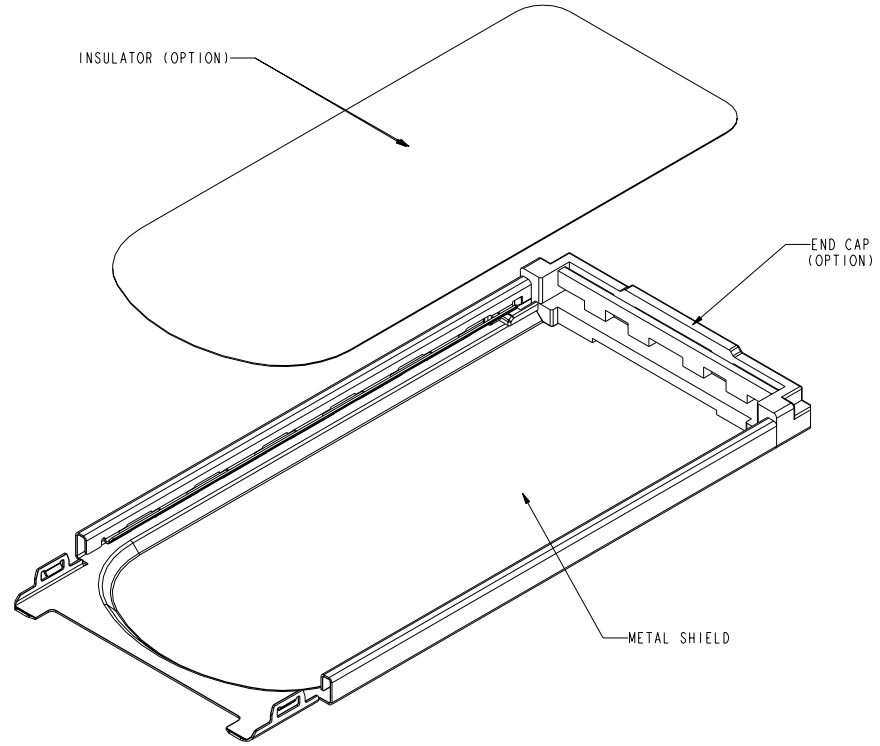

All rights strictly reserved. Reproduction or issue to third parties in any form whatever is not permitted without written authority from the proprietor. Property of FCI. Copyright FCI.

PRODUCT NO.	END CAP	INSULATOR	REMARK
10030574-2100LF	10030578-210	NO	
10030574-2101LF	10030578-210	YES	
10030574-0000LF	NO	NO	SEE NOTE 5
10030574-0001LF	NO	YES	SEE NOTE 5
10030574-0010LF	NO	NO	
10030574-0011LF	NO	YES	

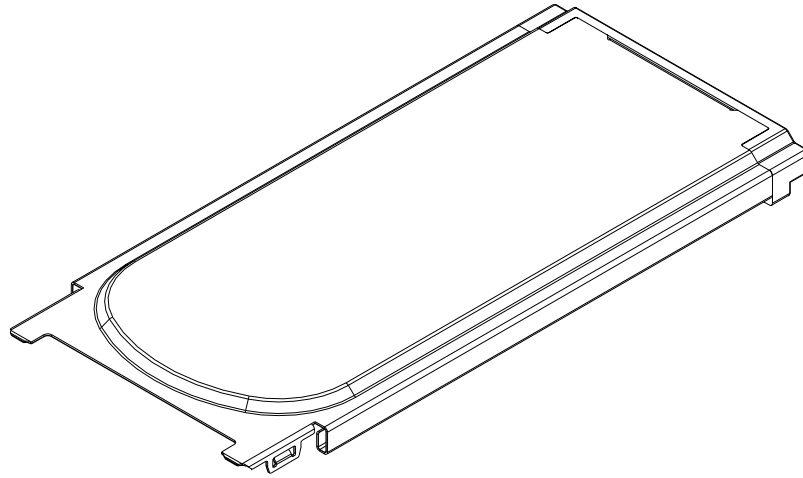

NOTES:

- THIS PRODUCT CONTAINS ONE METAL SHIELD, INSULATOR AND ONE PLASTIC END CAP.
- PRODUCT PERFORMANCE PER SPEC. GS-12-292.
- PART NUMBER SCHEME:

10030574- X X X X L F

- INSULATOR: 0:NO, 1:YES
- 0 : STANDARD SHIELD
- 1 : EXTENDED SHIELD
- PLASTIC COLOR
- 0 : W/O END CAP
- 1 : BLACK
- OFFSET (END CAP)
- 0 : W/O END CAP
- 1 : +0.00 (NOT TOOLED)
- 2 : +0.30
- 3 : +0.60 (NOT TOOLED)

- PACKAGING SPEC. PER GS-14-927.
- THE P/N IS TEMPORARY FOR CUSTOMER SPECIAL REQUEST, MATING WITH END CAP IS THE RECOMMENDED PARTS.

tolerance unless otherwise specified	
linear	.X ± .30
	.XX ± .15
	.XXX ± .08
angles	X° ± 2°

www.fciconnect.com	<input checked="" type="checkbox"/> tolerance	projection	MM
Dr DAVID TENG 10/04/04	Product family		
Eng DAVID TENG 10/04/04	Spec ref		
Chr PAUL WANG 10/04/04	Material	ECN	
Appr JOSEPH HSIA 10/04/04			
title EXPRESSCARD/34 MODULE CARD KIT BOTTOM SHIELD SUB-ASSEMBLY	dwg no 10030574	Rev. D	
catalog no	CUSTOMER DRAWING	sheet 1 of 3	

rev	ecn no	dr	date
A	T04-0382	D T	11/04/04
B	T05-0083	D T	04/18/05
C	T05-0152	D T	07/11/05
D	T05-0228	D T	10/18/05

Tous droits strictement réservés. Reproduction ou communication à des tiers interdite sous quelque forme que ce soit sans autorisation écrite du propriétaire. Propriété de c FCI. Droits de reproduction FCI.



All rights strictly reserved. Reproduction or issue to third parties in any form whatever is not permitted without written authority from the proprietor Property of FCI. Copyright FCI.

PRODUCT NO.
10030574-210XLF

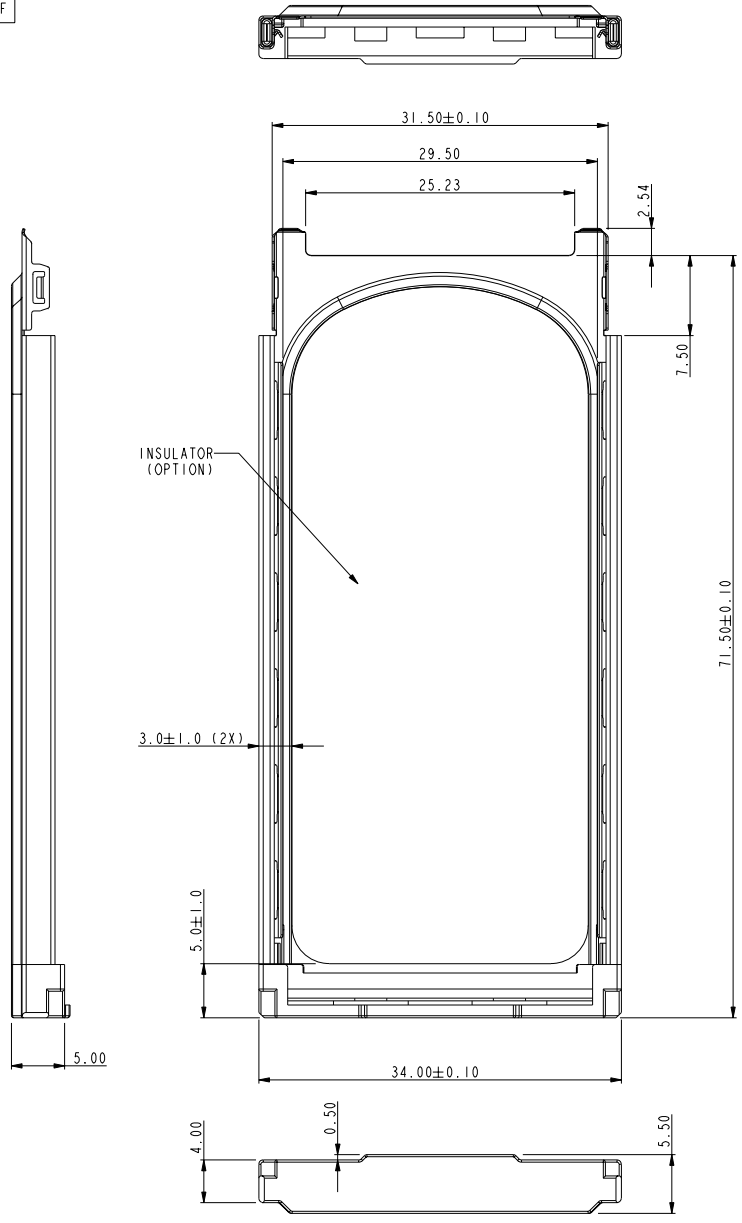

SCALE 1.500

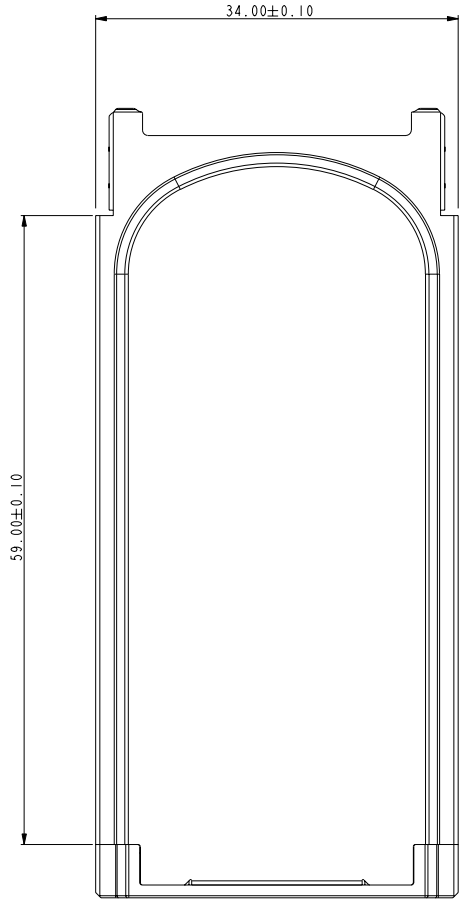
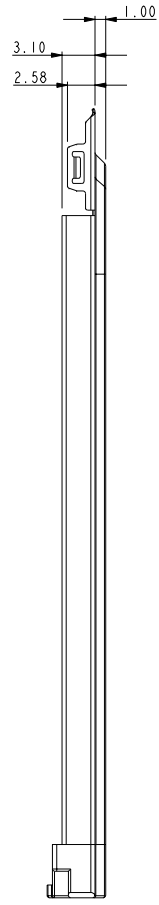

tolerance unless otherwise specified	
linear	.X ± .30 .XX ± .15 .XXX ± .08
angles	X° ± 2°

		www.fciconnect.com		tolerance <input checked="" type="checkbox"/>		projection		MM	
Dr	DAVID TENG	10/04/04	Product family		size	A4		Scale 1.000	
Eng	DAVID TENG	10/04/04	Spec ref		ECN				
Chr	PAUL WANG	10/04/04	Material						
Appr	JOSEPH HSIA	10/04/04							
title EXPRESSCARD/34 MODULE CARD KIT BOTTOM SHIELD SUB-ASSEMBLY				dwg no 10030574		Rev. D			
catalog no				CUSTOMER DRAWING		sheet 2 of 3			

PDM: Rev:D

STATUS Released

Printed: Oct 25, 2005

Tous droits strictement réservés. Reproduction ou communication à des tiers interdite sous quelque forme que ce soit sans autorisation écrite du propriétaire. Propriété de c FCI. Droits de reproduction FCI.



All rights strictly reserved. Reproduction or issue to third parties in any form whatever is not permitted without written authority from the proprietor. Property of FCI. Copyright FCI.

PRODUCT NO.
10030574-000XLF
10030574-001XLF

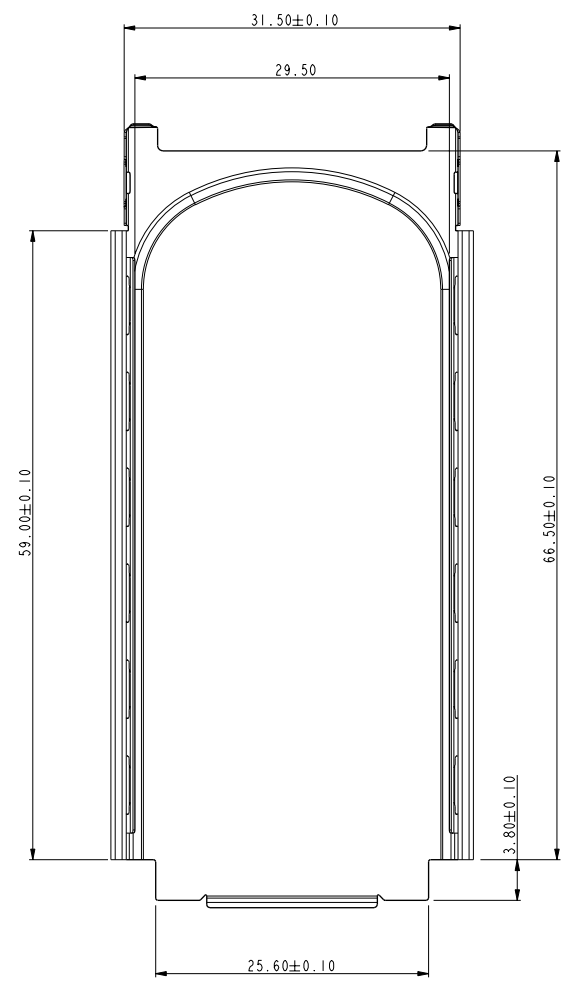

10030574-000XLF

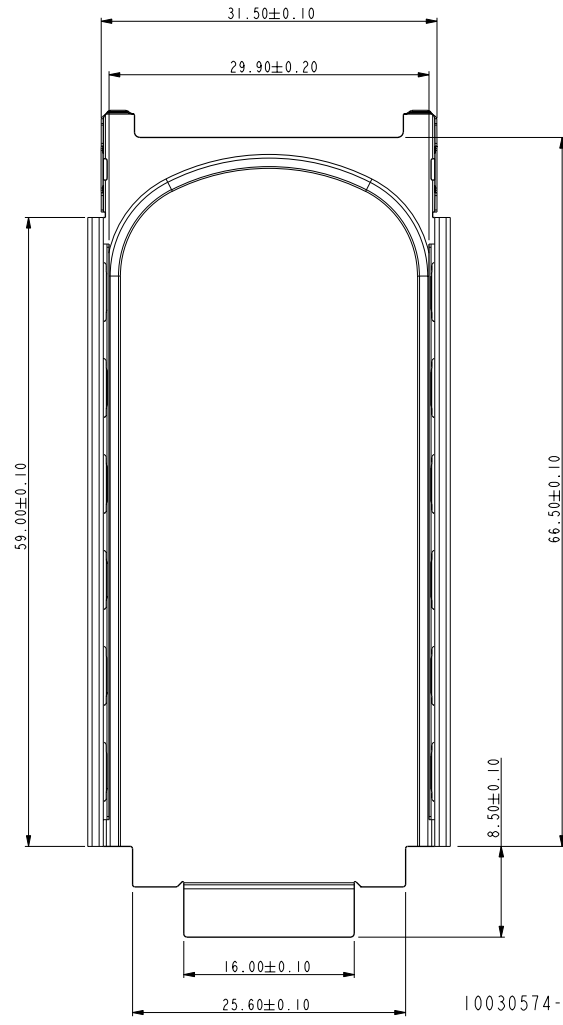

10030574-001XLF

tolerance unless otherwise specified	
linear	.X ± .30 .XX ± .15 .XXX ± .08
angles	X° ± 2°

		www.fciconnect.com		✓		tolerance		projection		
Dr	DAVID TENG	08/22/05	Product family		size		A4		Scale	
Eng	DAVID TENG	08/22/05	Spec ref		*		ECN		1.000	
Chr	PAUL WANG	08/22/05	Material		*		ECN		*	
Appr	JOSEPH HSIA	08/22/05								
title			EXPRESSCARD/34 MODULE CARD KIT BOTTOM SHIELD SUB-ASSEMBLY			dwg no		10030574		Rev.
catalog no			-			CUSTOMER DRAWING		sheet 3 of 3		D