

VERTICAL P.C.B.

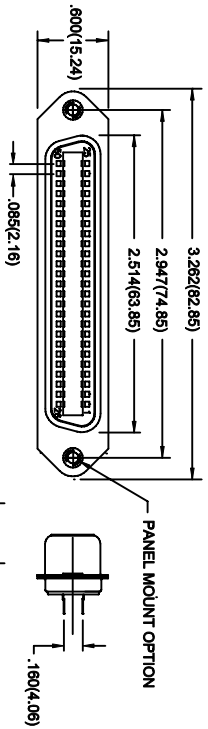

VERTICAL PRESS FIT

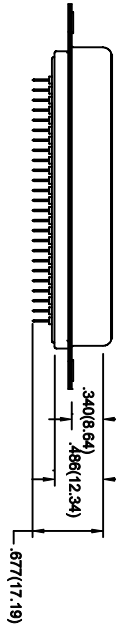

PANEL MOUNT OPTION

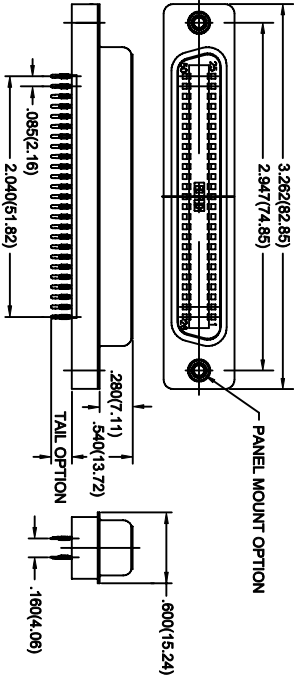

RIGHT ANGLE P.C.B.

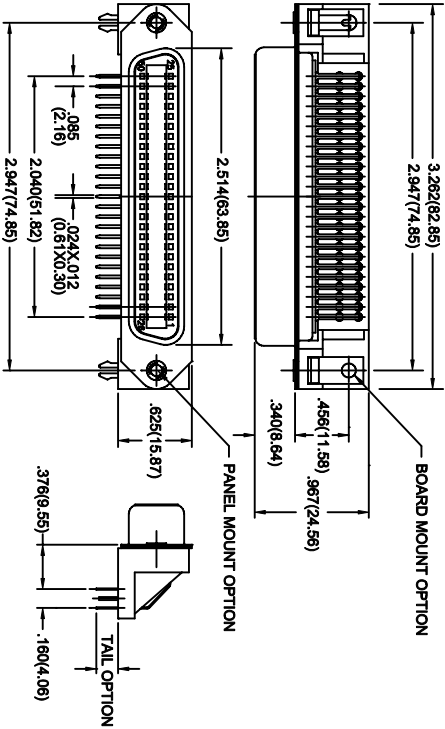

B57-150-260-202

THIS IS A C.A.D. GENERATED DRAWING
DO NOT MAKE MANUAL REVISIONS TO MASTER.

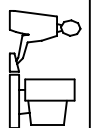

ISSUE NUMBER
ORIGINAL

1

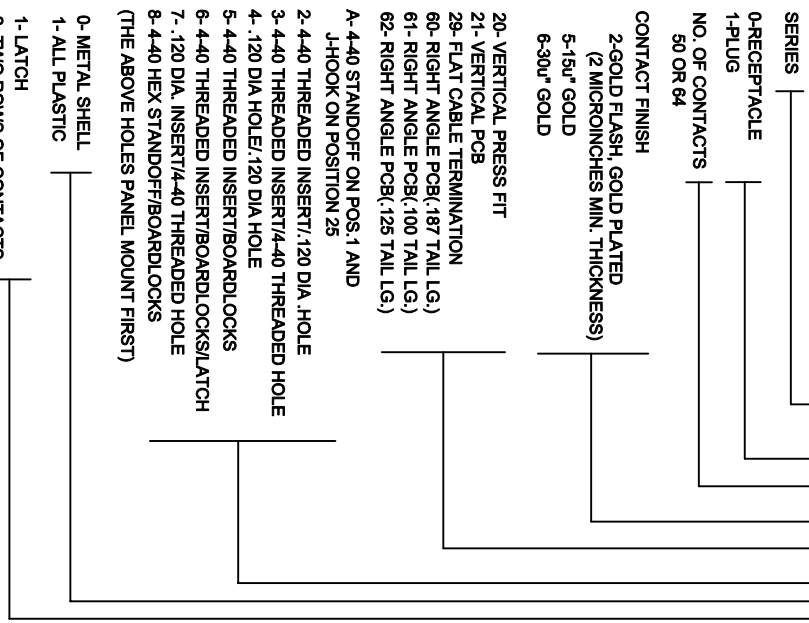

MATERIALS:
INSULATOR: GLASS-FILLED THERMOPLASTIC
UL RATED 94V-0, COLOR BLUE

CONTACT: COPPER ALLOY
PHOSPHOR BRONZE (PRESS FIT)
GOLD PLATED ON CONTACT AREA, TIN ON TAIL
OVER NICKEL

260- GOLD FLASH(2 MICRONS MIN. THICKNESS)
560- 15 MICRONS OF GOLD
660- 30 MICRONS OF GOLD

SHELL : STEEL NICKEL PLATED

ELECTRICALS:

CONTACT CURRENT RATING: 5 AC/DC AMPS CONTINUOUS
CONNECTOR IS NOT "HOT SWAPPABLE"
DIELECTRIC WITHSTANDING VOLTAGE: 1200 VAC RMS
INSULATOR RESISTANCE: 1000 mohms MIN. AT 500V DC
OPERATING VOLTAGE 250 VAC
CONTACT RESISTANCE: 30 MOHMS MAXIMUM
OPERATING TEMPERATURE: -55 C TO +105 C

RIGHT ANGLE CONNECTOR WITH J-HOOK DEVICE

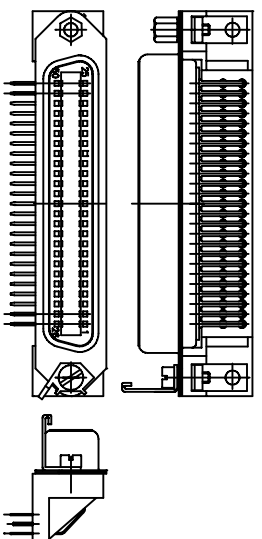

THIS SERIES FULLY CONFORMS TO THE
EUROPEAN UNION DIRECTIVES 2002/95/EC
AND 2002/96/EC FOR ROHS COMPLIANCY.

INSULATOR STANDARD COLOR BLUE
BLACK COLOR INSULATOR WILL BE -9XX ON THE LAST
THREE DIGIT ON THE PART NUMBER

**50 POSITIONS MINIATURE RIBBON CONNECTOR
GENERIC DWG.**

EDAC INC
TORONTO, ONTARIO
CANADA
YOUR CONNECTION TO QUALITY & SERVICE

THESE DRAWINGS AND SPECIFICATIONS
ARE THE PROPERTY OF EDAC INC. AND
SHALL NOT BE REPRODUCED, OR COPIED
OR USED AS THE BASIS FOR THE
MANUFACTURE OR SALE OF APPARATUS
WITHOUT WRITTEN PERMISSION.

ACAD REFERENCE NO.	B57 GENERIC DWG.
DRAWN: F.BRIONES	DATE: JUN.28/05
PART NUMBER	SEE ABOVE

DRAWING NUMBER	B57 GENERIC DWG.
ISSUE	1