

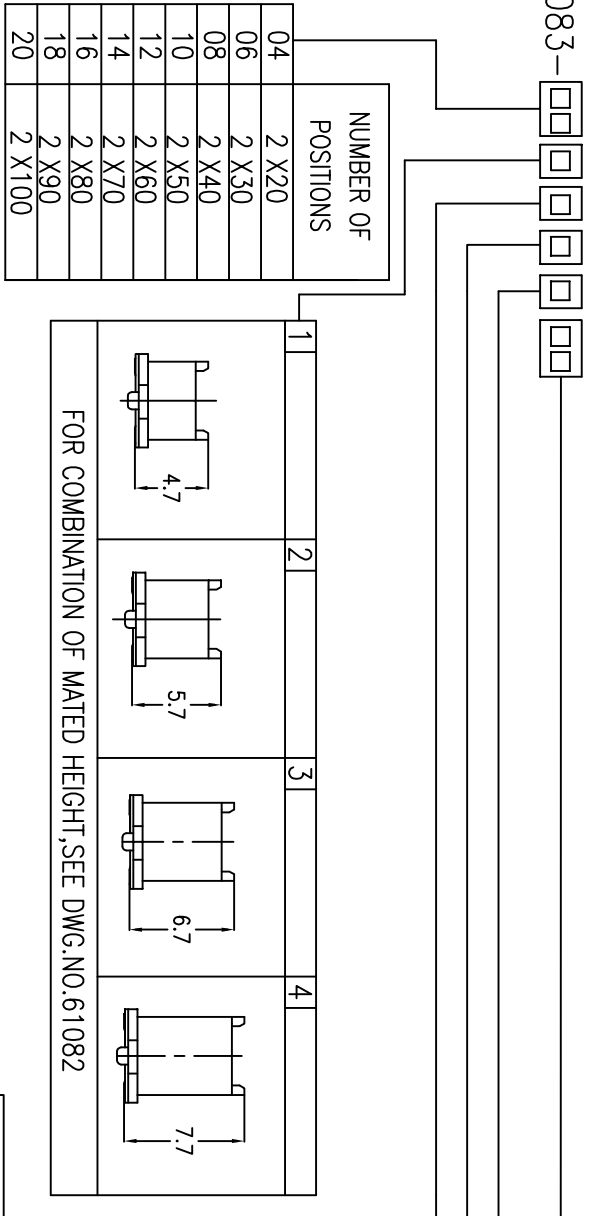

61083-



| PACKAGING | |
|-----------|--|
| 0 | TUBE WITHOUT CAP |
| 2 | TAPE & REEL WITH CAP |
| 9 | TUBE WITH CAP |
| 3 | TRAY WITH CAP |
| 6 | TAPE & REEL WITHOUT CAP (WITH KAPTON TAPE) |

| POLARIZATION PEG | | HOLD DOWN | |
|------------------|-----|-----------|--------------|
| 0 | YES | | NO |
| 2 | YES | | NO |
| 4 | NO | | YES(note 6.) |

NOTES:
1. MATERIAL:
HOUSING: G:F.LCP UL94V-0
TERMINAL: BRASS

2. PLATING:
AS TABLE SHOW.

3. SEE GS-12-148 FOR PRODUCT SPECIFICATION.

4. SEE GS-14-551 AND GS-14-816 FOR PACKAGING SPECIFICATION.

5. PACKING OPTION 3: "CUSTOMER-SPECIFIC; LIMITED TO CERTAIN SIZES"
PACKING OPTION 2: NOT ALL SIZES AVAILABLE; CHECK WITH FACTORY"

6. ONLY PLUG 1: 80 POSITIONS AVAILABLE.
PLUG 4: 120 POSITIONS AVAILABLE

7. THIS PRODUCT MEETS EUROPEAN UNION DIRECTIVES AND OTHER
COUNTRY REGULATIONS AS DESCRIBED IN GS-22-008

8. THE HOUSING WILL WITHSTAND EXPOSURE TO 260°C PEAK TEMPERATURE
FOR 10 SECONDS IN A CONVECTION, INFRA-RED OR VAPOR PHASE REFLOW
OVEN.

9. PLATING OPTION '4' IS LEADFREE ALTERNATIVE FOR OPTION '0', AND
OPTION '6' IS LEADFREE ALTERNATIVE FOR OPTION '1'.

| | PLATING ON CONTACT AREA. | |
|---|---|----------------|
| 0 | GOLD 0.2 um MIN. / TIN LEAD SOLDER | EMPTY |
| 1 | PALLADIUM-NICKEL 0.76 umMIN. WITH GOLD FLASH (0.1 um MIN.) / TIN LEAD SOLDER | EMPTY |
| 4 | GOLD 0.2 um MIN. / MATT PURE TIN ON SOLDER TAIL (LEAD FREE PLATING) | LF (note 7&9.) |
| 5 | GOLD 0.38 um / MATT PURE TIN ON SOLDER TAIL (LEAD FREE PLATING) | LF (note 7.) |
| 6 | PALLADIUM-NICKEL 0.76 umMIN. WITH GOLD FLASH (0.1 um MIN.) / MATT PURE TIN ON SOLDER TAIL (LEAD FREE PLATING) | LF (note 7&9.) |

| mat'l. code | surface | tolerance | projection | product family |
|-------------|---|--------------------------------------|------------|----------------|
| 0 | GOLD 0.2 um MIN. / TIN LEAD SOLDER | tolerance unless otherwise specified | MM | BERGSTAK |
| 1 | PALLADIUM-NICKEL 0.76 umMIN. WITH GOLD FLASH (0.1 um MIN.) / TIN LEAD SOLDER | | | |
| 4 | GOLD 0.2 um MIN. / MATT PURE TIN ON SOLDER TAIL (LEAD FREE PLATING) | | | |
| 5 | GOLD 0.38 um / MATT PURE TIN ON SOLDER TAIL (LEAD FREE PLATING) | | | |
| 6 | PALLADIUM-NICKEL 0.76 umMIN. WITH GOLD FLASH (0.1 um MIN.) / MATT PURE TIN ON SOLDER TAIL (LEAD FREE PLATING) | | | |

| lfr | ecn no | dr | date | tolerance unless otherwise specified | revision | sheet | index |
|-----|----------|----------|------------|--------------------------------------|----------|-------|-------|
| | S07-0166 | MCH | 2007-06-18 | angles | | | |
| | P | S03-171 | MW | 2004-01-30 | XXX50.15 | | |
| | R | T04-0094 | MW | 2004-03-05 | 0.4Z | | |
| | S | S04-0133 | MW | 2004-06-23 | DF | | |
| | T | S04-0167 | CH | 2004-07-30 | engr | | |
| | U | S05-0098 | CH | 2005-03-31 | CH | | |
| | V | S05-0288 | MCH | 2005-10-14 | apnd | | |

| sheet | revision | w | r | r | r | s | p |
|-------|----------|---|---|---|---|---|---|
| 1 | | | | | | | |
| 2 | | | | | | | |
| 3 | | | | | | | |
| 4 | | | | | | | |
| 5 | | | | | | | |
| 6 | | | | | | | |
| 7 | | | | | | | |

| PRODUCT NO. | NUMBER OF POSITIONS | DIMENSION | | |
|--------------|---------------------|-----------|------|------|
| | | A | B | C |
| 61083-041*** | 2 X20 | 15.2 | 21.8 | 20.2 |
| 61083-061*** | 2 X30 | 23.2 | 29.8 | 28.2 |
| 61083-081*** | 2 X40 | 31.2 | 37.8 | 36.2 |
| 61083-101*** | 2 X50 | 39.2 | 45.8 | 44.2 |
| 61083-121*** | 2 X60 | 47.2 | 53.8 | 52.2 |
| 61083-141*** | 2 X70 | 55.2 | 61.8 | 60.2 |
| 61083-161*** | 2 X80 | 63.2 | 69.8 | 68.2 |
| 61083-181*** | 2 X90 | 71.2 | 77.8 | 76.2 |
| 61083-201*** | 2 X100 | 79.2 | 85.8 | 84.2 |

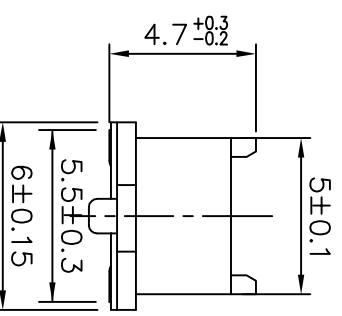
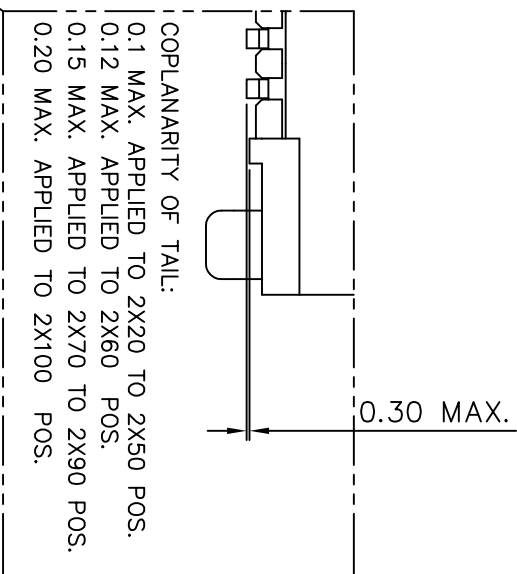
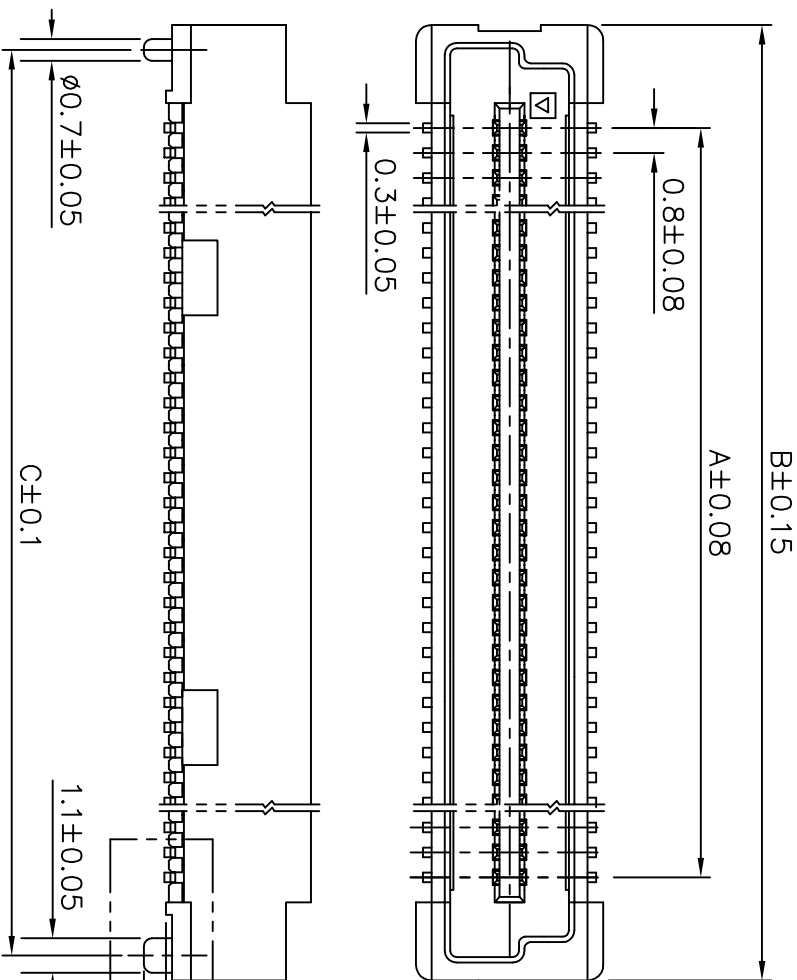

PLUG 1

| mat'l. code | | surface | | tolerance | | projection | | product family | |
|-------------|------------|------------|------------|---------------------------------------|----------|------------|-------|---------------------------------|----------------|
| lfr | ecr no | dr | date | tolerances unless otherwise specified | angles | projection | scale | title | product family |
| R | S07-0166 | MCH | 2007-05-18 | .X±0.20 | .XX±0.15 | MM | 4:1 | 0.8mm BOARD TO BOARD PLUG ASS'Y | BERGSTAK |
| engr | YU_WEN_OHU | 1999-03-28 | | | | | | | |
| chr | M.CHENONG | 2007-05-18 | | | | | | | |
| appd | JOEY_NG | 2007-05-18 | | | | | | | |

| sheet | revision | index | sheet |
|-------|----------|-------|-------|
| | | | |

| PRODUCT NO. | NUMBER OF POSITIONS | DIMENSION | | |
|--------------|---------------------|-----------|------|------|
| | | A | B | C |
| 61083-042*** | 2 X20 | 15.2 | 21.8 | 20.2 |
| 61083-062*** | 2 X30 | 23.2 | 29.8 | 28.2 |
| 61083-082*** | 2 X40 | 31.2 | 37.8 | 36.2 |
| 61083-102*** | 2 X50 | 39.2 | 45.8 | 44.2 |
| 61083-122*** | 2 X60 | 47.2 | 53.8 | 52.2 |
| 61083-142*** | 2 X70 | 55.2 | 61.8 | 60.2 |
| 61083-162*** | 2 X80 | 63.2 | 69.8 | 68.2 |
| 61083-182*** | 2 X90 | 71.2 | 77.8 | 76.2 |
| 61083-202*** | 2 X100 | 79.2 | 85.8 | 84.2 |

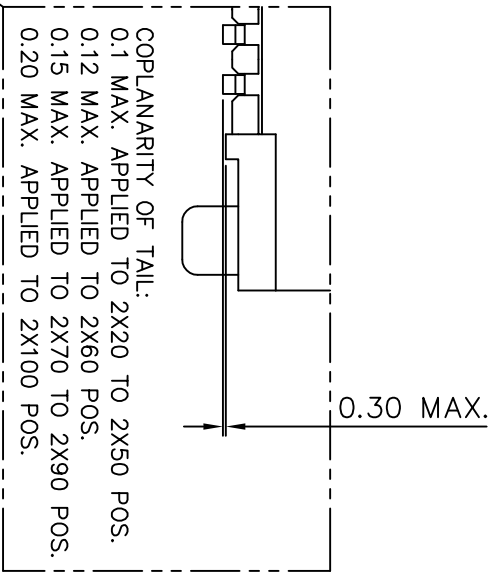
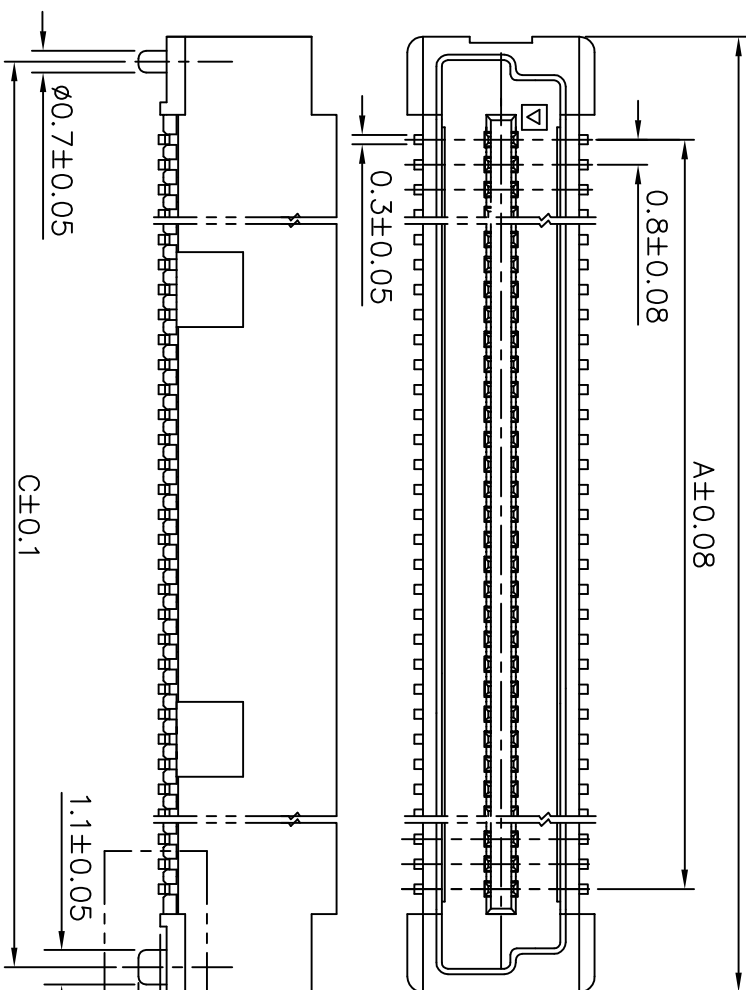

PLUG 2

| | | | | | | | | | |
|-------------|-----------|------------|------------|---------------------------------------|------------|------------------|--|----------------------|--|
| mat'l. code | | surface | | tolerance | | projection | | product family | |
| litr | ecn no | dr | date | tolerances unless otherwise specified | | MM | | BERGSTAK | |
| P | S07-0166 | MCH | 2007-05-18 | angles | .X±0.20 | MM | | 0.8mm BOARD TO BOARD | |
| R | S07-0166 | MCH | 2007-05-18 | 0°±2' | .XXX±0.15 | Scale 4:1 | | PLUG ASS'Y | |
| df | MAGGIE_WU | 1999-03-28 | engr | YU_WEN_CHU | 1999-03-28 | sheet 3 of 7 | | size | |
| chr | M.CHENONG | 2007-05-18 | appr | JOEY_NG | 2007-05-18 | A4 | | type | |
| sheet index | revision | sheet | sheet | | | CUSTOMER Drawing | | | |

| PRODUCT NO. | NUMBER OF POSITIONS | DIMENSION | | |
|--------------|---------------------|-----------|------|------|
| | | A | B | C |
| 61083-043*** | 2 X20 | 15.2 | 21.8 | 20.2 |
| 61083-063*** | 2 X30 | 23.2 | 29.8 | 28.2 |
| 61083-083*** | 2 X40 | 31.2 | 37.8 | 36.2 |
| 61083-103*** | 2 X50 | 39.2 | 45.8 | 44.2 |
| 61083-123*** | 2 X60 | 47.2 | 53.8 | 52.2 |
| 61083-143*** | 2 X70 | 55.2 | 61.8 | 60.2 |
| 61083-163*** | 2 X80 | 63.2 | 69.8 | 68.2 |
| 61083-183*** | 2 X90 | 71.2 | 77.8 | 76.2 |
| 61083-203*** | 2 X100 | 79.2 | 85.8 | 84.2 |

B±0.15

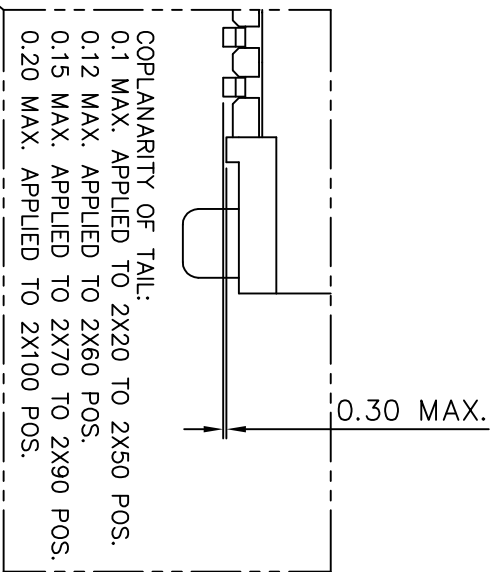
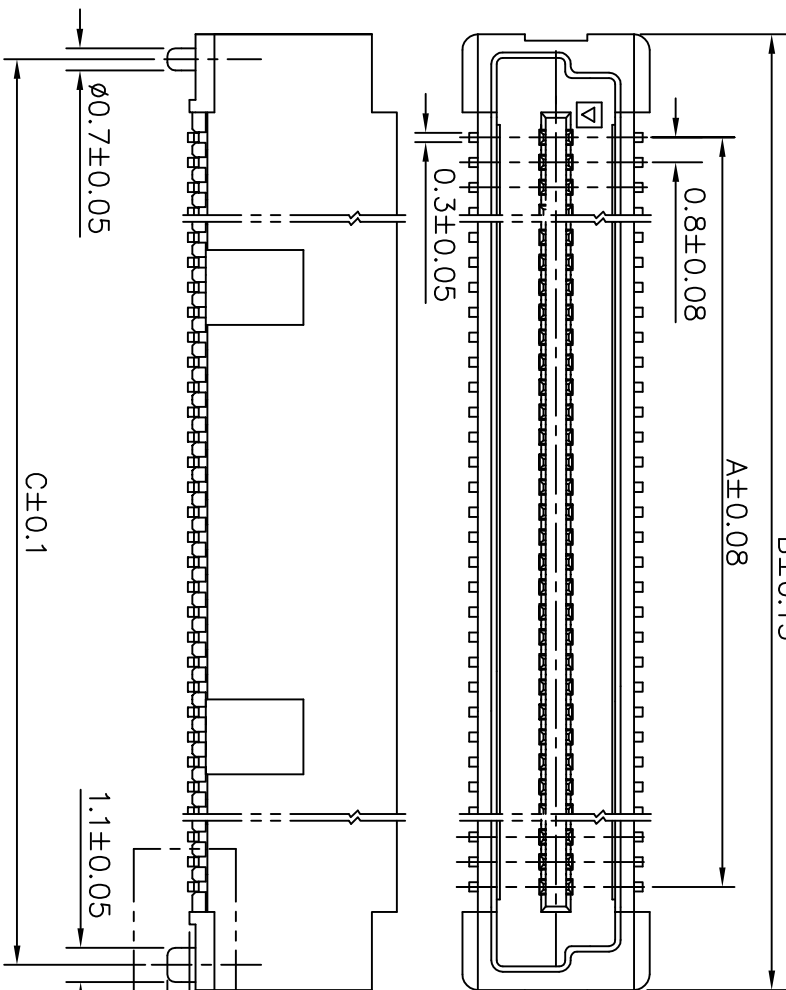

COPLANARITY OF TAIL:
 0.1 MAX. APPLIED TO 2X20 TO 2X50 POS.
 0.12 MAX. APPLIED TO 2X60 POS.
 0.15 MAX. APPLIED TO 2X70 TO 2X90 POS.
 0.20 MAX. APPLIED TO 2X100 POS.

PLUG 3

| | | | | | | | | | |
|-------------|----------|---------|------------|---------------------------------------|------------|------------|----|----------------------|--|
| mat'l. code | | surface | | tolerance | | projection | | product family | |
| litr | ecr no | dr | date | tolerances unless otherwise specified | MM | MM | MM | BERGSTAK | |
| P | S07-0166 | MCH | 2007-05-18 | angles | .X±0.20 | | | 0.8mm BOARD TO BOARD | |
| R | | | | ∠ | .XXX±0.15 | | | PLUG ASS'Y | |
| | | | | 0±Z | .XXX±0.10 | | | | |
| | | | | dr | MAGGIE_WU | 1999-03-26 | | sheet 4 of 7 | |
| | | | | enfr | YU_WEN_CHU | 1999-03-26 | | size | |
| | | | | chr | M.CHEONG | 2007-05-18 | | A4 | |
| | | | | apprd | JOEY_NG | 2007-05-18 | | CUSTOMER Drawing | |
| sheet | revision | | | | | | | | |
| index | sheet | | | | | | | | |

| PRODUCT NO. | NUMBER OF POSITIONS | DIMENSION | | |
|--------------|---------------------|-----------|------|------|
| | | A | B | C |
| 61083-044*** | 2 X20 | 15.2 | 21.8 | 20.2 |
| 61083-064*** | 2 X30 | 23.2 | 29.8 | 28.2 |
| 61083-084*** | 2 X40 | 31.2 | 37.8 | 36.2 |
| 61083-104*** | 2 X50 | 39.2 | 45.8 | 44.2 |
| 61083-124*** | 2 X60 | 47.2 | 53.8 | 52.2 |
| 61083-144*** | 2 X70 | 55.2 | 61.8 | 60.2 |
| 61083-164*** | 2 X80 | 63.2 | 69.8 | 68.2 |
| 61083-184*** | 2 X90 | 71.2 | 77.8 | 76.2 |
| 61083-204*** | 2 X100 | 79.2 | 85.8 | 84.2 |

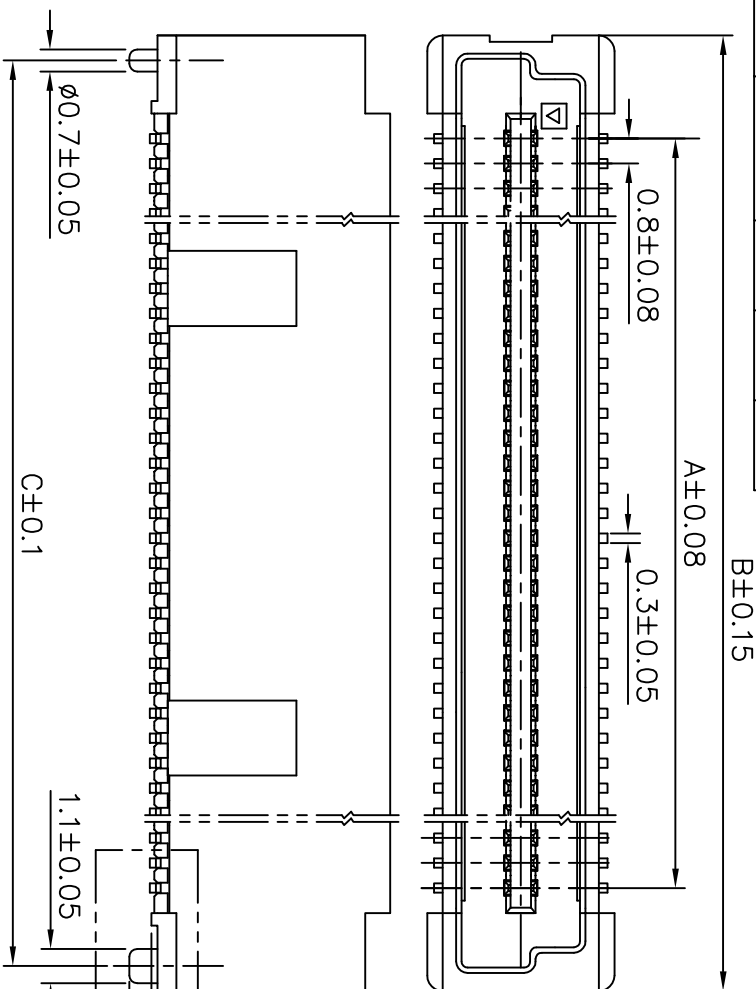

COPLANARITY OF TAIL:
 0.1 MAX. APPLIED TO 2X20 TO 2X50 POS.
 0.12 MAX. APPLIED TO 2X60 POS.
 0.15 MAX. APPLIED TO 2X70 TO 2X90 POS.
 0.20 MAX. APPLIED TO 2X100 POS.

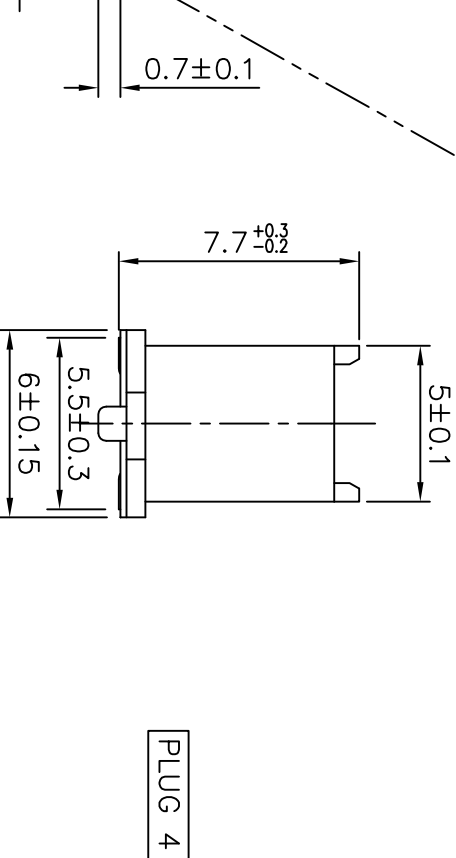

PLUG 4

| mat'l. code | | surface | | tolerance | | projection | | product family | |
|-------------|----------|---------|------------|---------------------------------------|------------|------------|-------|---------------------------------|----------------|
| lfr | ecr no | dr | date | tolerances unless otherwise specified | angles | projection | scale | title | product family |
| P | S07-0166 | MCH | 2007-05-18 | .X±0.20 | 0°±2° | MM | 4:1 | 0.8mm BOARD TO BOARD PLUG ASS'Y | BERGSTAK |
| R | | | | .XXX±0.15 | | | | | |
| | | | | .XXX±0.10 | | | | | |
| | | | | dr | MACGIE_WU | 1999-03-28 | | | |
| | | | | enfr | YU_WEN_OHU | 1999-03-28 | | | |
| | | | | chr | M.CHENONG | 2007-05-18 | | | |
| | | | | apnd | JOEY_NG | 2007-05-18 | | | |
| sheet | revision | | | | | | | | |
| index | sheet | | | | | | | | |

dwg no 61083
 sheet 5 of 7
 size A4
 type CUSTOMER Drawing

| PRODUCT NUMBER | POSITIONS | DIMENSION | | | |
|----------------|-----------|-----------|------|------|-------|
| | | "A" | "E" | "F" | "K" |
| 61083-081*** | 2 X40 | 31.2 | 37.8 | 36.2 | 41.7 |
| | | | | | 39.23 |

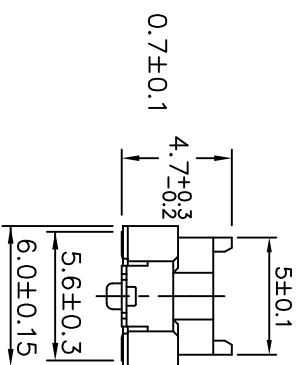
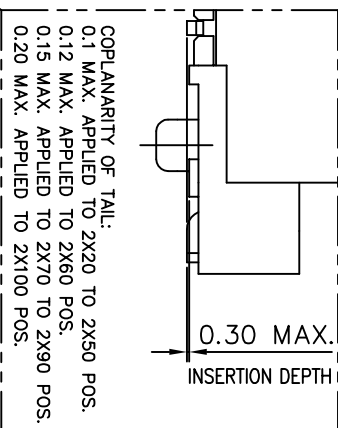
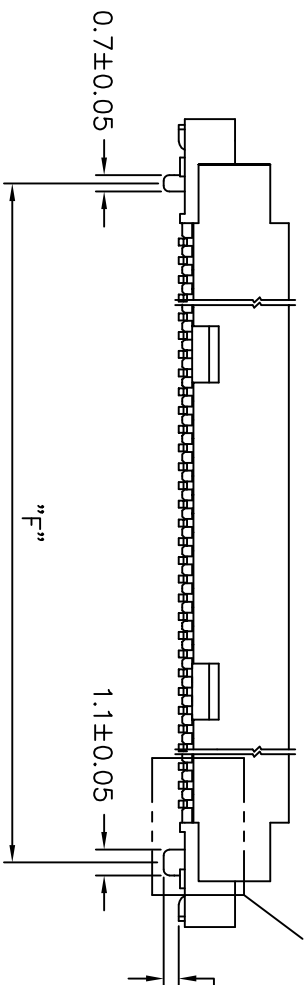
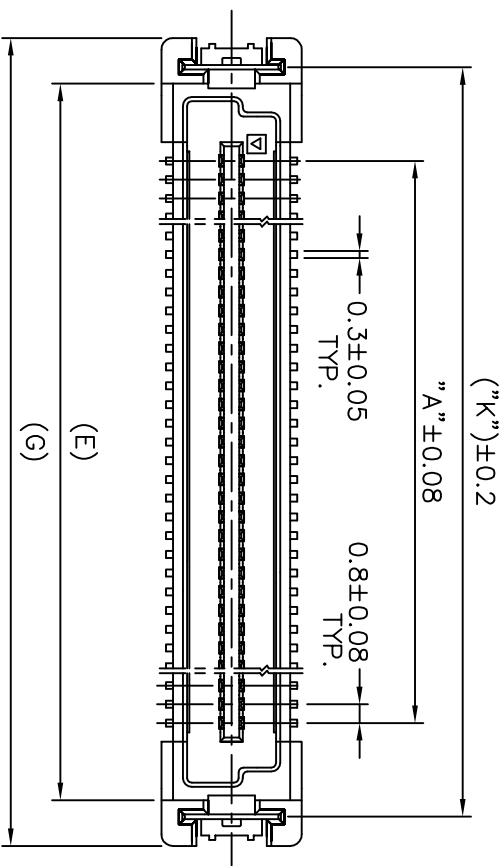

PLUG 1
FOR HOLD DOWN

| mat'l. code | | surface | | tolerance | | projection | | product family | |
|-------------|----------|---------|------------|---------------------------------------|----------|------------|------------|------------------------------------|----------------|
| ltr | ecr no | dr | date | tolerances unless otherwise specified | angles | projection | scale | title | product family |
| R | S07-0166 | MCH | 2007-05-18 | | XX±0.15 | MM | 3:1 | 0.8mm BOARD TO BOARD PLUG ASS'Y | BERGSTAK |
| S | | | | | 0±Z | | | | |
| | | | | | XXX±0.10 | | | | |
| | | | | | dr | MAGGIE_WU | 1999-03-28 | | |
| | | | | | enr | YU_WEN_CHU | 1999-03-28 | | |
| | | | | | chr | M.CHENONG | 2007-05-18 | | |
| | | | | | apnd | JOEY_NG | 2007-05-18 | | |
| sheet index | revision | | | | | | | | |

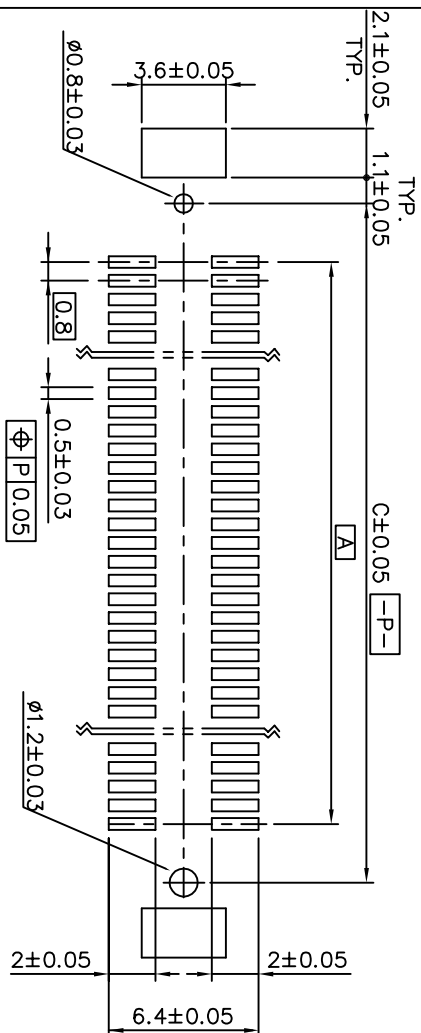

RECOMMENDED PCB LAYOUT WITH PEG AND HOLDDOWN
FOR NO. OF POS. 2X20, 2X30, 2X40, 2X60

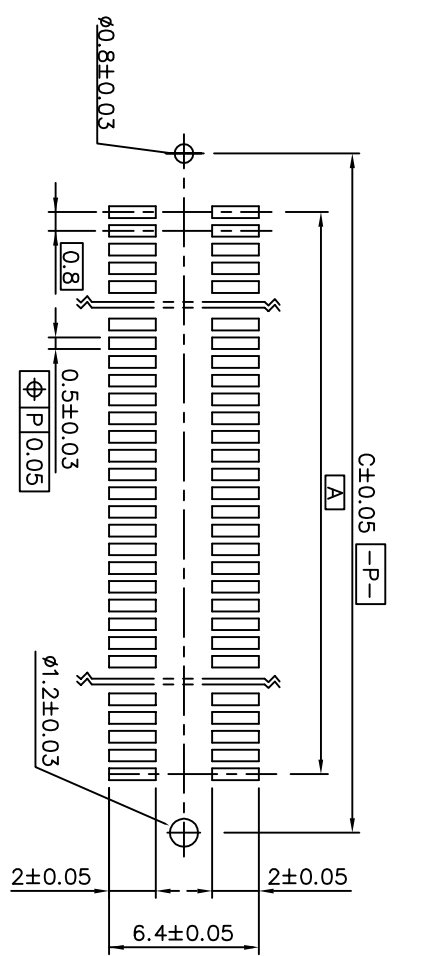

RECOMMENDED PCB LAYOUT WITH PEG
FOR NO. OF POS. 2X20, 2X30, 2X40, 2X50, 2X60

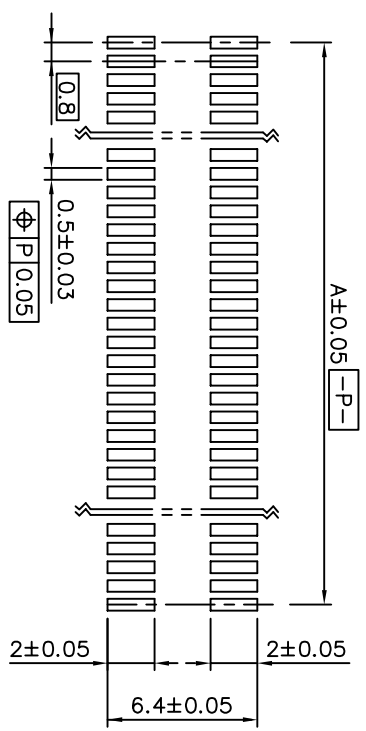

RECOMMENDED PCB LAYOUT WITHOUT PEG AND HOLDDOWN
FOR NO. OF POS. 2X20, 2X30, 2X40, 2X50, 2X60

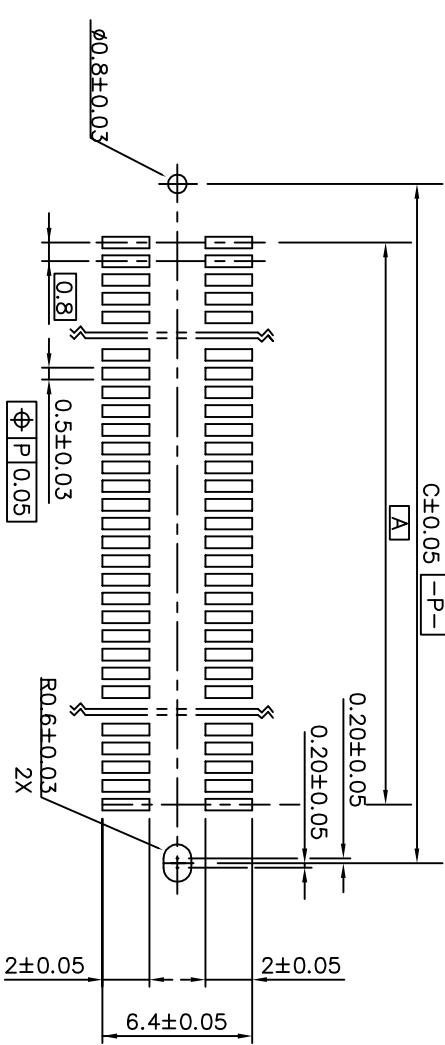

RECOMMENDED PCB LAYOUT WITH PEG
FOR NO. OF POS. 2X70, 2X80, 2X90, 2X100

FOR PLUG 1/2/3/4

| | | | | | | | | | |
|-------------|----------|---------|------------|---------------------------------------|------------|------------|--|----------------------|--|
| mat'l. code | | surface | | tolerance | | projection | | product family | |
| ltr | ecn no | dr | date | tolerances unless otherwise specified | | MM | | BERGSTAK | |
| N | | | | angles | X±0.20 | | | 0.8mm BOARD TO BOARD | |
| P | S07-0166 | MCH | 2007-05-18 | | XX±0.15 | | | PLUG ASS'Y | |
| | | | | 0±Z | XXX±0.10 | Scale 3:1 | | sheet 7 of 7 size | |
| | | | | dr | MAGGIE_WU | 1999-03-28 | | 61083 | |
| | | | | engr | YU_WEN_OHU | 1999-03-28 | | CUSTOMER Drawing | |
| | | | | chr | M.CHENONG | 2007-05-18 | | A4 | |
| | | | | appd | JOEY_NG | 2007-05-18 | | | |
| sheet | revision | | | | | | | | |
| index | sheet | | | | | | | | |