

HIGH TEMPERATURE CERAMIC EUROBLOCKS™

Suitable for use in high temperature applications up to 600°C (1112°F). Applications include hot melt glue guns, furnaces, heaters, process equipment and machinery. Terminal blocks are offered with mounting holes for panel mounting or free floating applications.

- Compact, space saving
- Tubular screw clamp
- Free float or panel mount
- Temperature range: 600°C (1112°F)
- Standard color: white
- Material
 - Housing: ceramic
 - Clamp: brass
 - Screws: zinc plated steel

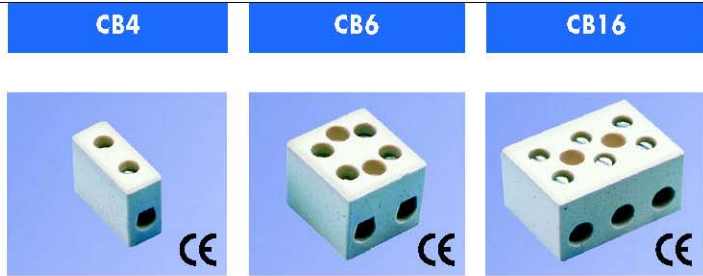

	CB4	CB6	CB16			
Insulation Material	Ceramic	Ceramic	Ceramic			
Approvals						
Wire Range	24-12 AWG	20-10 AWG	18-16 AWG			
Voltage Rating	300V	300V	300V			
Current Rating	20 A	30 A	65 A			
No. of Poles	Cat. No.	Std. Pk.	Cat. No.	Std. Pk.	Cat. No.	Std. Pk.
1 (free floating)	CB4/1	50	CB6/1	50		
2 (free floating)	CB4/2	50				
2 (with mounting holes)	CB4/2H	50	CB6/2H	50	CB16/2H	50
3 (free floating)	CB4/3	50				
3 (with mounting holes)	CB4/3H	50	CB6/3H	50	CB16/3H	50

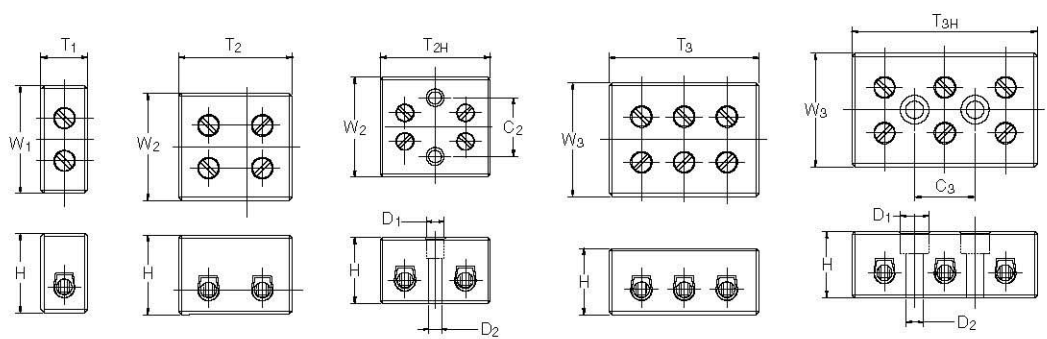

Dimensions mm

	W ₁	W ₂	W ₃	T ₁	T ₂	T _{2H}	T ₃	T _{3H}	H	D ₁	D ₂	C ₂	C ₃
CB4	25	25.5	25.4	11	18.3	25.5	25.4	36.2	18.5	6	3.5	14.5	12.8
CB6	23	23	25	12		25		41	19.5	6	3.5	12.5	14.8
CB16		28	27.5			31		47	23.2	6	3.5	16	16.5

Note: All dimensions are shown in mm, to convert to inches please divide by 25.4.